

STORM SEWER REMOVAL 12"
 STA. 195+12.0 TO 195+13.6 - 62' (TBF=13.7 CU YD)
 STA. 195+13.6 TO 195+21.5 - 8' (TBF=4.7 CU YD)
 STA. 196+62.6 TO 196+80.5 - 18' (TBF=4.0 CU YD)
 STA. 196+80.5 TO 196+78.7 - 71' (TBF=23.2 CU YD)
 STA. 198+20.9 TO 198+42.7 - 20' (TBF=14.4 CU YD)
 STA. 198+36.0 TO 198+46.2 - 12' (TBF=9.3 CU YD)

REMOVING MANHOLES
 196+47.14, 41.0 RT
 REMOVING CATCH BASINS
 195+11.95, 31.8 LT
 195+13.57, 34.5 RT
 196+62.62, 32.1 LT
 196+80.54, 31.9 LT
 198+42.69, 32.3 LT
 198+46.17, 35.1 RT

STORM SEWER REMOVAL 18"
 STA. 193+00.0 TO 196+47.1 - 345' (TBF=337.7 CU YD)
 STA. 196+47.1 TO 198+14.8 - 166' (TBF=196.1 CU YD)

STORM SEWER REMOVAL 24"
 STA. 197+95.0 TO 198+13.9 - 20' (TBF=22.6 CU YD)

FILLING EXISTING CULVERTS
 STA. 198+17.0
 STA. 198+30.0
 STA. 198+98.0

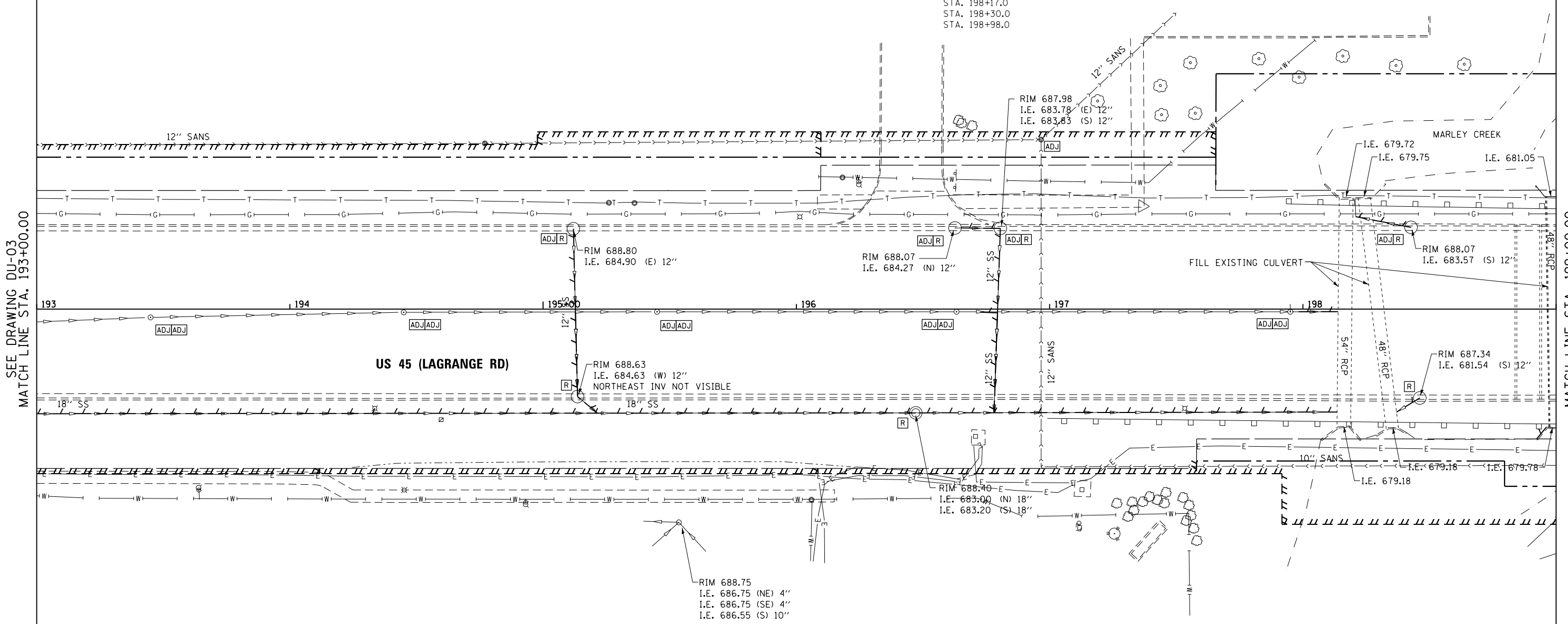

SEE DRAWING DU-03
 MATCH LINE STA. 193+00.00

MATCH LINE STA. 199+00.00
 SEE DRAWING DU-05

NOTES:
 1. SEE DRAWING DN-01 FOR DRAINAGE LEGEND AND NOTES.
 2. SEE DRAWINGS DS-01 THROUGH DS-09 FOR STRUCTURE AND PIPE INFORMATION.

100 S. WACKER DR.
 SUITE 600
 CHICAGO, IL 60606
 TEL (312) 939-1000
 FAX (312) 939-4998



FILE NAME = D160M61-SHT-DRAINEX04.dgn	USER NAME = Anthony.Plutz	DESIGNED - EJD	REVISED -
SHT.PLAN	PLOT SCALE = 40.0000' / in.	DRAWN - EJD	REVISED -
	PLOT DATE = 3/14/2013	CHECKED - JWM	REVISED -
		DATE - 03/13/2013	REVISED -

STATE OF ILLINOIS
 DEPARTMENT OF TRANSPORTATION

EXISTING DRAINAGE PLAN - US 45 (LAGRANGE ROAD)

SCALE: 1"=20' SHEET 4 OF 17 SHEETS STA. 193+00.00 TO STA. 199+00.00

F.A.P. RTE.	SECTION	COUNTY	TOTAL SHEETS	SHEET NO.
330	103R-4	COOK	877	162
DU-04			CONTRACT NO. 60M61	
ILLINOIS FED. AID PROJECT				