

STORM SEWER REMOVAL 12"		REMOVING CATCH BASINS	
STA. 206+02.4 TO 206+01.4	- 62' (TBF=11.2 CU YD)	206+02.44, 31.4	LT
STA. 206+01.4 TO 206+01.9	- 4' (TBF=0.7 CU YD)	206+01.35, 34.8	RT
STA. 207+93.4 TO 207+95.5	- 62' (TBF=11.1 CU YD)	206+01.87, 41.1	RT
STA. 207+94.4 TO 208+02.2	- 6' (TBF=1.5 CU YD)	207+93.14, 31.3	LT
STA. 209+76.0 TO 209+81.8	- 9' (TBF=9.3 CU YD)	207+95.53, 34.3	RT
STA. 209+81.8 TO 209+82.8	- 63' (TBF=10.0 CU YD)	208+02.22, 1.3	RT
		209+65.15, 1.1	RT
		209+81.78, 34.7	RT
		209+82.84, 31.8	LT

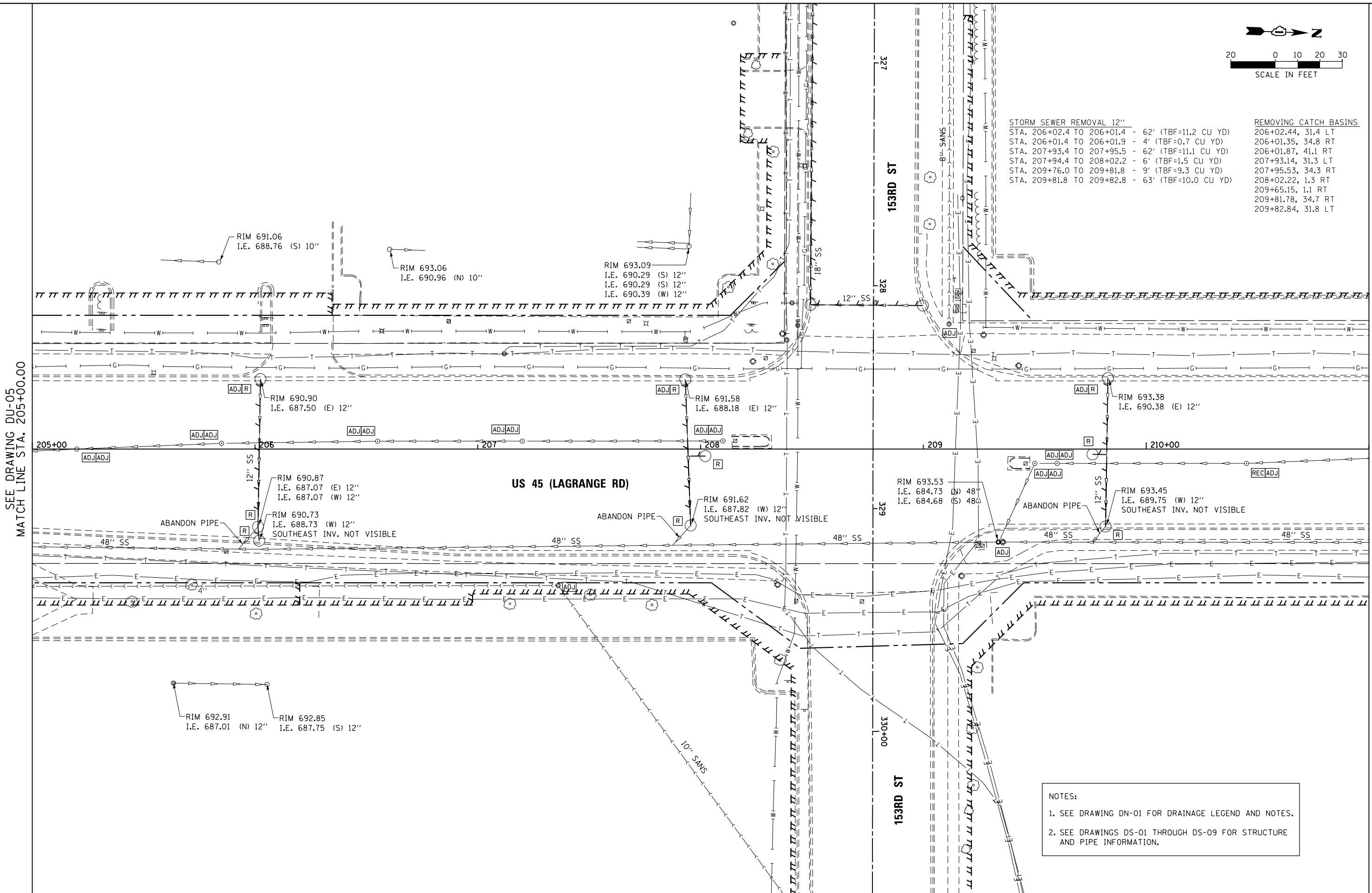

SEE DRAWING DU-05
MATCH LINE STA. 205+00.00

MATCH LINE STA. 211+00.00
SEE DRAWING DU-07

NOTES:
1. SEE DRAWING DN-01 FOR DRAINAGE LEGEND AND NOTES.
2. SEE DRAWINGS DS-01 THROUGH DS-09 FOR STRUCTURE AND PIPE INFORMATION.

URS
100 S. WACKER DR.
SUITE 600
CHICAGO, IL 60606
TEL (312) 939-1000
FAX (312) 939-4998

FILE NAME = D:\160M61-SHT-DRAINEX06.dgn	USER NAME = Anthony.Plutz	DESIGNED - EJD	REVISED -	STATE OF ILLINOIS DEPARTMENT OF TRANSPORTATION	EXISTING DRAINAGE PLAN - US 55 (LAGRANGE ROAD)			F.A.P. RTE. 330	SECTION 103R-4	COUNTY COOK	TOTAL SHEETS 877	SHEET NO. 164
PLOT SCALE = 48.0000' / in.	CHECKED - JWM	REVISED -	REVISED -		SCALE: 1"=20'	SHEET 6 OF 17 SHEETS	STA. 205+00.00 TO STA. 211+00.00	DU-06		CONTRACT NO. 60M61		
PLOT DATE = 3/14/2013	DATE - 03/13/2013	REVISED -	REVISED -		ILLINOIS FED. AID PROJECT							