

STORM SEWER REMOVAL 12"
 STA. 229+62.6 TO 229+65.0 - 74' (TBF=16.7 CU YD)
 STA. 229+64.3 TO 229+65.0 - 9' (TBF=2.0 CU YD)
 STA. 231+70.3 TO 231+81.5 - 10' (TBF=3.5 CU YD)
 STA. 231+81.5 TO 231+82.6 - 74' (TBF=12.8 CU YD)
 STA. 231+82.6 TO 231+83.3 - 24' (TBF=7.9 CU YD)

REMOVING MANHOLES
 229+64.30, 43.5 LT

REMOVING CATCH BASINS
 229+62.55, 47.3 RT
 229+64.99, 31.0 LT
 231+81.51, 47.6 RT
 231+82.63, 30.7 LT

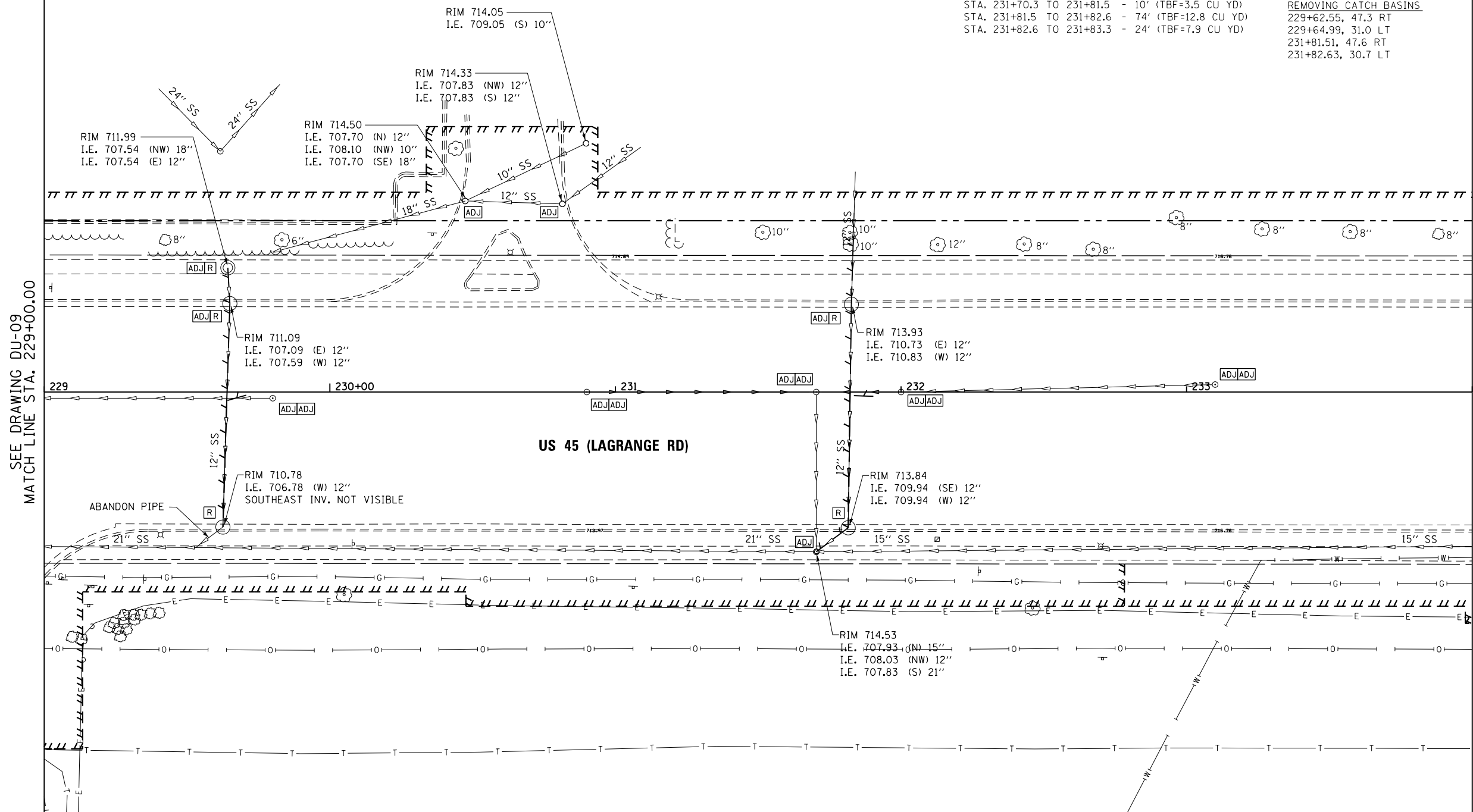

SEE DRAWING DU-09
 MATCH LINE STA. 229+00.00

MATCH LINE STA. 234+00.00
 SEE DRAWING DU-11

NOTES:
 1. SEE DRAWING DN-01 FOR DRAINAGE LEGEND AND NOTES.
 2. SEE DRAWINGS DS-01 THROUGH DS-09 FOR STRUCTURE AND PIPE INFORMATION.

URS
 100 S. WACKER DR.
 SUITE 600
 CHICAGO, IL 60606
 TEL (312) 935-1000
 FAX (312) 935-4998

FILE NAME = D160M61-SHT-DRAINEX10.dgn	USER NAME = Anthony.Plutz	DESIGNED - EJD	REVISED -	STATE OF ILLINOIS DEPARTMENT OF TRANSPORTATION	EXISTING DRAINAGE PLAN - US 45 (LAGRANGE ROAD)			F.A.P. RTE. 330	SECTION 103R-4	COUNTY COOK	TOTAL SHEETS 877	SHEET NO. 168
SHT.PLAN	PLOT SCALE = 48.0000' / in.	CHECKED - JWM	REVISED -		SCALE: 1"=20'	SHEET 10 OF 17 SHEETS	STA. 229+00.00 TO STA. 234+00.00	DU-10		CONTRACT NO. 60M61		
	PLOT DATE = 3/14/2013	DATE - 03/13/2013	REVISED -		ILLINOIS FED. AID PROJECT							