

STORM SEWER REMOVAL 12"
 STA. 261+05.6 TO 261+08.7 - 62' (TBF=20.9 CU YD)
 STA. 261+05.6 TO 261+11.6 - 4' (TBF=1.9 CU YD)
 STA. 263+50.9 TO 263+59.7 - 38' (TBF=15.8 CU YD)

REMOVING CATCH BASINS
 261+05.49, 30.0 LT
 261+08.66, 36.2 RT
 263+50.93, 1.9 RT

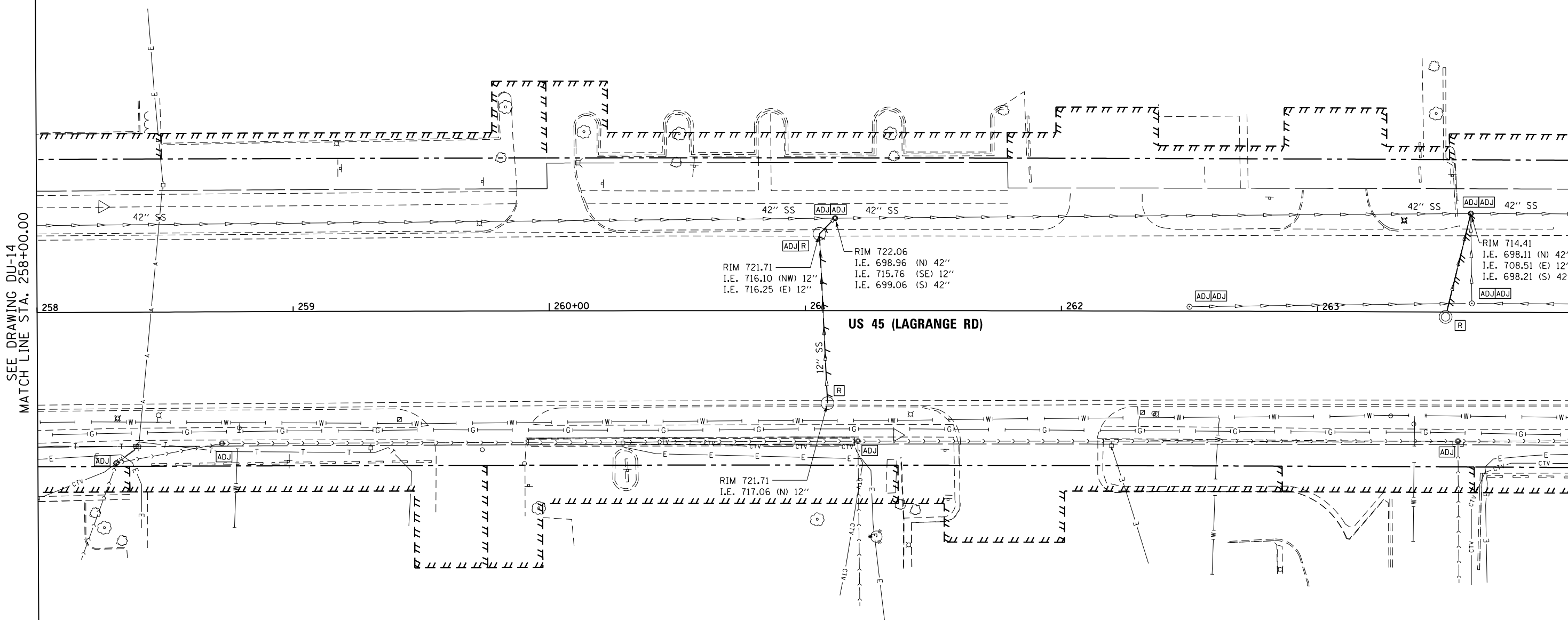
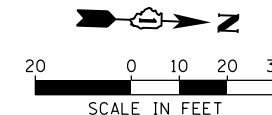

SEE DRAWING DU-14
 MATCH LINE STA. 258+00.00

MATCH LINE STA. 264+00.00
 SEE DRAWING DU-16

RIM 721.71
 I.E. 716.10 (NW) 12"
 I.E. 716.25 (E) 12"

RIM 722.06
 I.E. 698.96 (N) 42"
 I.E. 715.76 (SE) 12"
 I.E. 699.06 (S) 42"

RIM 714.41
 I.E. 698.11 (N) 42"
 I.E. 708.51 (E) 12"
 I.E. 698.21 (S) 42"

RIM 721.71
 I.E. 717.06 (N) 12"

NOTES:
 1. SEE DRAWING DN-01 FOR DRAINAGE LEGEND AND NOTES.
 2. SEE DRAWINGS DS-01 THROUGH DS-09 FOR STRUCTURE AND PIPE INFORMATION.

URS
 100 S. WACKER DR.
 CHICAGO, IL 60606
 TEL (312) 939-1000
 FAX (312) 939-4998

FILE NAME = D160M61-SHT-DRAINEX15.dgn	USER NAME = Anthony.Plutz	DESIGNED - EJD	REVISED -
SHT_PLAN	PLOT SCALE = 40.0000' / in.	DRAWN - EJD	REVISED -
	PLOT DATE = 3/14/2013	CHECKED - JWM	REVISED -
		DATE - 03/13/2013	REVISED -

STATE OF ILLINOIS
 DEPARTMENT OF TRANSPORTATION

EXISTING DRAINAGE PLAN - US 45 (LAGRANGE ROAD)

SCALE: 1"=20' SHEET 15 OF 17 SHEETS STA. 258+00.00 TO STA. 264+00.00

F.A.P. RTE.	SECTION	COUNTY	TOTAL SHEETS	SHEET NO.
330	103R-4	COOK	877	173
DU-15			CONTRACT NO. 60M61	
ILLINOIS FED. AID PROJECT				