

STORM SEWER REMOVAL 12"  
 STA. 527+66.6 TO 527+76.1 - 56' (TBF=20.5 CU YD)  
 STA. 527+66.6 TO 527+79.5 - 11' (TBF=4.3 CU YD)  
 STA. 530+34.7 TO 530+41.9 - 5' (TBF=5.1 CU YD)  
 STA. 530+41.9 TO 530+54.6 - 11' (TBF=4.1 CU YD)  
 STA. 530+41.9 TO 530+41.9 - 67' (TBF=48.6 CU YD)

REMOVING MANHOLES  
 530+41.94, 25.4 LT

REMOVING CATCH BASINS  
 527+02.63, 32.9 RT  
 527+03.99, 33.4 LT  
 528+76.08, 32.8 RT  
 528+79.53, 33.6 LT  
 530+54.63, 33.4 LT  
 530+58.88, 33.5 RT

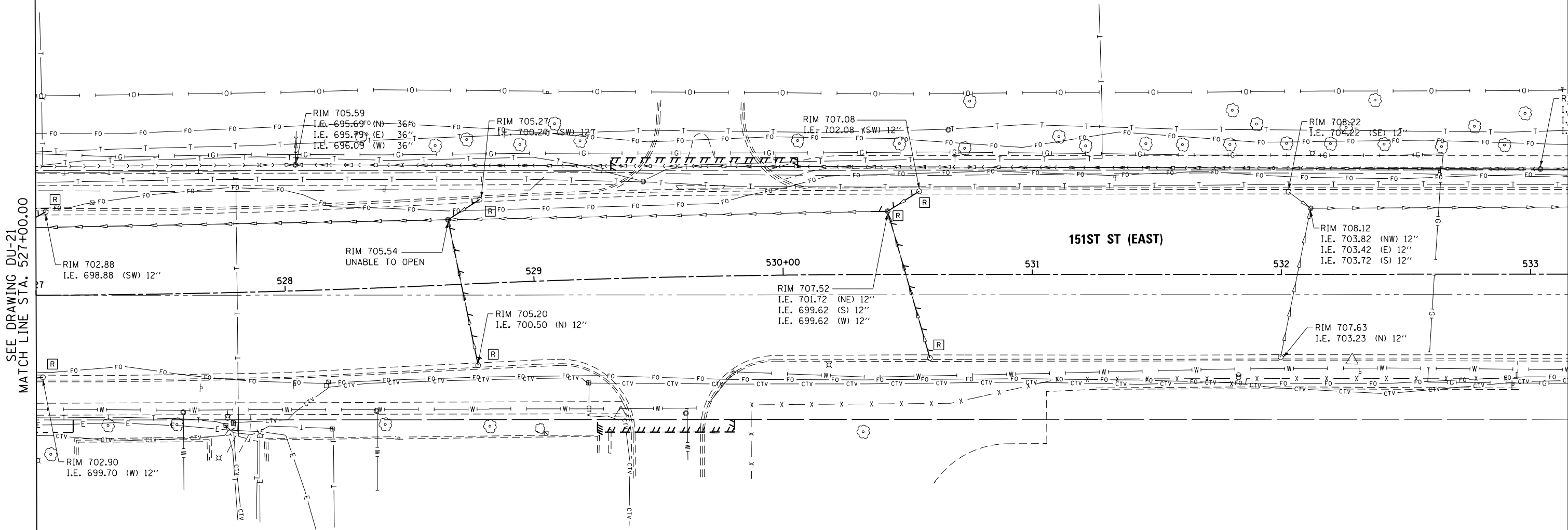
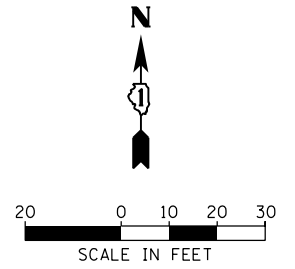

SEE DRAWING DU-21  
 MATCH LINE STA. 527+00.00

NOTES:  
 1. SEE DRAWING DN-01 FOR DRAINAGE LEGEND AND NOTES.  
 2. SEE DRAWINGS DS-01 THROUGH DS-09 FOR STRUCTURE AND PIPE INFORMATION.

100 S. WACKER DR.  
 SUITE 600  
 CHICAGO, IL 60606  
 TEL (312) 939-1000  
 FAX (312) 939-4998

**URS**

FILE NAME = D160M61-SHT-DRAINEX22.dgn	USER NAME = Anthony.Plutz	DESIGNED - EJD	REVISED -	STATE OF ILLINOIS DEPARTMENT OF TRANSPORTATION	EXISTING DRAINAGE PLAN - 151ST STREET			F.A.P. RFE. 330	SECTION 103R-4	COUNTY COOK	TOTAL SHEETS 877	SHEET NO. 180
	PLOT SCALE = 48.0000' / in.	CHECKED - JWM	REVISED -		SCALE: 1"=20'	SHEET 3 OF 3 SHEETS	STA. 527+00.00 TO STA. END	DU-22 CONTRACT NO. 60M61				
SHT.PLAN	PLOT DATE = 3/14/2013	DATE - 03/13/2013	REVISED -		ILLINOIS FED. AID PROJECT							