

| | | |
|------|-----------------------------|------|
| PLAN | SURVEYED | DATE |
| | PLOTTED | BY |
| | GRADES CHECKED | |
| | STRUCTURE NOTATIONS CHECKED | |
| | NOTE BOOK NO. | |
| | FILE NAME | |

| | | |
|---------|-----------------------------|------|
| PROFILE | SURVEYED | DATE |
| | PLOTTED | BY |
| | GRADES CHECKED | |
| | STRUCTURE NOTATIONS CHECKED | |
| | NOTE BOOK NO. | |
| | FILE NAME | |

100 S. WACKER DR.
SUITE 500
CHICAGO, IL 60606
TEL (312) 329-4000
FAX (312) 329-4098

URS

SEE DRAWING WT-10
MATCH LINE STA. 252+00.00

64A WATER SERVICE CONNECTION
STA. 253+95, 2" TO 1 1/2"
REDUCER. SEE SERVICE
CONNECTION DETAIL

64 12"x6" TEE, MJ
STA 253+82, 55.0' LT
N 1806151.44
E 1115317.45
INSTALL 6" PIPE AND FITTINGS AS NECESSARY
HYDRANT WITH AUXILIARY VALVE AND BOX
STA 253+82, 59.0' LT
N 1806151.32
E 1115314.06

65 12" GATE VALVE IN VAULT
STA 257+01, 55.0' LT
N 1806502.55
E 1115306.25

66 12"x6" TEE, MJ
STA 257+07, 55.0' LT
N 1806507.82
E 1115306.11
INSTALL 6" PIPE AND
FITTINGS AS NECESSARY
HYDRANT WITH AUXILIARY VALVE AND BOX
STA 257+07, 65.0' LT
N 1806507.53
E 1115295.64

66A WATER SERVICE CONNECTION
STA. 255+48, 2" SEE SERVICE
CONNECTION DETAIL

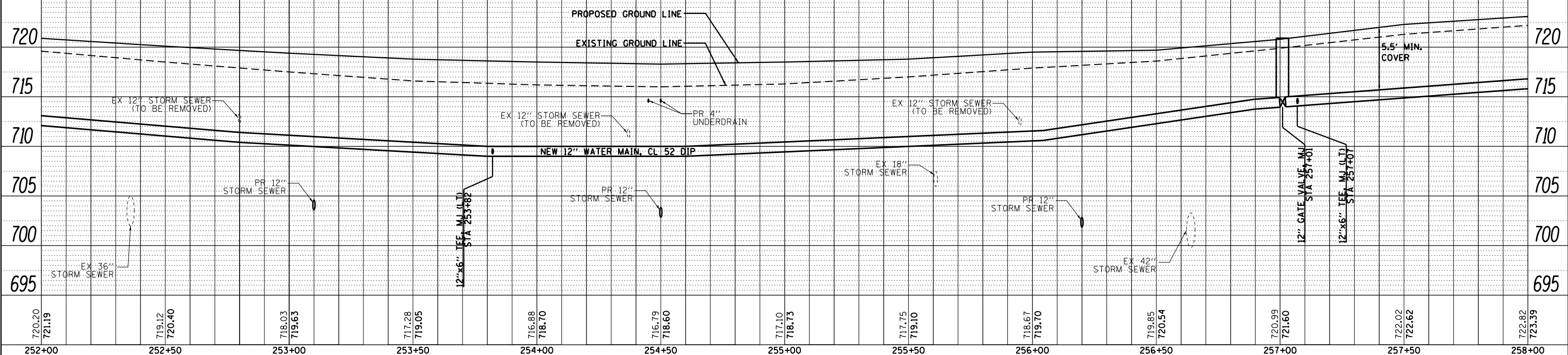
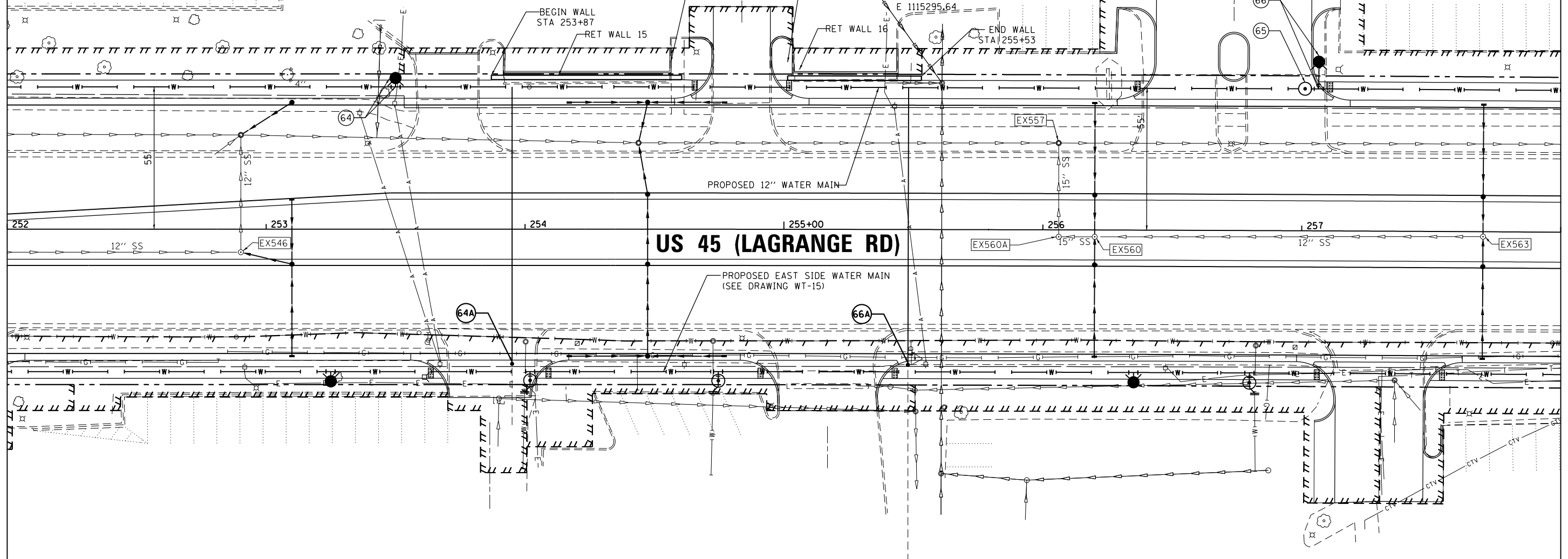

MATCH LINE STA. 258+00.00
SEE DRAWING WT-12

| | | | | | | | | | | | | |
|-------------------------------------|---------------------------|-------------------|-------------|---|--|---|--|---------------------|------------------|--------------------|--------------------|---------------------------|
| FILE NAME = D160M61-SHT-WATER11.dgn | USER NAME = Anthony.Plutz | DESIGNED - DF | REVISIONS - | STATE OF ILLINOIS DEPARTMENT OF TRANSPORTATION | | WATER MAIN - PROPOSED PLAN AND PROFILE US 45 (LAGRANGE ROAD) - WEST SIDE | | F.A.P. R.T.E. = 330 | SECTION = 103R-4 | COUNTY = COOK | TOTAL SHEETS = 877 | SHEET NO. = 242 |
| PLOT SCALE = 40.0000' / in. | CHECKED - TDW | DATE - 03/13/2013 | REVISIONS - | SCALE: 1"=20'H/1"=5'V | | SHEET 11 OF 21 SHEETS STA. 252+00.00 TO STA. 258+00.00 | | WT-11 | | CONTRACT NO. 60M61 | | ILLINOIS FED. AID PROJECT |