

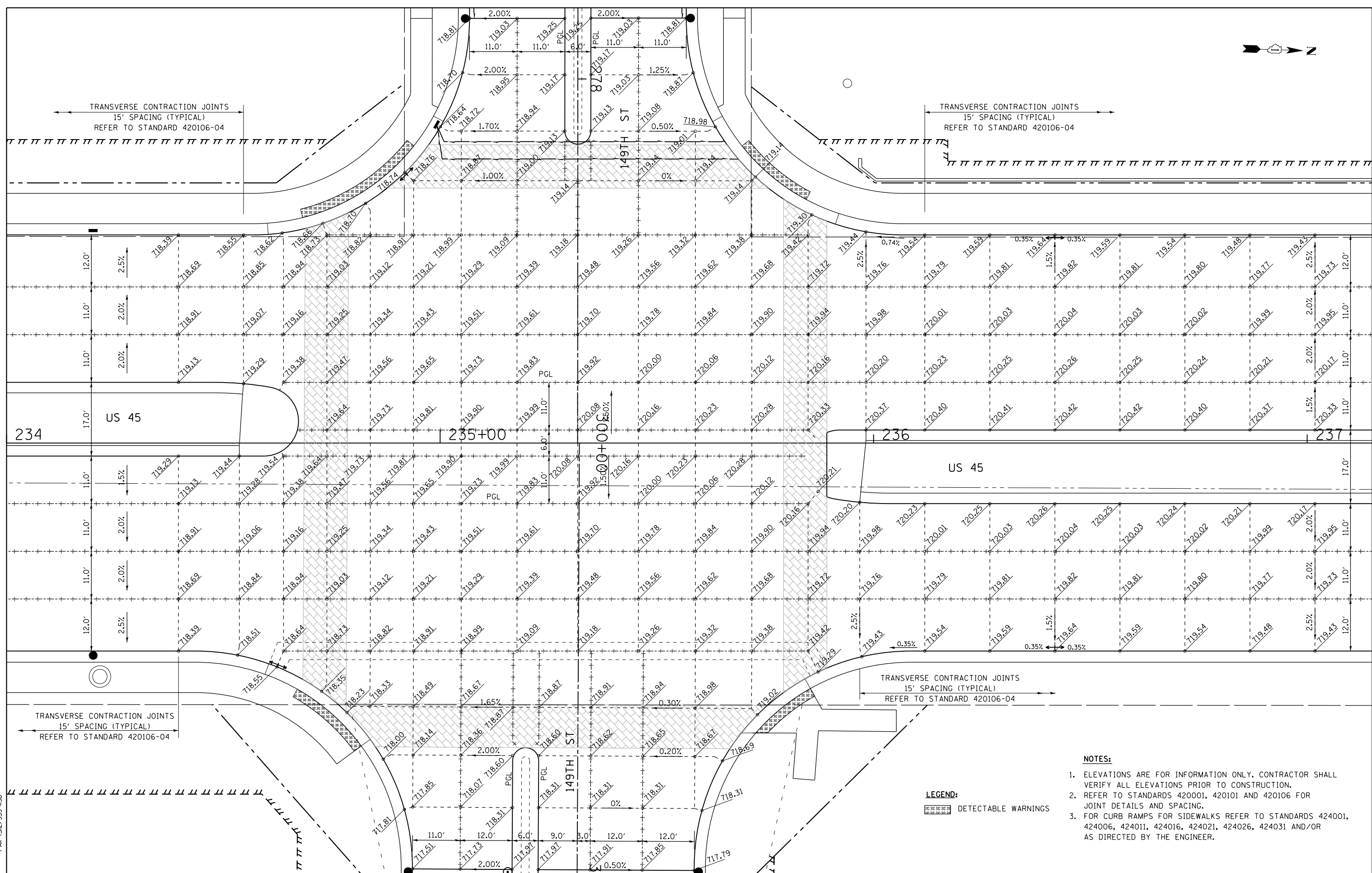

TRANSVERSE CONTRACTION JOINTS  
15' SPACING (TYPICAL)  
REFER TO STANDARD 420106-04

TRANSVERSE CONTRACTION JOINTS  
15' SPACING (TYPICAL)  
REFER TO STANDARD 420106-04



**LEGEND:**  
 DETECTABLE WARNINGS

- NOTES:**
- ELEVATIONS ARE FOR INFORMATION ONLY. CONTRACTOR SHALL VERIFY ALL ELEVATIONS PRIOR TO CONSTRUCTION.
  - REFER TO STANDARDS 420001, 420101 AND 420106 FOR JOINT DETAILS AND SPACING.
  - FOR CURB RAMPS FOR SIDEWALKS REFER TO STANDARDS 424001, 424006, 424011, 424016, 424021, 424026, 424031 AND/OR AS DIRECTED BY THE ENGINEER.

**URS**  
 100 S. WACKER DR.  
 SUITE 600  
 CHICAGO, IL 60606  
 TEL (312) 939-1000  
 FAX (312) 939-4998

FILE NAME = D160M61-SHT-PAVEMENT-DETAILS04.dgn	USER NAME = Anthony.Plutz	DESIGNED - JTF	REVISED -
		DRAWN - JTF	REVISED -
		CHECKED - MJT	REVISED -
		DATE - 03/13/2013	REVISED -

**STATE OF ILLINOIS  
DEPARTMENT OF TRANSPORTATION**

**INTERSECTION DETAILS  
US 45 (LAGRANGE ROAD) AND 149TH STREET**  
 SCALE: 1"=10' SHEET 4 OF 7 SHEETS STA. TO STA.

F.A.P. RTE.	SECTION	COUNTY	TOTAL SHEETS	SHEET NO.
330	103R-4	COOK	877	294
<b>PD-04</b>		CONTRACT NO. 60M61		
ILLINOIS FED. AID PROJECT				