

TRANSVERSE CONTRACTION JOINTS
15' SPACING (TYPICAL)
REFER TO STANDARD 420106-04

TRANSVERSE CONTRACTION JOINTS
15' SPACING (TYPICAL)
REFER TO STANDARD 420106-04

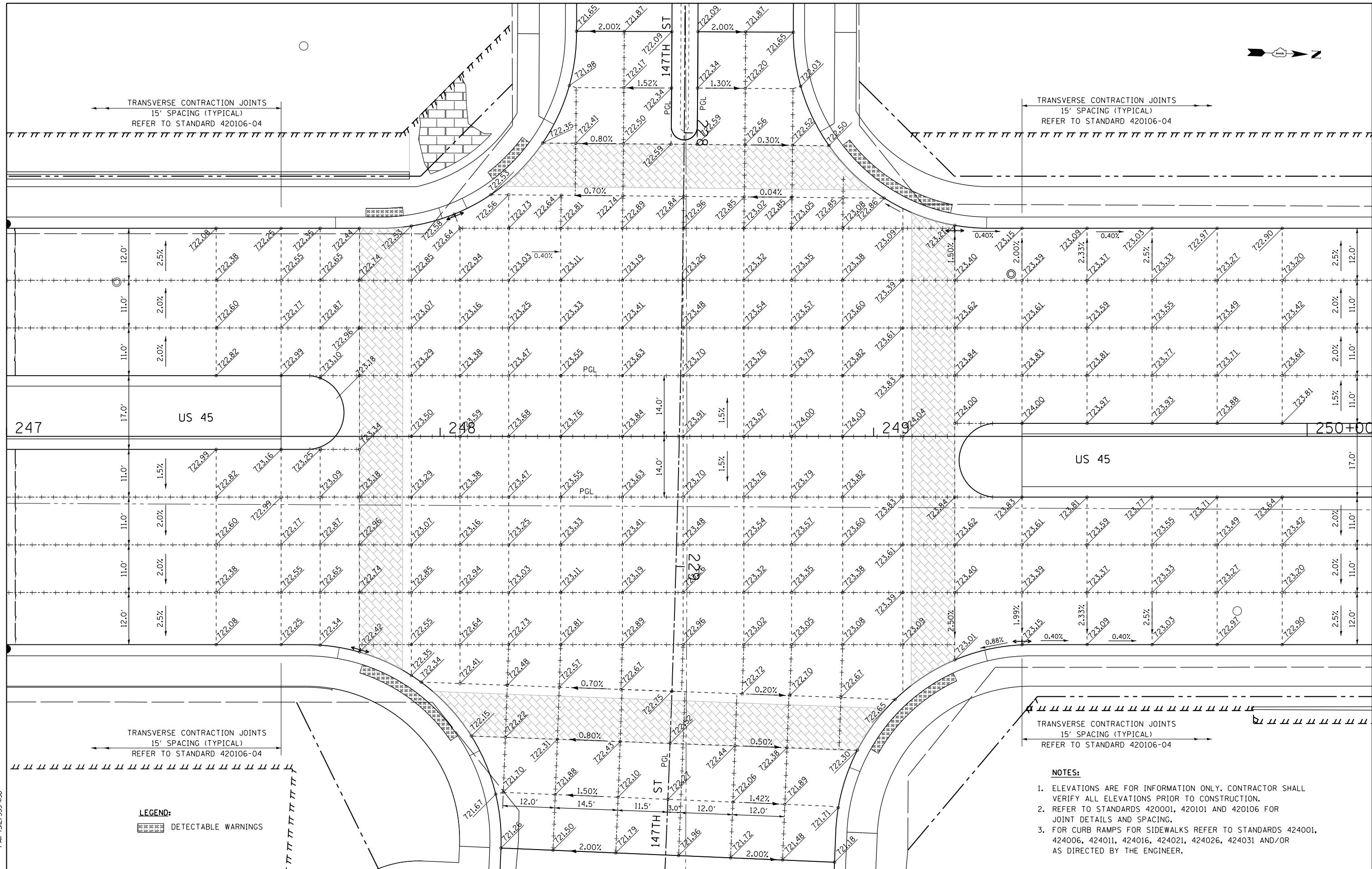

LEGEND:
[Symbol] DETECTABLE WARNINGS

- NOTES:**
- ELEVATIONS ARE FOR INFORMATION ONLY. CONTRACTOR SHALL VERIFY ALL ELEVATIONS PRIOR TO CONSTRUCTION.
 - REFER TO STANDARDS 420001, 420101 AND 420106 FOR JOINT DETAILS AND SPACING.
 - FOR CURB RAMPS FOR SIDEWALKS REFER TO STANDARDS 424001, 424006, 424011, 424016, 424021, 424026, 424031 AND/OR AS DIRECTED BY THE ENGINEER.

URS
100 S. WACKER DR.
SUITE 600
CHICAGO, IL 60606
TEL (312) 939-1000
FAX (312) 939-4998

FILE NAME = D160M61-SHT-PAVEMENT-DETAILS05.dgn	USER NAME = Anthony.Plutz	DESIGNED - JTF	REVISED -
		DRAWN - JTF	REVISED -
		CHECKED - MJT	REVISED -
SHT.PLAN	PLOT DATE = 3/14/2013	DATE - 03/13/2013	REVISED -

**STATE OF ILLINOIS
DEPARTMENT OF TRANSPORTATION**

**INTERSECTION DETAILS
US 45 (LAGRANGE ROAD) AND 147TH STREET**

SCALE: 1"=10' SHEET 5 OF 7 SHEETS STA. TO STA.

F.A.P. RTE. 330	SECTION 103R-4	COUNTY COOK	TOTAL SHEETS 877	SHEET NO. 295
PD-05		CONTRACT NO. 60M61		
ILLINOIS FED. AID PROJECT				