

DATE	
BY	
FINISHED SURVEY	
PLOTTED	
TEMPLATE	
NOTE BOOK	
AREAS CHECKED	

DATE	
BY	
ORIGINAL SURVEY	
PLOTTED	
TEMPLATE	
NOTE BOOK	
AREAS CHECKED	

100 SWACKER DR.  
 300  
 CHICAGO, IL 60606  
 TEL 312/939-0000  
 FAX 312/939-0198

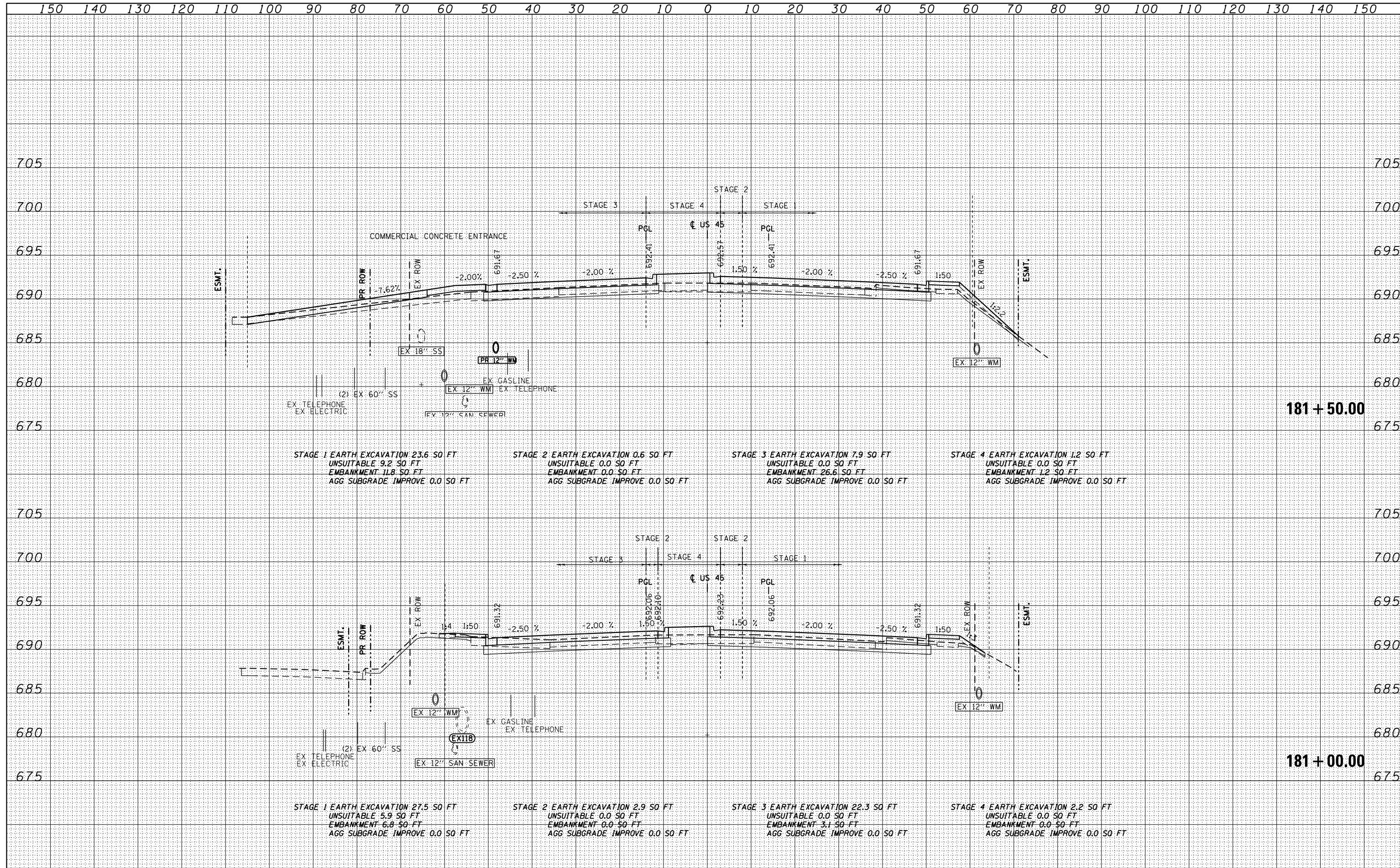

FILE NAME = D:\60M61-SHT-XSHT01.dgn	USER NAME = Anthony.Plutz	DESIGNED - JCL	REVISED -	<b>STATE OF ILLINOIS</b> <b>DEPARTMENT OF TRANSPORTATION</b> <b>US 45 CROSS SECTIONS</b> SCALE: 1"=10'H; 1"=5' V SHEET NO. 5 OF 123 SHEETS STA. 181+00.00 TO STA. 181+50.00	F.A.P. RTE. 330	SECTION 103R-4	COUNTY COOK	TOTAL SHEETS 877	SHEET NO. 710	
	PLOT SCALE = 20.0000' / in.	CHECKED - MJT	REVISED -		<b>XS-US45-05</b>		CONTRACT NO. 60M61		ILLINOIS FED. AID PROJECT	
	PLOT DATE = 3/13/2013	DATE - 03/13/2013	REVISED -							