

DATE	
BY	
SURVEYED	
PLOTTED	
TEMPLATE	
AREAS	
CHECKED	
NO.	

DATE	
BY	
SURVEYED	
PLOTTED	
TEMPLATE	
AREAS	
CHECKED	
NO.	

100 S. WACKER DR.  
 CHICAGO, IL 60606  
 TEL 312/939-4000  
 FAX 312/939-4198

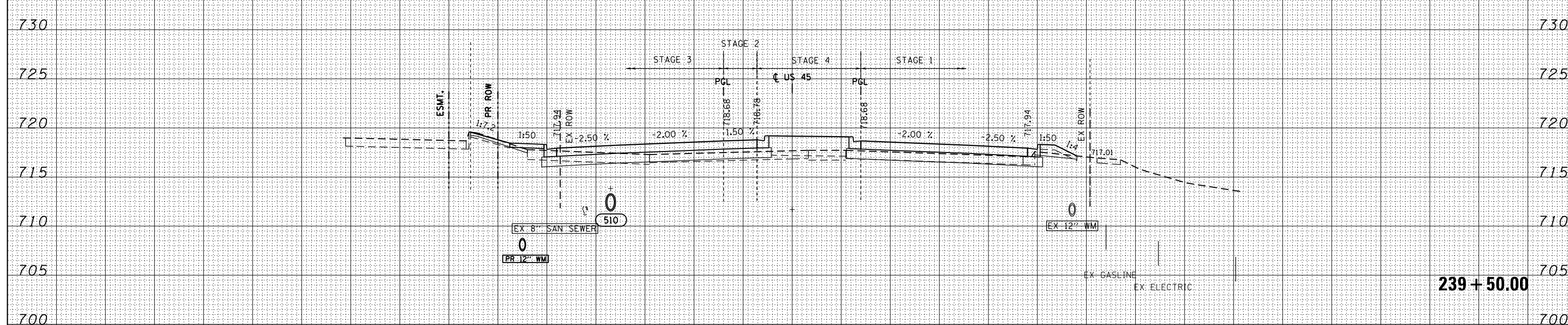
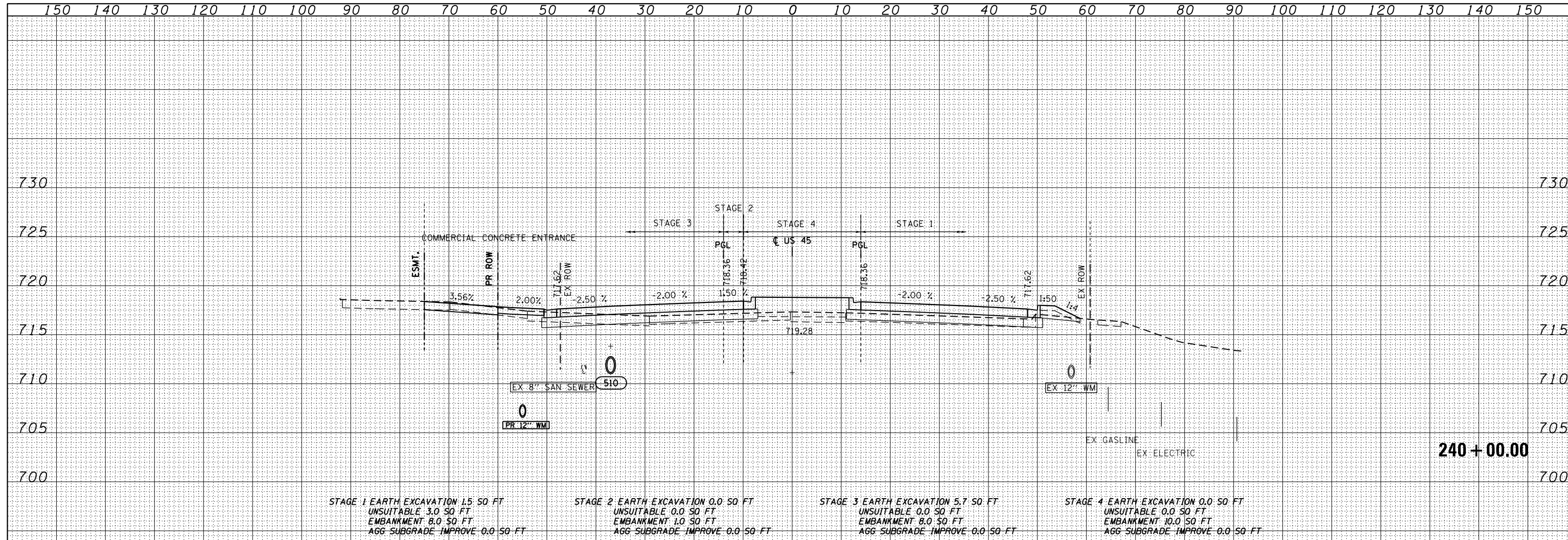

FILE NAME =	USER NAME = Anthony.Plutz	DESIGNED - JCL	REVISED -	<b>STATE OF ILLINOIS</b> <b>DEPARTMENT OF TRANSPORTATION</b>	<b>US 45 CROSS SECTIONS</b> SCALE: 1"=10'H, 1"=5' V SHEET NO. 72 OF 123 SHEETS STA. 239+50.00 TO STA. 240+00.00	F.A.P. R.E.	SECTION	COUNTY	TOTAL SHEETS	SHEET NO.
D160M61-SHT-XSSH01.dgn		DRAWN - JCL	REVISED -			330	103R-4	COOK	877	777
		CHECKED - MJT	REVISED -			<b>XS-US45-72</b>		CONTRACT NO. 60M61		
		DATE - 03/13/2013	REVISED -			ILLINOIS FED. AID PROJECT				