

DATE	
BY	
FINISHED	
NO. OF SHEETS	
DATE	
BY	
FINISHED	
NO. OF SHEETS	
DATE	
BY	
FINISHED	
NO. OF SHEETS	

DATE	
BY	
FINISHED	
NO. OF SHEETS	
DATE	
BY	
FINISHED	
NO. OF SHEETS	
DATE	
BY	
FINISHED	
NO. OF SHEETS	

100 S. WACKER DR.
 CHICAGO, IL 60606
 TEL (312) 939-4000
 FAX (312) 939-4198

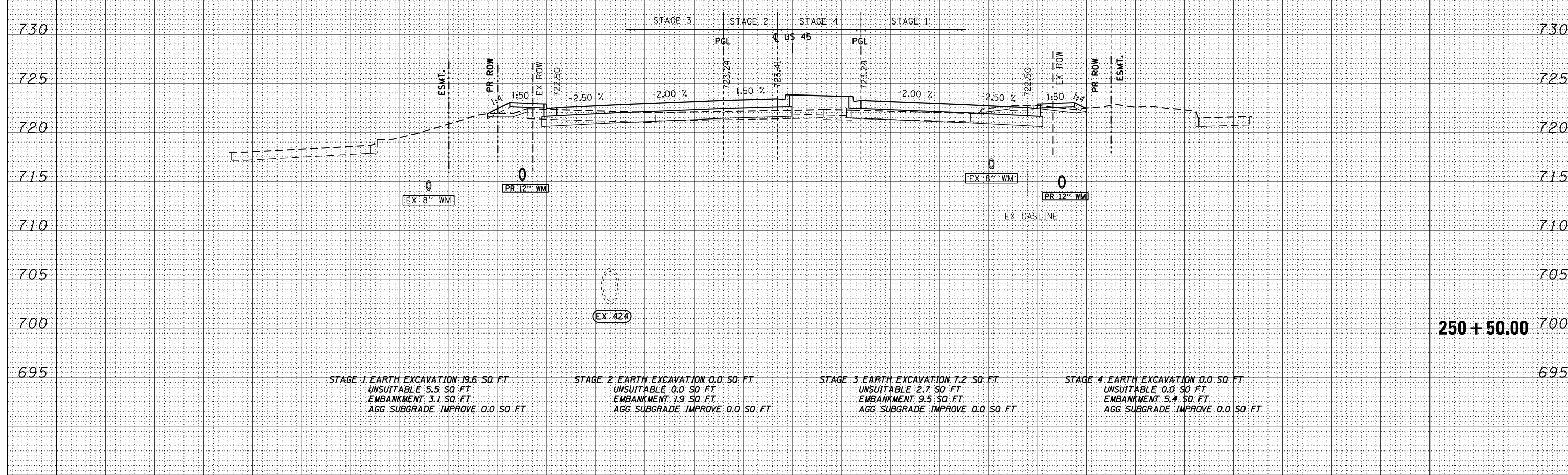
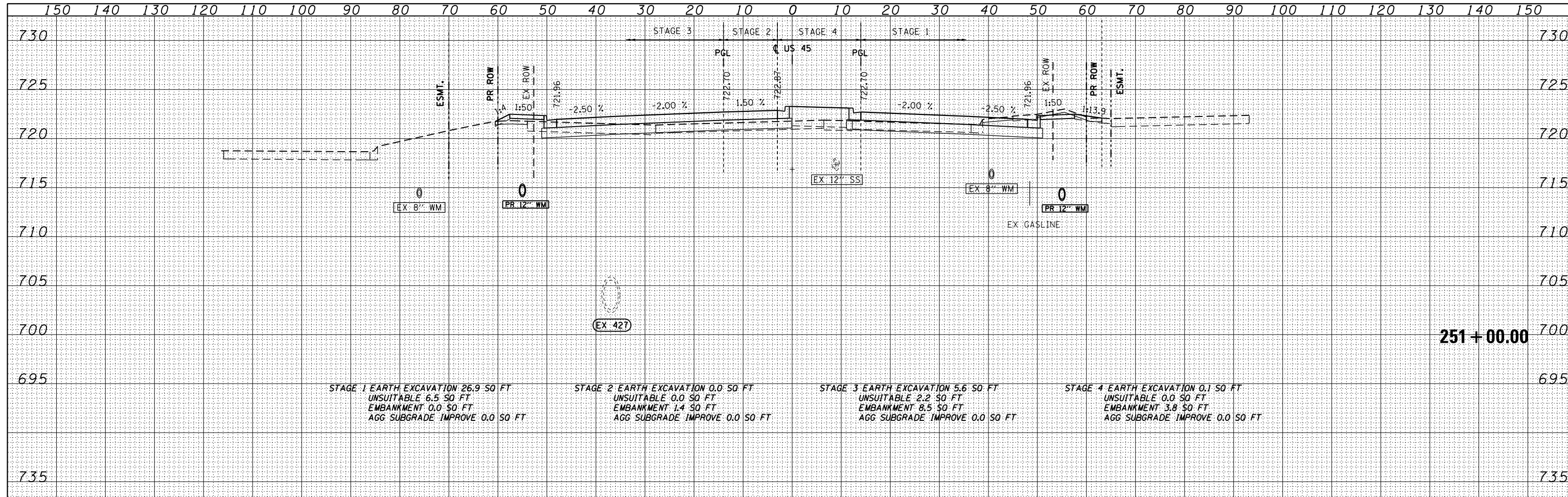

FILE NAME =	USER NAME = Anthony.Plutz	DESIGNED - JCL	REVISED -	STATE OF ILLINOIS DEPARTMENT OF TRANSPORTATION	US 45 CROSS SECTIONS - SCALE: 1"=10'H; 1"=5'V SHEET NO. 84 OF 123 SHEETS STA. 250+50.00 TO STA. 251+00.00	F.A.P. RTE.	SECTION	COUNTY	TOTAL SHEETS	SHEET NO.
D160M61-SHT-XSSH01.dgn		DRAWN - JCL	REVISED -			330	103R-4	COOK	877	789
		CHECKED - MJT	REVISED -			XS-US45-84		CONTRACT NO. 60M61		
		DATE - 03/13/2013	REVISED -			ILLINOIS FED. AID PROJECT				