

DATE	
BY	
SURVEYED	
PLOTTED	
TEMPLATE	
AREAS	
CHECKED	
FINAL SURVEY	
NOTE BOOK	
NO.	

DATE	
BY	
SURVEYED	
PLOTTED	
TEMPLATE	
AREAS	
CHECKED	
ORIGINAL SURVEY	
NOTE BOOK	
NO.	

100 SWACKER DR.  
 CHICAGO, IL 60606  
 TEL (312) 939-4000  
 FAX (312) 939-4098

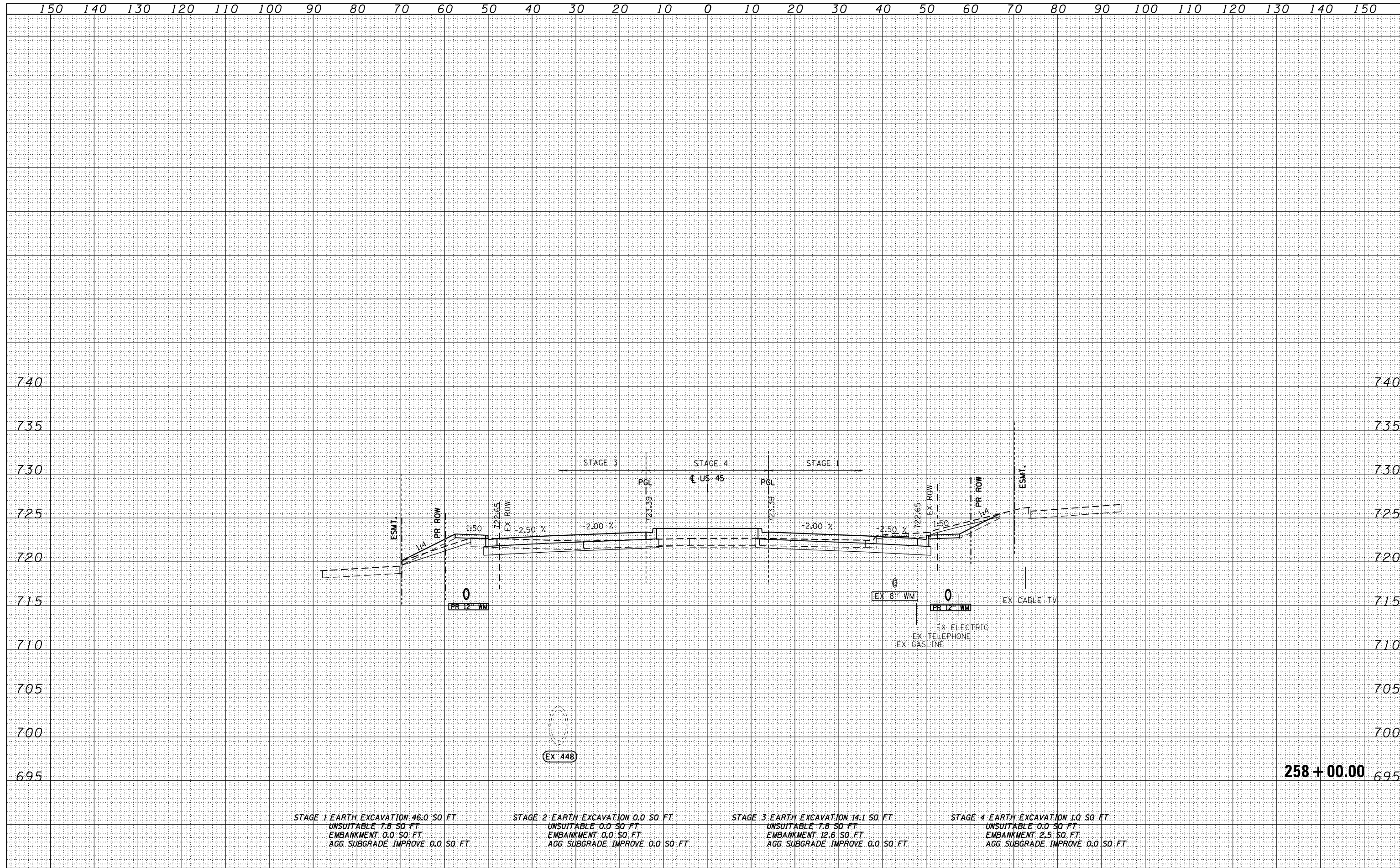

STAGE 1 EARTH EXCAVATION 46.0 SQ. FT.  
 UNSUITABLE 7.8 SQ. FT.  
 EMBANKMENT 0.0 SQ. FT.  
 AGG. SUBGRADE IMPROVE 0.0 SQ. FT.

STAGE 2 EARTH EXCAVATION 0.0 SQ. FT.  
 UNSUITABLE 0.0 SQ. FT.  
 EMBANKMENT 0.0 SQ. FT.  
 AGG. SUBGRADE IMPROVE 0.0 SQ. FT.

STAGE 3 EARTH EXCAVATION 14.1 SQ. FT.  
 UNSUITABLE 7.8 SQ. FT.  
 EMBANKMENT 12.6 SQ. FT.  
 AGG. SUBGRADE IMPROVE 0.0 SQ. FT.

STAGE 4 EARTH EXCAVATION 1.0 SQ. FT.  
 UNSUITABLE 0.0 SQ. FT.  
 EMBANKMENT 2.5 SQ. FT.  
 AGG. SUBGRADE IMPROVE 0.0 SQ. FT.

FILE NAME = D:\6061-SHT-XSST01.dgn	USER NAME = Anthony.Plutz	DESIGNED - JCL	REVISIED -	<b>STATE OF ILLINOIS</b> <b>DEPARTMENT OF TRANSPORTATION</b>	<b>US 55 CROSS SECTIONS</b> -			F.A.P. RTE. 330	SECTION 103R-4	COUNTY COOK	TOTAL SHEETS 877	SHEET NO. 799
		DRAWN - JCL	REVISIED -					XS-US45-94			CONTRACT NO. 60M61	
		CHECKED - MJT	REVISIED -		SCALE: 1"=10'H; 1"=5' V			SHEET NO. 94 OF 123 SHEETS		STA. 258+00.00 TO STA. 258+00.00		
		DATE - 03/13/2013	REVISIED -		ILLINOIS FED. AID PROJECT							