

DATE	
BY	
FINISHED SURVEY	
PLOTTED	
TEMPLATE	
NOTE BOOK	
AREAS CHECKED	
NO.	

DATE	
BY	
ORIGINAL SURVEY	
PLOTTED	
TEMPLATE	
NOTE BOOK	
AREAS CHECKED	
NO.	

100 S. WACKER DR.  
 CHICAGO, IL 60606  
 TEL 312/939-4000  
 FAX 312/939-4098

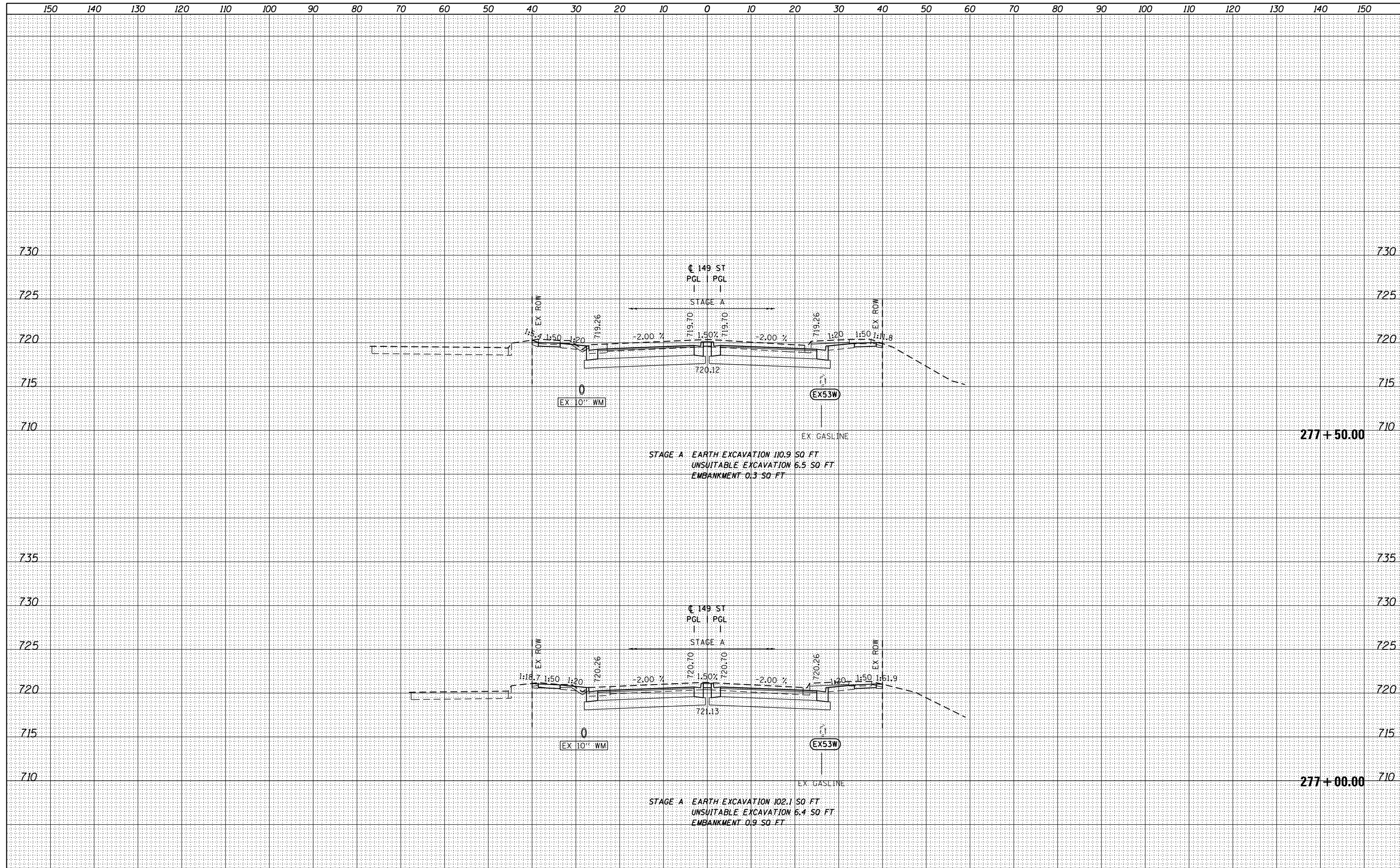

FILE NAME =	USER NAME = Anthony.Plutz	DESIGNED - JCL	REVISIED -	<b>STATE OF ILLINOIS</b> <b>DEPARTMENT OF TRANSPORTATION</b>	<b>149th STREET CROSS SECTIONS</b> SCALE: 1"=10'H; 1"=5' V SHEET NO. 3 OF 6 SHEETS STA. 277+00.00 TO STA. 277+50.00	F.A.P. RTE.	SECTION	COUNTY	TOTAL SHEETS	SHEET NO.
D160M61-SHT-XSST04.dgn		DRAWN - JCL	REVISIED -			330	103R-4	COOK	877	854
PLOT SCALE = 20.0000" / in.		CHECKED - MJT	REVISIED -			XS-149-03		CONTRACT NO. 60M61		
PLOT DATE = 3/13/2013		DATE - 03/13/2013	REVISIED -			ILLINOIS FED. AID PROJECT				