

Bench Mark: Elev. 689.00 Top of brass survey monument located at the west edge of the LaGrange Road southbound pavement, 600 feet north of the SouthWest Highway bridge.

Existing Structure: None

New railroad abutment built under separate contract (S.N. 016-6201)

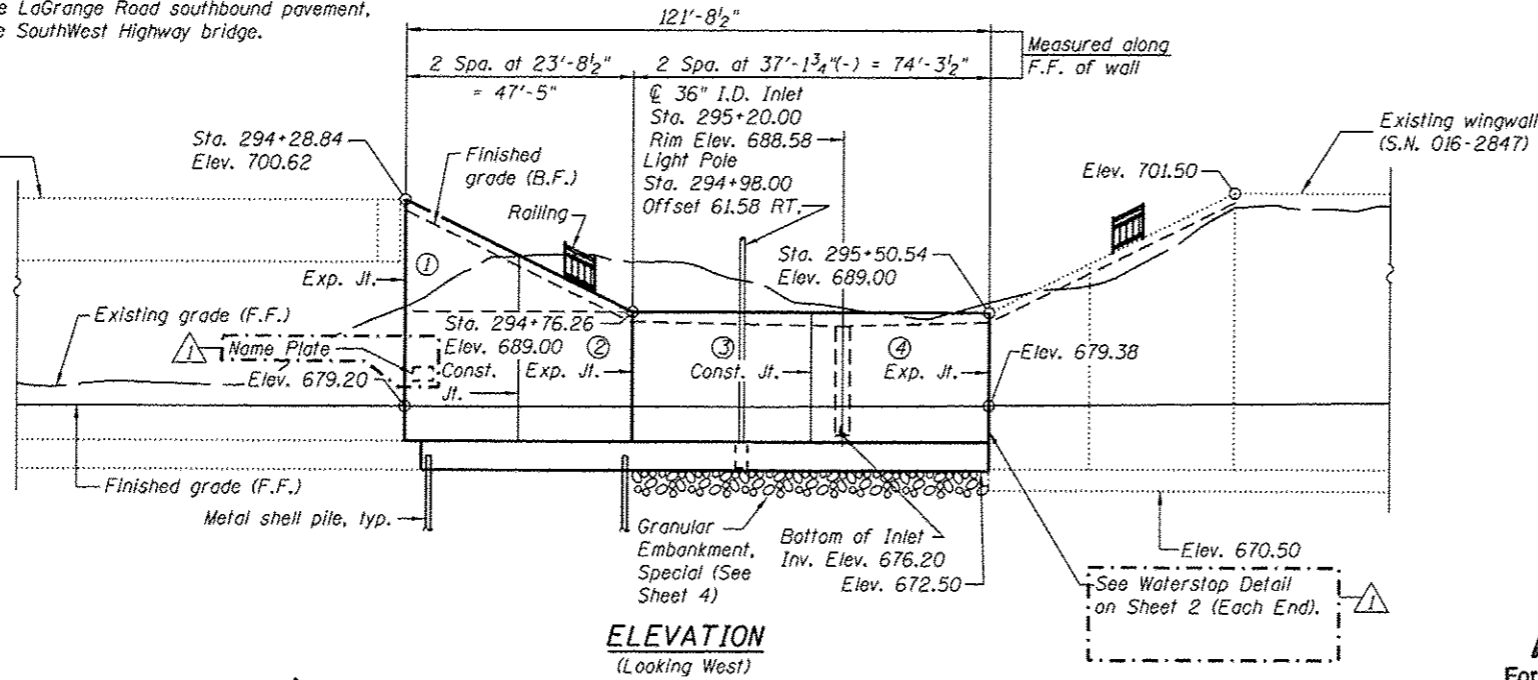

**ELEVATION**  
(Looking West)

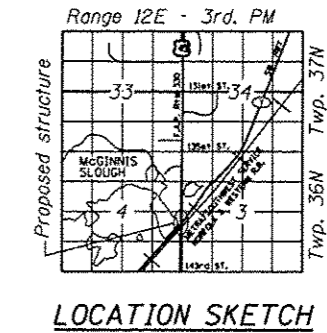

**LOCATION SKETCH**

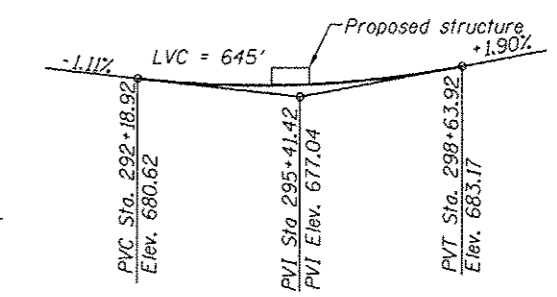

**PROFILE GRADE - PROPOSED LAGRANGE RD**  
(along PGL roadway)

**APPROVED**  
For Structural Adequacy Only  
*Arif M. Khan*  
Engineer of Bridges & Structures



*Arsalan M. Khan*  
ARSALAN M. KHAN, S.E.  
LICENSE NO.: 081-006258  
EXPIRES: NOVEMBER 30, 2014  
DATE: 04-11-2013

**DESIGN STRESSES**  
**FIELD UNITS**  
f'c = 3,500 psi  
fy = 60,000 psi (Reinforcement)  
fy = 50,000 psi (M270 Grade 50)

**DESIGN SPECIFICATIONS**  
2002 AASHTO Standard Specifications  
for Highway Bridges

**LEGEND**

- Prop. Drainage Structure
- ▶ Prop. Storm Sewer
- Prop. Lighting
- ◆ Soil Boring
- F.F.=Front Face
- B.F.=Back Face
- E.F.=Each Face
- I.F.=Inside Face
- O.F.=Outside Face
- ① = Panel No.

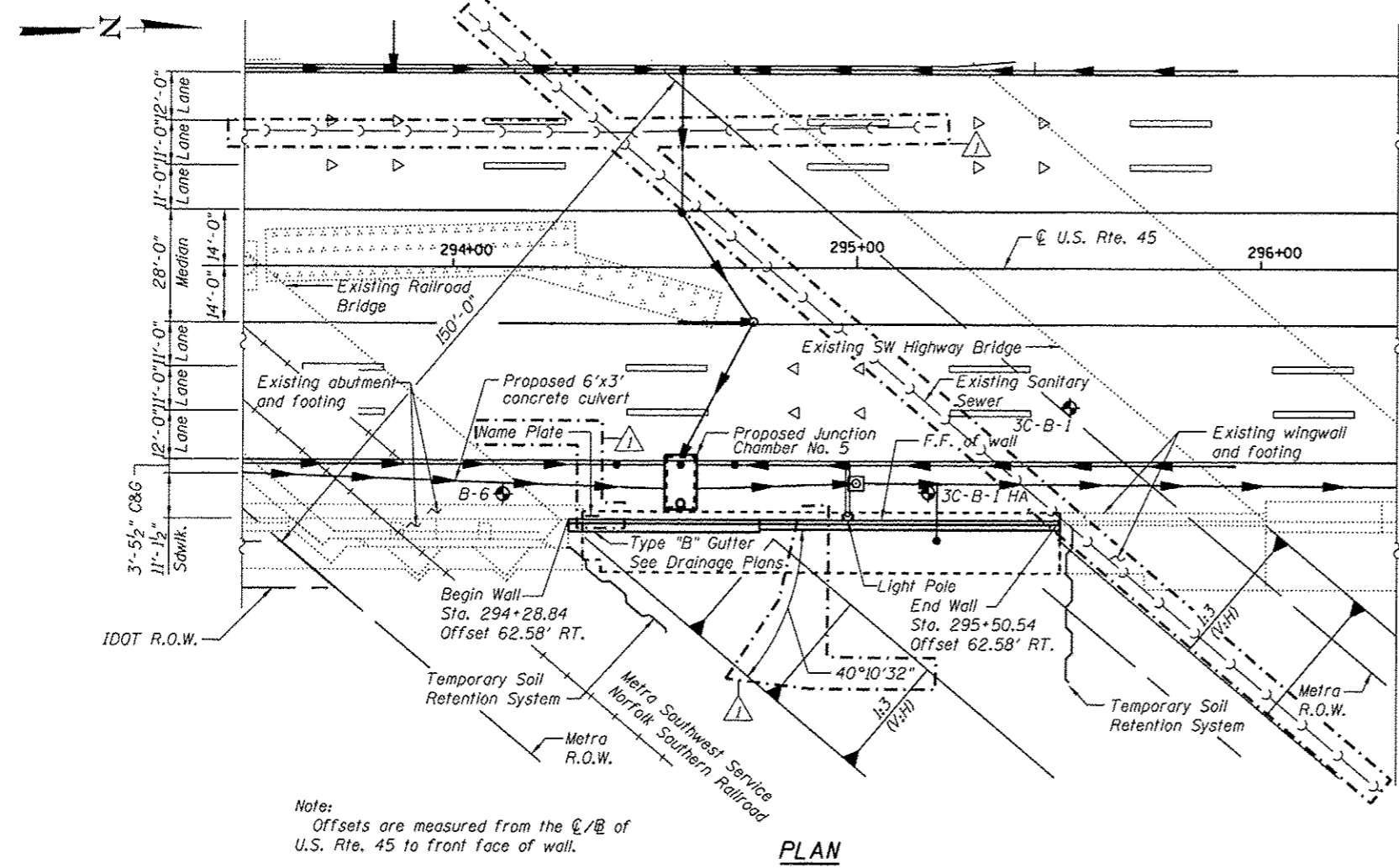

**PLAN**

Note:  
Offsets are measured from the C/B of U.S. Rte. 45 to front face of wall.

**GENERAL PLAN & ELEVATION**  
**U.S. ROUTE 45 - LAGRANGE ROAD**  
**F.A.P. RTE. 330 SEC. 103R-5**  
**COOK COUNTY**  
**STATION 294+28.84 TO 295+50.54**  
**STRUCTURE NO. 016-2004**

URS  
100 S. WACKER DR.  
CHICAGO, IL 60606  
TEL (312) 433-4000  
FAX (312) 433-4088

|                                       |                          |                 |                             |
|---------------------------------------|--------------------------|-----------------|-----------------------------|
| FILE NAME = 0162004-60M62-001-CPE.dgn | USER NAME = arsalan.khan | DESIGNED - MJL  | REVISED - 04/12/2013 P.M.H. |
|                                       |                          | CHECKED - NPP   | REVISED -                   |
|                                       |                          | DRAWN - PMH/AMV | REVISED -                   |
|                                       |                          | CHECKED - MJL   | REVISED -                   |

STATE OF ILLINOIS  
DEPARTMENT OF TRANSPORTATION

| F.A.P. RTE. | SECTION | COUNTY | TOTAL SHEETS | SHEET NO.          |
|-------------|---------|--------|--------------|--------------------|
| 330         | 103R-5  | COOK   | 778          | 410                |
|             |         |        |              | CONTRACT NO. 60M62 |