

SECTION THRU SHEET PILE WALL
(Looking North)

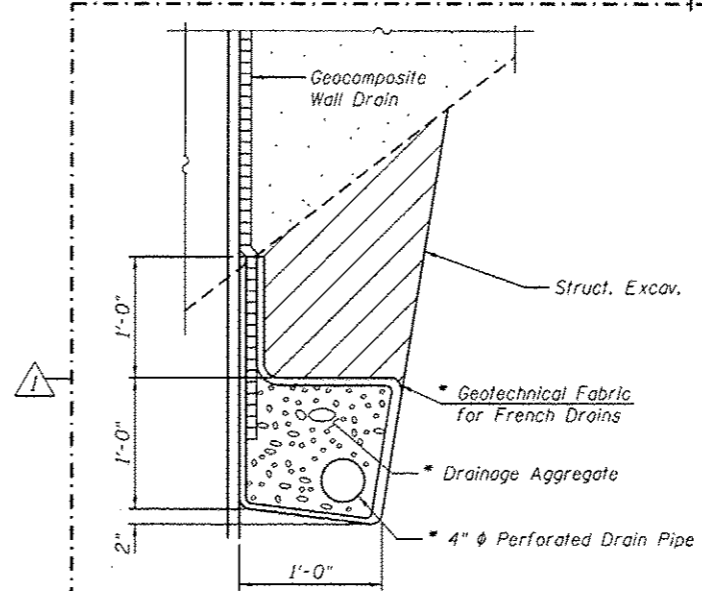

PIPE UNDERDRAIN DETAIL

TOTAL BILL OF MATERIAL

ITEM	UNIT	TOTAL
Structure Excavation	Cu. Yd.	101.7
Concrete Structures	Cu. Yd.	161.7
Furnishing and Erecting Structural Steel	Pound	5,500
Stud Shear Connectors	Each	1,290
Reinforcement Bars	Pound	680
Reinforcement Bars, Epoxy Coated	Pound	11,620
Geocomposite Wall Drain	Sq. Yd.	114
Permanent Steel Sheet Piling	Sq. Ft.	28,731
Granular Backfill for Structures	Cu. Yd.	242.7
Ornamental Railing	Foot	950
Pipe Underdrains for Structures 4"	Foot	998
Name Plates	Each	1

GENERAL NOTES

- Fasteners shall be ASTM A325 Type 3, mechanically galvanized bolts. Bolts $\frac{3}{4}$ in. ϕ , holes $\frac{13}{16}$ in. ϕ unless otherwise noted.
- Calculated weight of Structural Steel for Waters and Bolts = 5,500 lbs.
- All structural steel for Waters shall be AASHTO M 270 Grade 50W.
- No field welding is permitted except as specified in the contract documents.
- Reinforcement bars designated (E) shall be epoxy coated.
- Concrete cap shall be constructed after backfill is in place.
- All exposed corners shall have a 1" chamfer.
- See special provision "Permanent Steel Sheet Piling (LRFD)".

INDEX OF SHEETS

- General Plan & Elevation
- General Details & Bill of Material
- Detailed Plan and Elevation 1
- Detailed Plan and Elevation 2
- Detailed Plan and Elevation 3
- Detailed Plan and Elevation 4
- Detailed Plan and Elevation 5
- Detailed Plan and Elevation 6
- Water and Headwall Details
- Soil Borings 1
- Soil Borings 2
- Soil Borings 3
- Soil Borings 4
- Soil Borings 5
- Soil Borings 6
- Soil Borings 7
- Soil Borings 8
- Soil Borings 9
- Soil Borings 10
- Soil Borings 11
- Soil Borings 12

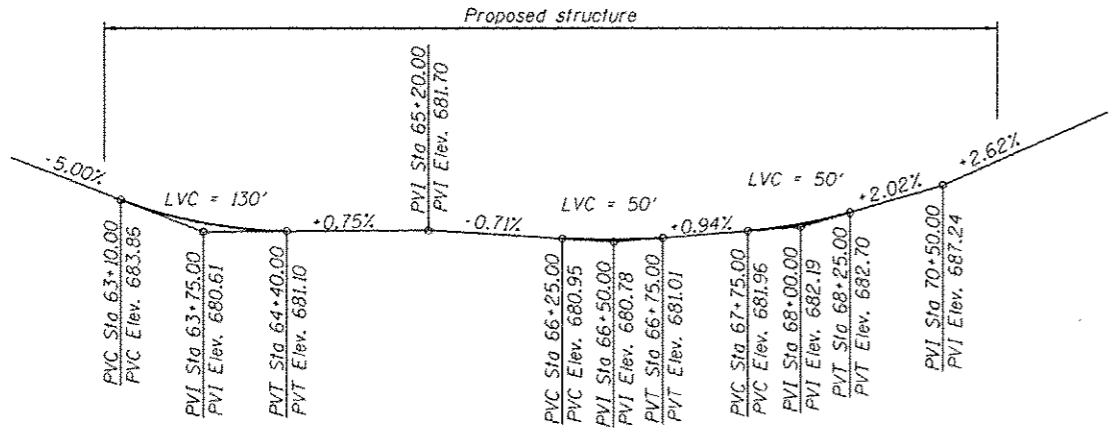

PROFILE GRADE-PROPOSED MUTLI-USE PATH
(along PGL path)

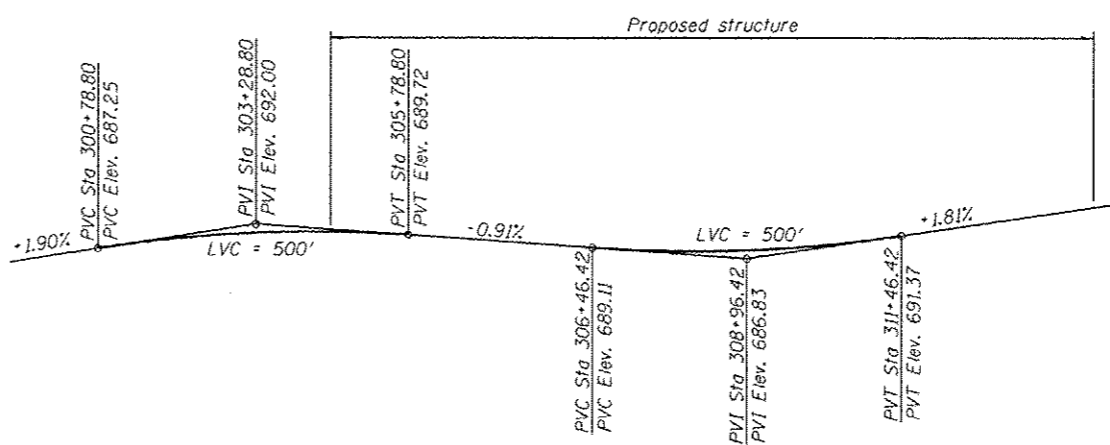

PROFILE GRADE-PROPOSED LAGRANGE RD
(along PGL roadway)

400 S. WACKER DR.
 SUITE 500
 CHICAGO, IL 60606
 TEL (312) 939-0000
 FAX (312) 939-4158
URS

FILE NAME = 0162005-60M62-002-040.dgn	USER NAME = arealen_khan	DESIGNED - PMH	REVISED - 04/12/2013 P.M.H.
		CHECKED - AMK	REVISED -
		DRAWN - PMH/AMV	REVISED -
		CHECKED - AMK	REVISED -

STATE OF ILLINOIS
DEPARTMENT OF TRANSPORTATION

GENERAL DETAILS & BILL OF MATERIAL
STRUCTURE NO. 016-2006
 SHEET NO. 2 OF 21 SHEETS

F.A.P. RTE. 330	SECTION 103R-5	COUNTY COOK	TOTAL SHEETS 778	SHEET NO. 442
CONTRACT NO. 60M62				ILLINOIS FED. AID PROJECT