

DRIVEWAY REMOVALS		PAVED SHOULDER REMOVALS			
STATION		②	③	④	
302+63 (RT)	351 SY	304+34.1	303+38.3	306+95.5	
PAVEMENT REMOVAL	351 SY	312+45.9	306+95.5	312+38.2	
CURB REMOVAL	-	AREA	250 SY	141 SY	154 SY
C&G REMOVAL	429 LF				
ISLAND REMOVAL	1893 SF				

FOREST PRESERVE DISTRICT OF COOK COUNTY

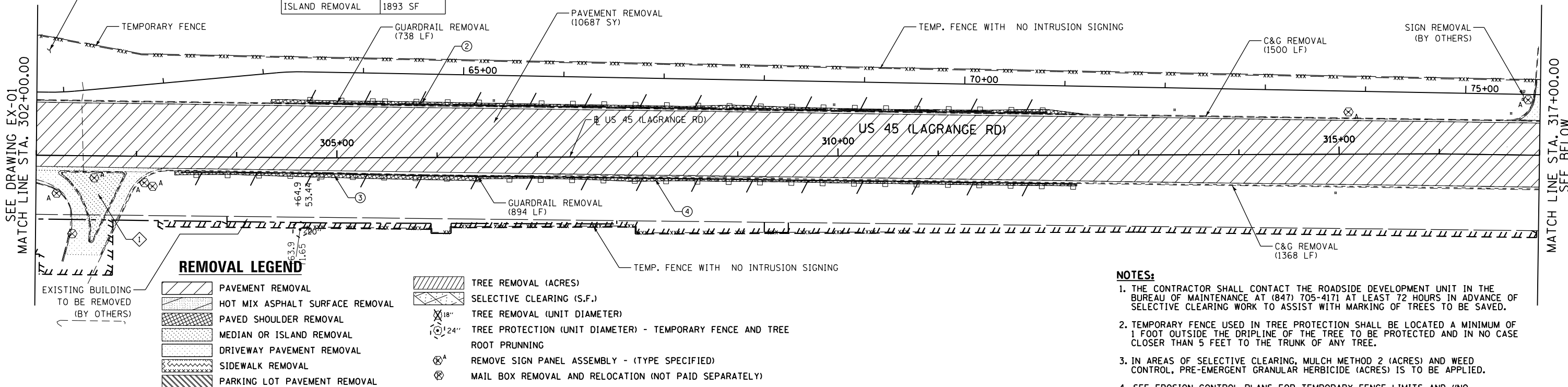

- NOTES:**
1. THE CONTRACTOR SHALL CONTACT THE ROADSIDE DEVELOPMENT UNIT IN THE BUREAU OF MAINTENANCE AT (847) 705-4171 AT LEAST 72 HOURS IN ADVANCE OF SELECTIVE CLEARING WORK TO ASSIST WITH MARKING OF TREES TO BE SAVED.
 2. TEMPORARY FENCE USED IN TREE PROTECTION SHALL BE LOCATED A MINIMUM OF 1 FOOT OUTSIDE THE DRIPLINE OF THE TREE TO BE PROTECTED AND IN NO CASE CLOSER THAN 5 FEET TO THE TRUNK OF ANY TREE.
 3. IN AREAS OF SELECTIVE CLEARING, MULCH METHOD 2 (ACRES) AND WEED CONTROL, PRE-EMERGENT GRANULAR HERBICIDE (ACRES) IS TO BE APPLIED.
 4. SEE EROSION CONTROL PLANS FOR TEMPORARY FENCE LIMITS AND "NO INTRUSION" SIGNING LOCATIONS.

DRIVEWAY PAVEMENT REMOVALS						PAVED SHOULDER REMOVALS		SIDEWALK REMOVALS	
STATION	②	③	④	⑤	⑥	⑤	②	STATION	②
317+05 (LT)	128 SY	320+28 (RT)	322+54 (RT)	329+74 (LT)	331+96 (LT)	328+26.4	324+61.1	327+19.6	
PAVEMENT REMOVAL	128 SY	80 SY	193 SY	98 SY	143 SY	AREA	145 SY	AREA	1356 SF
CURB REMOVAL	-	-	-	-	-				
C&G REMOVAL	108 LF	-	66 LF	-	128 LF				
ISLAND REMOVAL	-	-	-	-	-				

FOREST PRESERVE DISTRICT OF COOK COUNTY

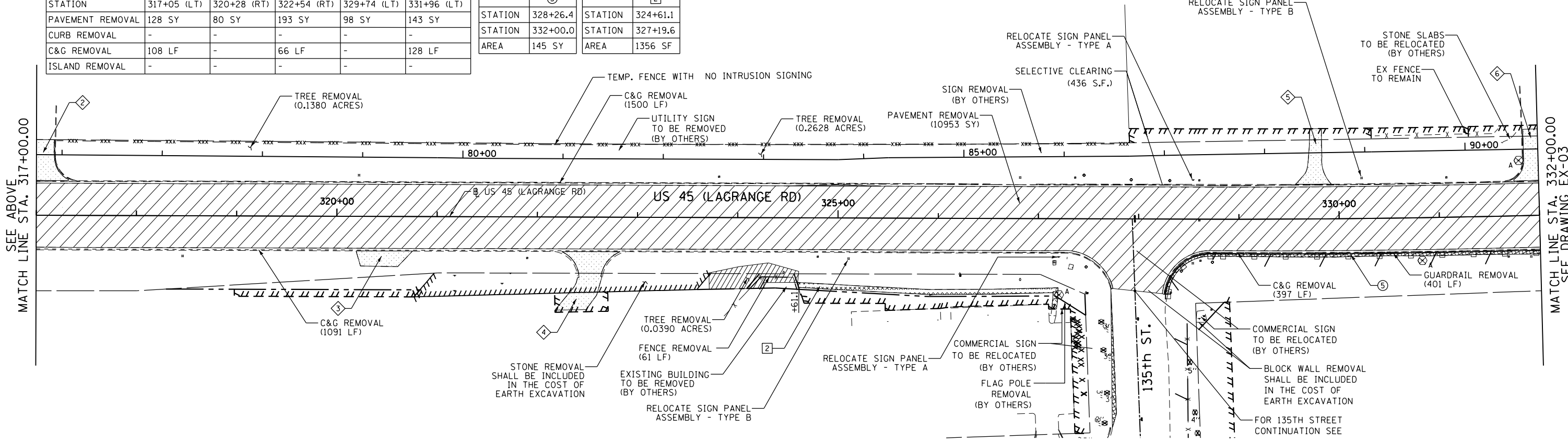

100 S. WACKER DR.
100 S. WACKER DR.
CHICAGO, IL 60606
TEL (312) 939-1000
FAX (312) 939-4998



FILE NAME =	USER NAME = Anthony.Plutz	DESIGNED - BFH	REVISED -
D160M62-SHT-REM02.dgn		DRAWN - BFH	REVISED -
	PLOT SCALE = 100.000000' / in.	CHECKED - MJT	REVISED -
SHT_DOUBLE_PLAN	PLOT DATE = 3/12/2013	DATE - 03/13/13	REVISED -

STATE OF ILLINOIS
DEPARTMENT OF TRANSPORTATION

EXISTING PLAN AND REMOVALS - US 45 (LAGRANGE ROAD)
SCALE: 1"=50' SHEET 2 OF 4 SHEETS STA. 302+00.00 TO STA. 332+00.00

F.A.P. RTE.	SECTION	COUNTY	TOTAL SHEETS	SHEET NO.
330	103R-5	COOK	778	49
EX-02		CONTRACT NO. 60M62		
ILLINOIS FED. AID PROJECT				