



NOTE:
 1. FOR CURVE DATA SEE ALIGNMENT, TIES AND BENCHMARKS DRAWING AT-01 TO AT-05
 2. FOR ROW CALL-OUTS SEE PLAT OF HIGHWAY SHEETS
 3. FOR DRIVEWAY PAVEMENT DETAILS SEE DISTRICT 1 STANDARDS BD-01 AND BD-02.
 4. FOR CURB RAMP FOR SIDEWALKS REFER TO STANDARDS 424001 TO 424031 AND/OR AS DIRECTED BY THE ENGINEER.

LEGEND
 = DETECTABLE WARNINGS SEE STD 424001 TO 424031
 = PAVEMENT WIDENING



PLAN	SURVEYED	DATE
	PLOTTED	
	ALIGNED	
	CHECKED	
	FILED	
	NO.	

PROFILE	SURVEYED	DATE
	PLOTTED	
	GRADES CHECKED	
	STRUCTURE	
	NOTATIS CHKD	
	NO.	

100 S. WACKER DR.
 SUITE 500
 CHICAGO, IL 60606
 TEL (312) 339-4900
 FAX (312) 339-4998

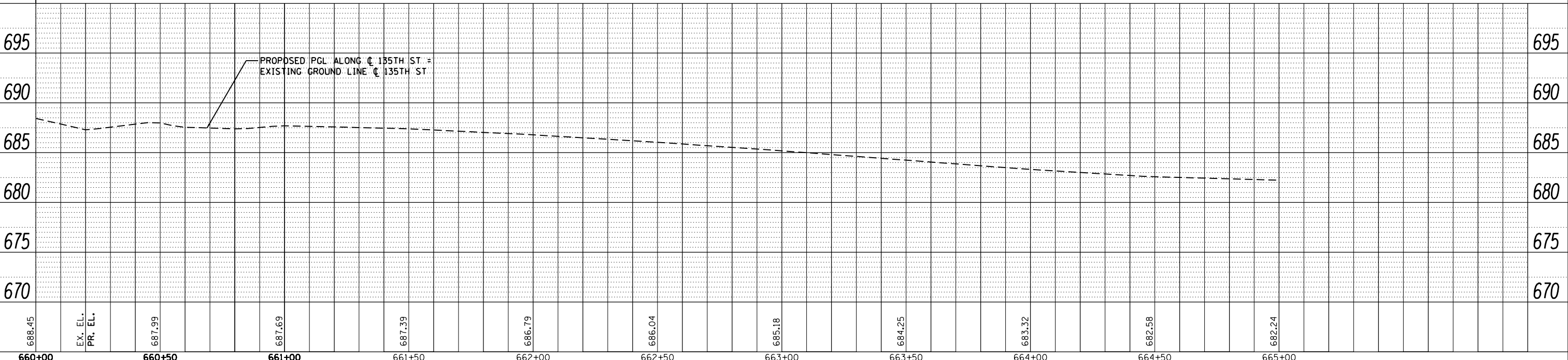
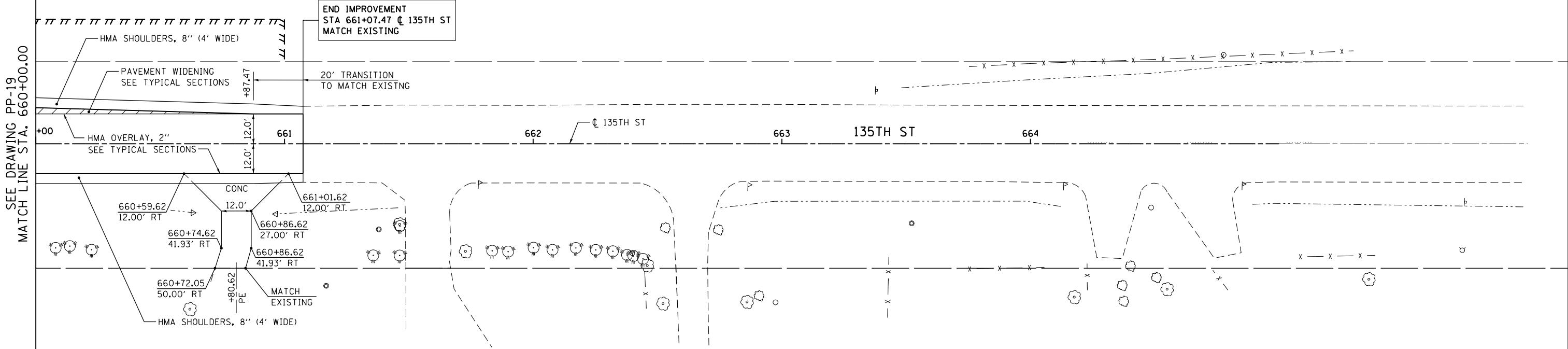
FILE NAME =	USER NAME = Anthony.Plutz	DESIGNED - JTF	REVISED -	STATE OF ILLINOIS DEPARTMENT OF TRANSPORTATION	PROPOSED PLAN AND PROFILE - 135TH STREET	F.A.P. RTE.	SECTION	COUNTY	TOTAL SHEETS	SHEET NO.	
D160M62-SHT-PLNPRF20.dgn		DRAWN - JTF	REVISED -			330	103R-5	COOK	778	74	
		CHECKED - MJT	REVISED -			PP-20		CONTRACT NO. 60M62			
SHT_PLNPRF URBAN		DATE - 03/13/13	REVISED -			SCALE: 1"=20'		SHEET 3 OF 3 SHEETS		STA. 660+00.00 TO STA. END	

ILLINOIS FED. AID PROJECT