

PROFILE	DATE
BY	
REVIEWED	
GRADES CHECKED	
NOTE BOOK	
STRUCTURE NOTATIONS CHKD	
NO.	

100 S. WACKER DR.
SUITE 500
CHICAGO, IL 60606
TEL (312) 939-4000
FAX (312) 939-4098

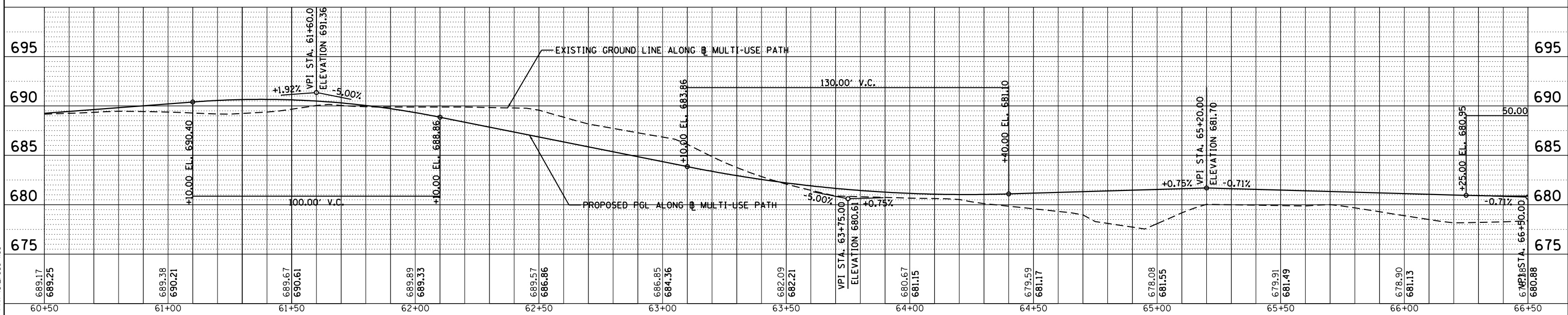
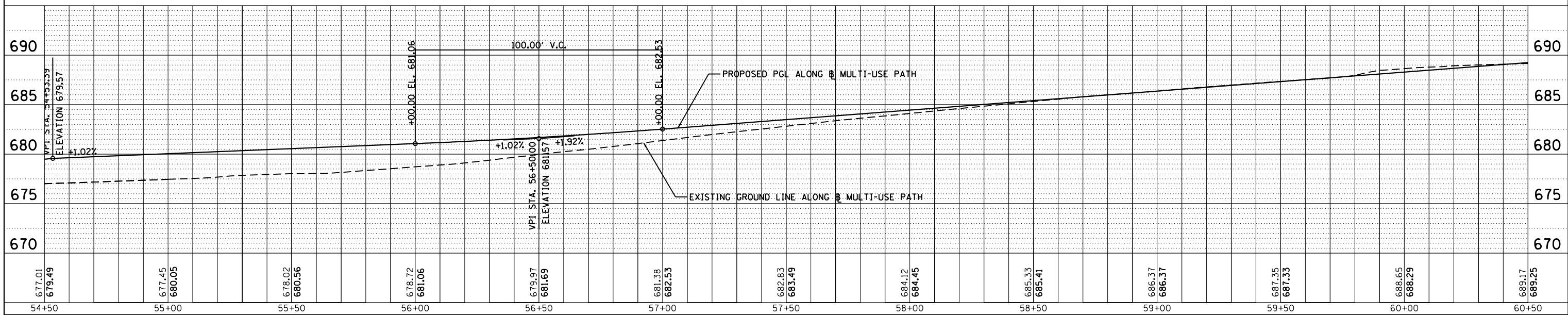
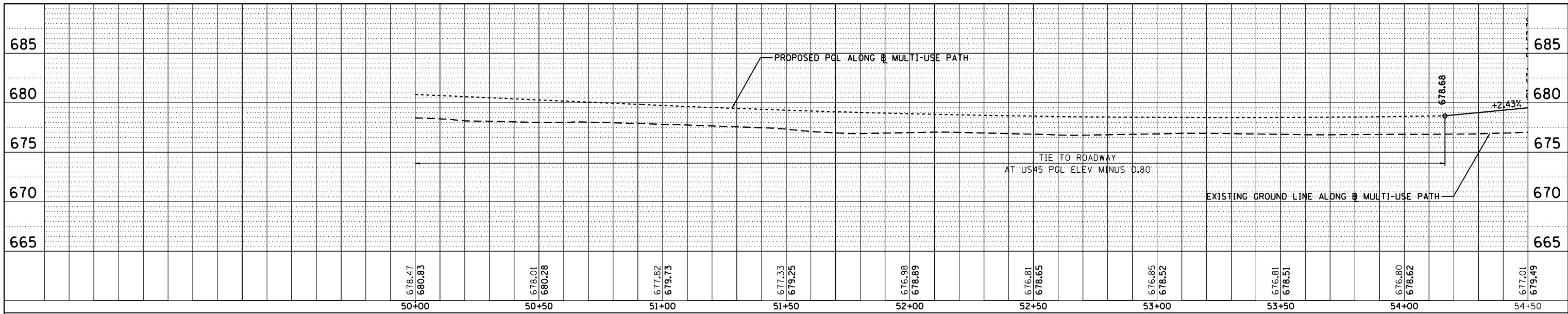

FILE NAME = D160M62-SHT-PROFILE01.dgn
Default

USER NAME = Anthony.Plutz	DESIGNED - JTF	REVISED -
PLOT SCALE = 48.000000' / in.	DRAWN - JTF	REVISED -
PLOT DATE = 3/12/2013	CHECKED - MJT	REVISED -
	DATE - 03/13/13	REVISED -

STATE OF ILLINOIS
DEPARTMENT OF TRANSPORTATION

PROPOSED PATH PROFILE - US 45 (LAGRANGE ROAD)

SCALE: 1"=20' SHEET 1 OF 6 SHEETS STA. BEGIN TO STA. 66+50

F.A.P. RTE. 330	SECTION 103R-5	COUNTY COOK	TOTAL SHEETS 778	SHEET NO. 80
FR-01		CONTRACT NO. 60M62		
ILLINOIS FED. AID PROJECT				