

**LEGEND**

- BARRICADE WITH EDGE LINE
- CONE, DRUM OR BARRICADE
- BARRICADE TYPE III
- PANELS I
- TEMPORARY CONCRETE BARRIER
- IMPACT ATTENUATOR, TEMPORARY
- TEMPORARY PAVEMENT
- PROPOSED PAVEMENT
- PROPOSED PAVEMENT (OFF-PEAK LANE CLOSURE)
- TEMPORARY PAVEMENT WEDGE

•• TEMPORARY PAVEMENT WEDGE (3% MAX SLOPE) BETWEEN PROPOSED AND EXISTING PAVEMENT ELEVATIONS (26 TONS) (PLACED IN SEGMENTS DURING STAGE 1A, 1B, 1C, & 1D)

**CARL SANDBURG HIGH SCHOOL BUILDING**

**WORK ZONE**  
**SPEED LIMIT 35**  
PHOTO ENFORCED  
\$ 375 FINE MINIMUM



NOTE: CONTRACTOR SHALL MAINTAIN TWO LANES OF TRAFFIC ON ACCESS ROAD AT ALL TIMES DURING CONSTRUCTION. SEE COMMITMENT NOTE ON SHEET GN-01.

SEE DRAWING MT-06  
MATCH LINE STA. 332+00.00

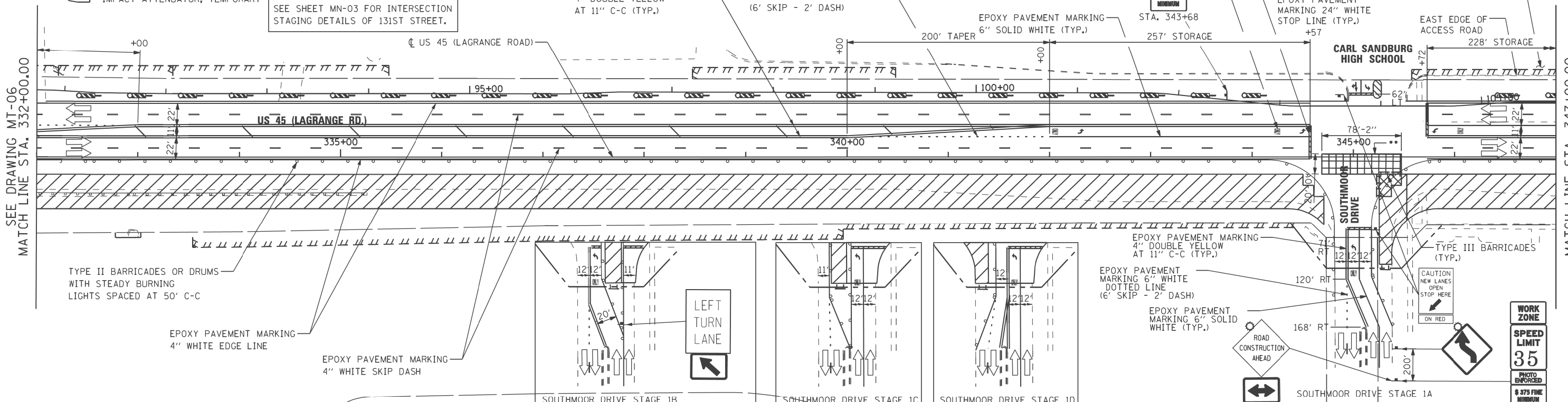

MATCH LINE STA. 347+00.00  
SEE BELOW

SEE ABOVE  
MATCH LINE STA. 347+00.00

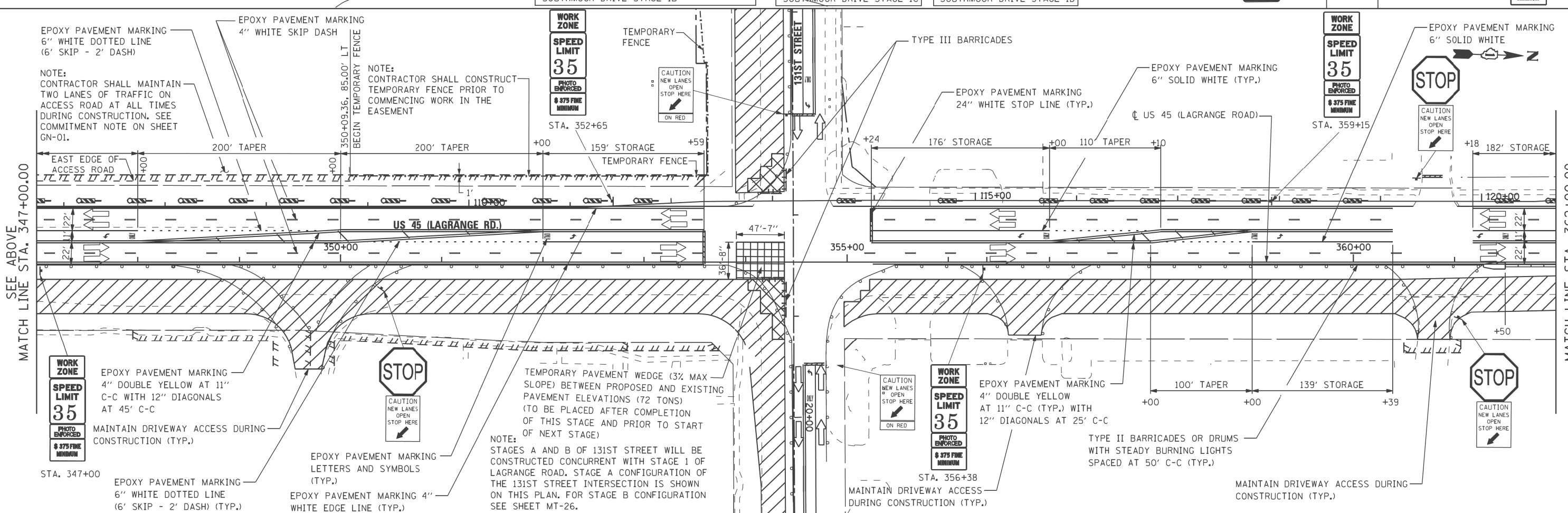

MATCH LINE STA. 362+00.00  
SEE DRAWING MT-08

URS  
100 S. WACKER DR.  
SUITE 600  
CHICAGO, IL 60606  
TEL (312) 935-1000  
FAX (312) 935-4998

FILE NAME =	USER NAME = haddell	DESIGNED - TRK	REVISED -
P:\P-12-9\50-100T-URS-US 45 (Lagrange Rd)\North Segment_60M62\Design\Sh1\160M62-SH1\DRAWING\07.dgn		TRK	REVISED -
PLOT SCALE = #SCALE#		CHECKED - MJT	REVISED -
SHT_DOUBLE PLAN	PLOT DATE = 2/1/2013	DATE - 03/13/13	REVISED -

**STATE OF ILLINOIS  
DEPARTMENT OF TRANSPORTATION**

**MAINTENANCE OF TRAFFIC STAGE 1 PLAN  
US 45 (LAGRANGE ROAD)**

SCALE: 1"=50' SHEET STA. 332+00.00 TO STA. 362+00.00

F.A.P. RTE.	SECTION	COUNTY	TOTAL SHEETS	SHEET NO.
330	103R-5	COOK	778	102
MT-07			CONTRACT NO.	
ILLINOIS FED. AID PROJECT				