

NOTE: SEE SHEET ER-01 FOR LEGEND AND NOTES.

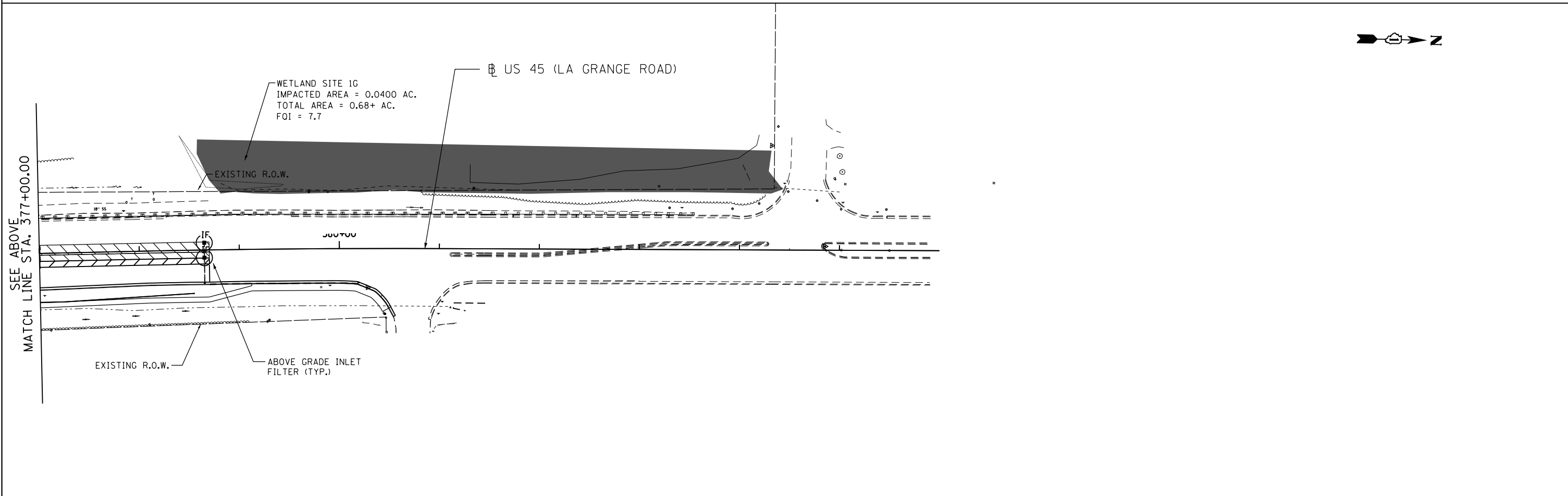

APEX
 CONSULTING ENGINEERS, LLC
 111 E. Wacker Drive, Suite 520
 Chicago, IL 60601

FILE NAME = D160M62-SHT-ER0513.Stage 2.dgn	USER NAME = Frank.Stallone	DESIGNED - LN	REVISED -	STATE OF ILLINOIS DEPARTMENT OF TRANSPORTATION	EROSION AND SEDIMENT CONTROL PLAN US 45 (LAGRANGE ROAD) NORTH CONTRACT - STAGE 2	F.A.P. RTE. 330	SECTION 103R-5	COUNTY COOK	TOTAL SHEETS 778	SHEET NO. 136
PLOT SCALE = 100.000000' / 1" =	CHECKED - WI	REVISIED -	ER-13			CONTRACT NO. 60M62				
PLOT DATE = 3/14/2013	DATE - 02/08/2013	REVISIED -	ILLINOIS FED. AID PROJECT							
SCALE: 1"=50'		SHEET NO. 4 OF 4 SHEETS				STA. 362+00.00 TO STA. END				

D160M62-SHT-ER0513.Stage 2.dgn 3/14/2013 6:17:05 PM