

STORM SEWER REMOVAL 12"
 STA. 288+39.0 TO 290+00.0 - 160' (TBF=32.0 CU YD)
 STA. 288+72.4 TO 290+00.0 - 127' (TBF=20.1 CU YD)
 STA. 288+72.6 TO 290+00.0 - 127' (TBF=47.1 CU YD)

REMOVING INLETS
 288+72.4, 49.2 LT
 288+72.6, 55.2 RT

STORM SEWER REMOVAL 42"
 STA. 289+60.0 TO 290+00.0 - 41' (TBF=73.8 CU YD)

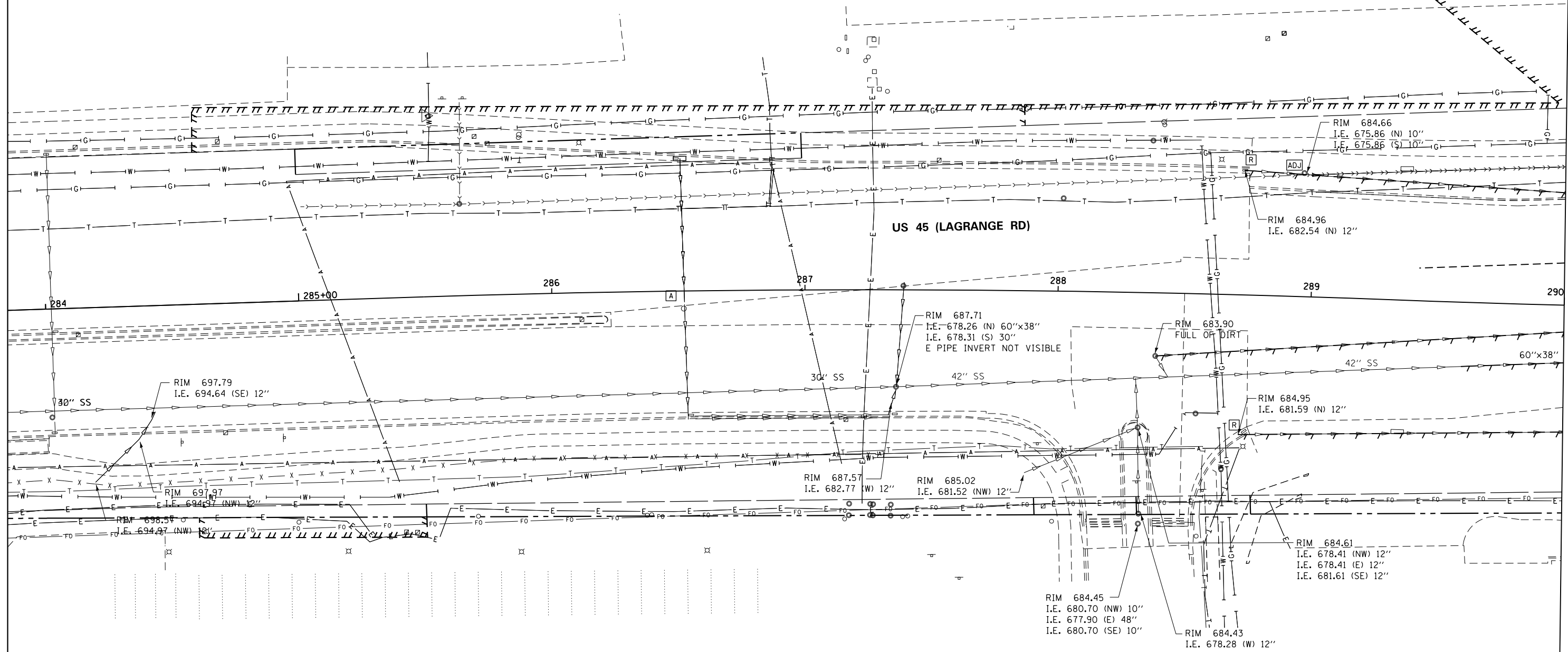

MATCH LINE STA. 290+00.00
SEE DRAWING DU-02

NOTE:
 1. SEE DRAWING DN-01 FOR DRAINAGE LEGEND AND NOTES.
 2. SEE DRAWINGS DS-01 THROUGH DS-07 FOR STRUCTURE AND PIPE INFORMATION

NOTE:
 1. END SECTIONS AND HEADWALLS TO BE REMOVED SHALL BE INCIDENTAL TO THE COST OF STORM SEWER REMOVAL

100 S. WACKER DR.
 SUITE 600
 CHICAGO, IL 60606
 TEL (312) 939-1000
 FAX (312) 939-4998



FILE NAME = D160M62-SHT-DRAINE.X01.dgn	USER NAME = Anthony.Plutz	DESIGNED - EJD	REVISED -
SHT_PLAN	PLOT SCALE = 48.000000' / in.	DRAWN - EJD	REVISED -
	PLOT DATE = 3/13/2013	CHECKED - JWM	REVISED -
		DATE - 03/13/13	REVISED -

STATE OF ILLINOIS
 DEPARTMENT OF TRANSPORTATION

EXISTING DRAINAGE PLAN - US 45 (LAGRANGE ROAD)

SCALE: 1"=20' SHEET 1 OF 17 SHEETS STA. BEGIN TO STA. 290+00.00

F.A.P. R.E.	SECTION	COUNTY	TOTAL SHEETS	SHEET NO.
330	103R-5	COOK	778	156
DU-01		CONTRACT NO. 60M62		
ILLINOIS FED. AID PROJECT				