

SEE DRAWING DU-08
MATCH LINE STA. 332+00.00

MATCH LINE STA. 338+00.00
SEE DRAWING DU-10

STORM SEWER REMOVAL 12"
STA. 332+10.8 TO 332+12.1 - 18' (TBF=4.2 CU YD)
STA. 332+52.1 TO 332+65.5 - 10' (TBF=7.7 CU YD)
STA. 334+02.5 TO 334+00.6 - 61' (TBF=9.7 CU YD)
STA. 334+06.3 TO 334+04.0 - 17' (TBF=2.7 CU YD)
STA. 337+34.0 TO 337+32.0 - 61' (TBF=14.3 CU YD)
STA. 337+32.0 TO 337+30.8 - 3' (TBF=2.3 CU YD)
STA. 337+30.8 TO 335+99.2 - 217' (TBF=196.7 CU YD)
STA. 334+26.0 TO 334+76.9 - 51' (TBF=12.0 CU YD)

STORM SEWER REMOVAL 15"
STA. 335+99.2 TO 332+88.2 - 307' (TBF=543.3 CU YD)
STA. 332+00.0 TO 332+12.1 - 12' (TBF=5.7 CU YD)

STORM SEWER REMOVAL 18"
STA. 332+62.0 TO 332+88.2 - 26' (TBF=42.0 CU YD)

STORM SEWER REMOVAL 24"
STA. 332+96.0 TO 332+95.4 - 143' (TBF=236.1 CU YD)

REMOVING INLETS
334+00.6, 33.9 LT

REMOVING CATCH BASINS
332+10.8, 42.7 LT
332+52.1, 32.9 RT
334+02.5, 33.3 LT
337+34.0, 32.9 LT
337+32.0, 32.8 RT

REMOVING MANHOLES
332+88.2, 41.3 RT
334+06.3, 28.1 RT
335+99.2, 41.1 RT
337+30.8, 40.6 RT

END SECTIONS TO BE REMOVED
332+96.5, 67.5 LT
332+95.4, 72.8 RT
334+26.0, 67.9 LT
334+79.9, 65.8 LT

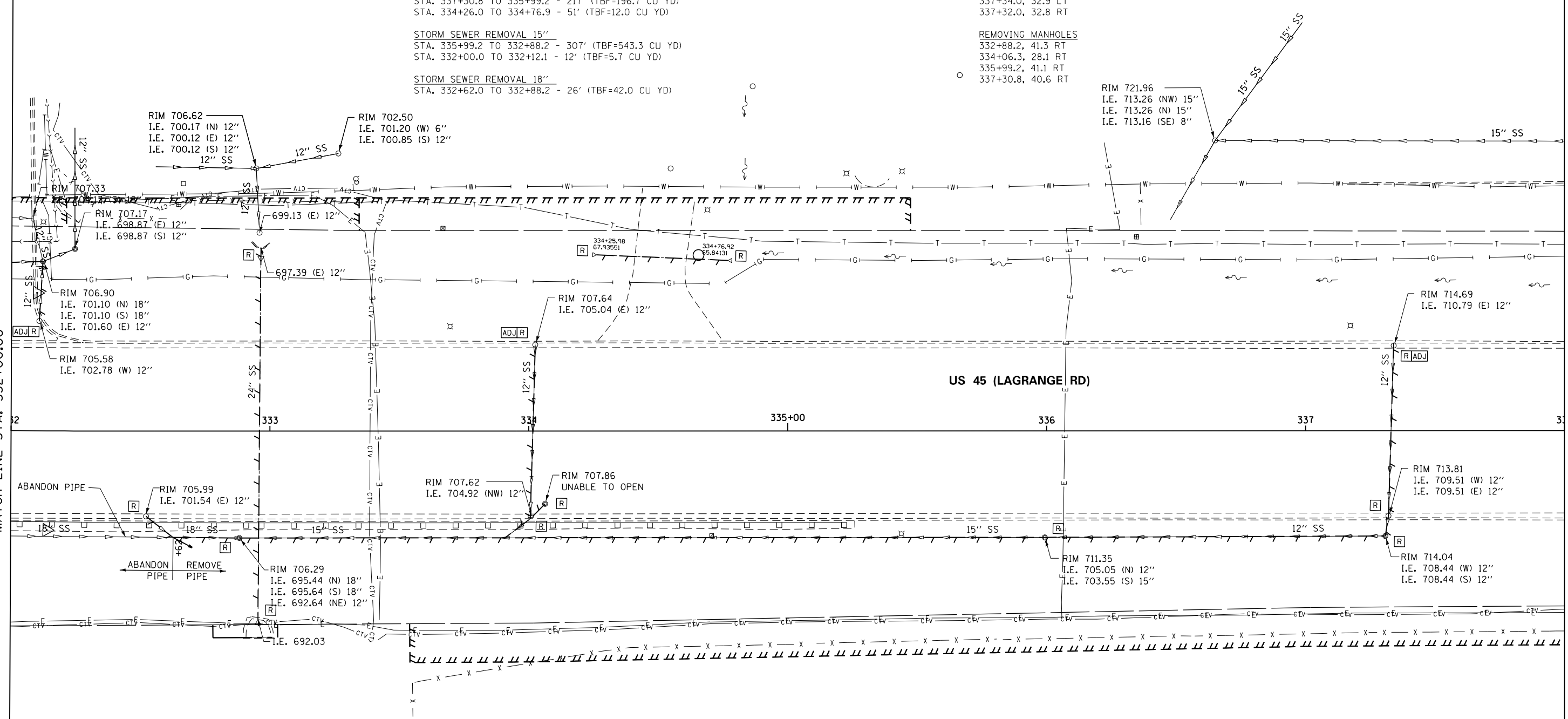

US 45 (LAGRANGE RD)

NOTE:
1. SEE DRAWING DN-01 FOR DRAINAGE LEGEND AND NOTES.
2. SEE DRAWINGS DS-01 THROUGH DS-07 FOR STRUCTURE AND PIPE INFORMATION

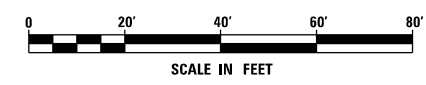

FILE NAME = D160M62-SHT-DRAINE.X09.dgn	USER NAME = Anthony.Plutz	DESIGNED - EJD	REVISED -	STATE OF ILLINOIS DEPARTMENT OF TRANSPORTATION	EXISTING DRAINAGE PLAN - US 45 (LAGRANGE ROAD)			F.A.P. RTE. 330	SECTION 103R-5	COUNTY COOK	TOTAL SHEETS 778	SHEET NO. 164
PLOT SCALE = 48.000000' / in.	CHECKED - JWM	REVISOR -	REVISOR -		SCALE: 1"=20'	SHEET 9 OF 17 SHEETS	STA. 332+00.00 TO STA. 338+00.00	DU-09		CONTRACT NO. 60M62		
PLOT DATE = 3/13/2013	DATE - 03/13/13	REVISOR -	REVISOR -		ILLINOIS FED. AID PROJECT							
SHT.PLAN												