

STORM SEWER REMOVAL 12"
 STA. 348+00.5 TO 348+01.8 - 71' (TBF=20.8 CU YD)
 STA. 348+84.4 TO 348+84.4 - 3' (TBF=0.5 CU YD)

REMOVING INLETS
 348+00.5, 32.9 LT

END SECTIONS TO BE REMOVED
 344+54.2, 58.9 LT

STORM SEWER REMOVAL 24"
 STA. 344+54.2 TO 344+54.3 - 136' (TBF=53.7 CU YD)
 STA. 348+01.8 TO 350+00.0 - 196' (TBF=184.4 CU YD)

REMOVING CATCH BASINS

344+50.4, 33.0 LT
 348+08.7, 44.8 RT
 348+84.6, 54.2 RT
 348+84.4, 53.1 RT

REMOVING MANHOLES

344+54.0, 33.0 RT
 344+58.2, 72.1' RT
 348+01.8, 41.4 RT

CARL SANDBURG
 HIGH SCHOOL

US 45 (LAGRANGE RD)

SOUTHMOOR DRIVE

SEE DRAWING DU-10
 MATCH LINE STA. 344+00.00

MATCH LINE STA. 350+00.00
 SEE DRAWING DU-12

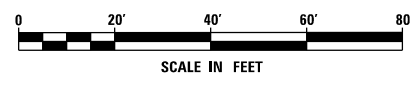
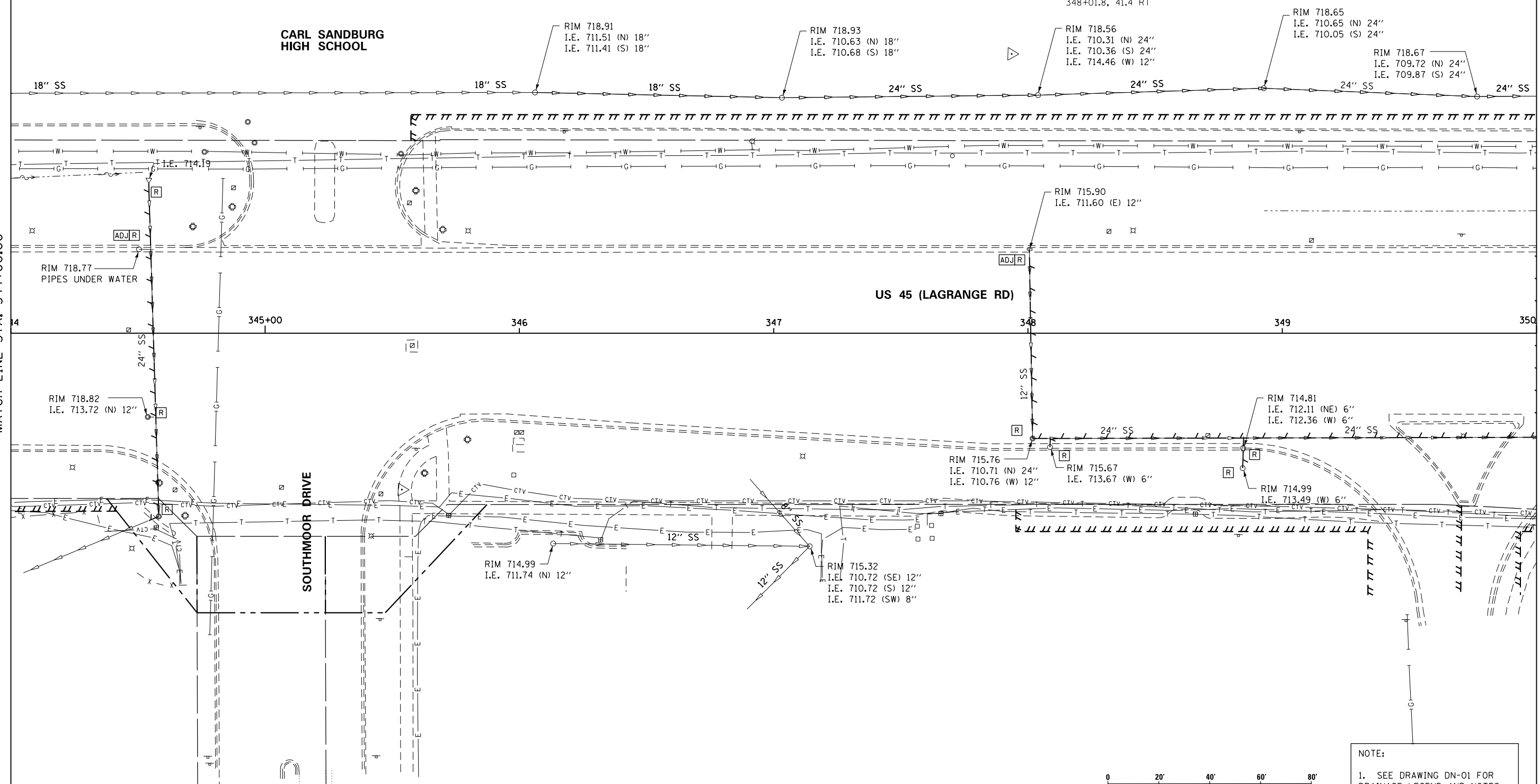

NOTE:
 1. SEE DRAWING DN-01 FOR DRAINAGE LEGEND AND NOTES.
 2. SEE DRAWINGS DS-01 THROUGH DS-07 FOR STRUCTURE AND PIPE INFORMATION

URS
 100 S. WACKER DR.
 SUITE 600
 CHICAGO, IL 60606
 TEL (312) 939-1000
 FAX (312) 939-4998

FILE NAME = D:\160M62-SHT-DRAINE\X11.dgn
 SHT_PLAN

USER NAME = Anthony.Plutz	DESIGNED - EJD	REVISED -
PLOT SCALE = 48.000000' / in.	DRAWN - EJD	REVISED -
PLOT DATE = 3/13/2013	CHECKED - JWM	REVISED -
	DATE - 03/13/13	REVISED -

STATE OF ILLINOIS
 DEPARTMENT OF TRANSPORTATION

EXISTING DRAINAGE PLAN - US 45 (LAGRANGE ROAD)

SCALE: 1"=20' SHEET 11 OF 17 SHEETS STA. 344+00.00 TO STA. 350+00.00

F.A.P. R.E.	SECTION	COUNTY	TOTAL SHEETS	SHEET NO.
330	103R-5	COOK	778	166
DU-11		CONTRACT NO. 60M62		
ILLINOIS FED. AID PROJECT				