

STORM SEWER REMOVAL - 12"  
 STA. 26+49.6 TO 26+55.1 - 24' (TBF=4.3 CU YD)

REMOVING CATCH BASINS  
 26+55.1, 12.8 LT  
 26+55.1, 13.9 RT

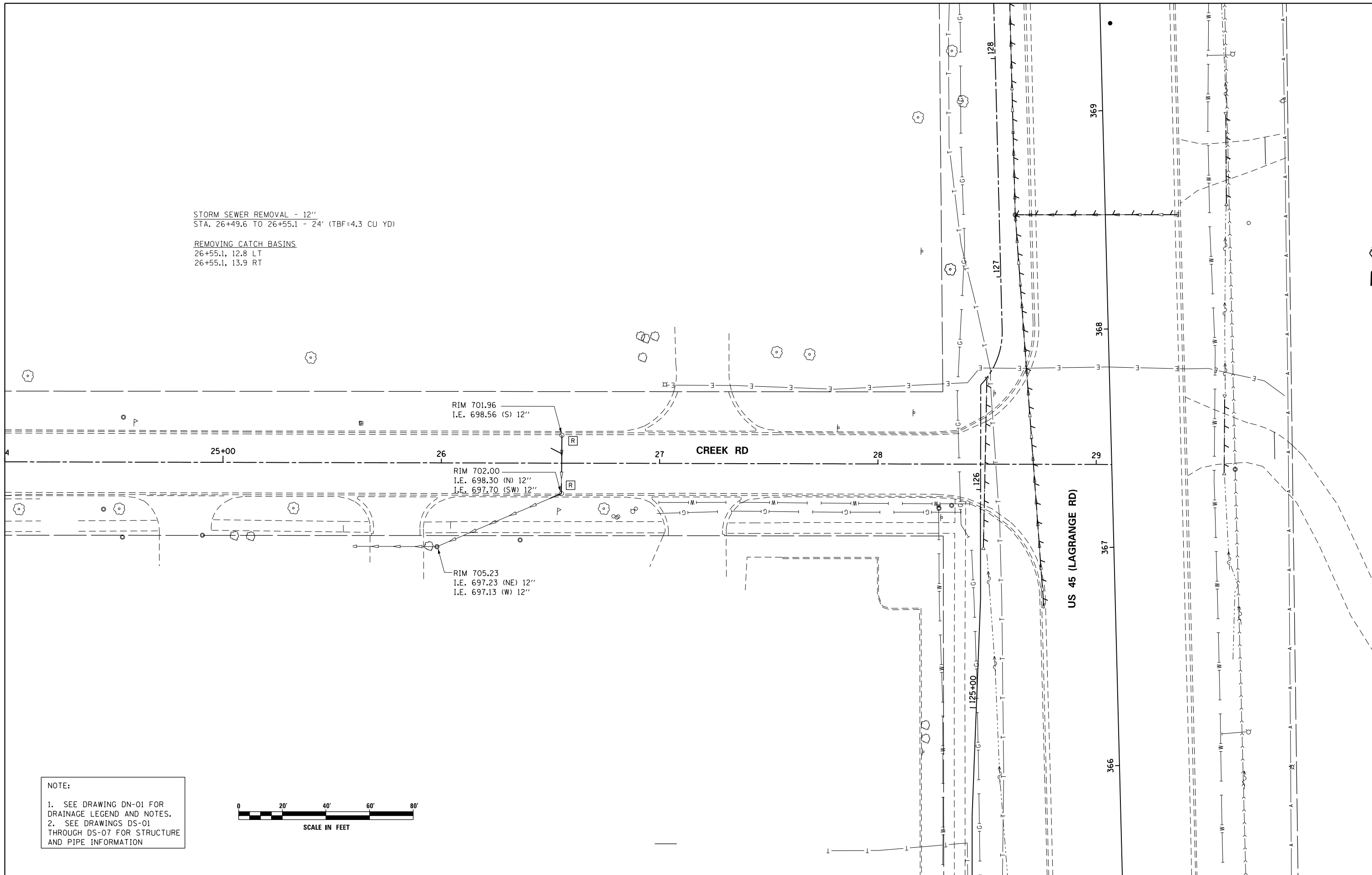

NOTE:  
 1. SEE DRAWING DN-01 FOR DRAINAGE LEGEND AND NOTES.  
 2. SEE DRAWINGS DS-01 THROUGH DS-07 FOR STRUCTURE AND PIPE INFORMATION

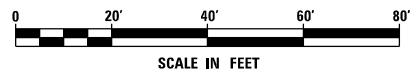

100 S. WACKER DR.  
 SUITE 600  
 CHICAGO, IL 60606  
 TEL (312) 939-1000  
 FAX (312) 939-4998

**URS**

FILE NAME = D160M62-SHT-DRAINEX24.dgn  
 SHT.PLAN

USER NAME = Anthony.Plutz  
 PLOT SCALE = 48.000000' / in.  
 PLOT DATE = 3/13/2013

DESIGNED - EJD  
 DRAWN - EJD  
 CHECKED - JWM  
 DATE - 03/13/13

REVISED -  
 REVISED -  
 REVISED -  
 REVISED -

STATE OF ILLINOIS  
 DEPARTMENT OF TRANSPORTATION

EXISTING DRAINAGE PLAN - CREEK RD

SCALE: 1"=20' SHEET 1 OF 1 SHEETS STA. 25+10.00 TO STA. 29+07.12

F.A.P. RTE.	SECTION	COUNTY	TOTAL SHEETS	SHEET NO.
330	103R-5	COOK	778	179
<b>DU-24</b>			<b>CONTRACT NO. 60M62</b>	
ILLINOIS FED. AID PROJECT				