

SEE DRAWING FIBOP-03
MATCH LINE STA. 362+00.00

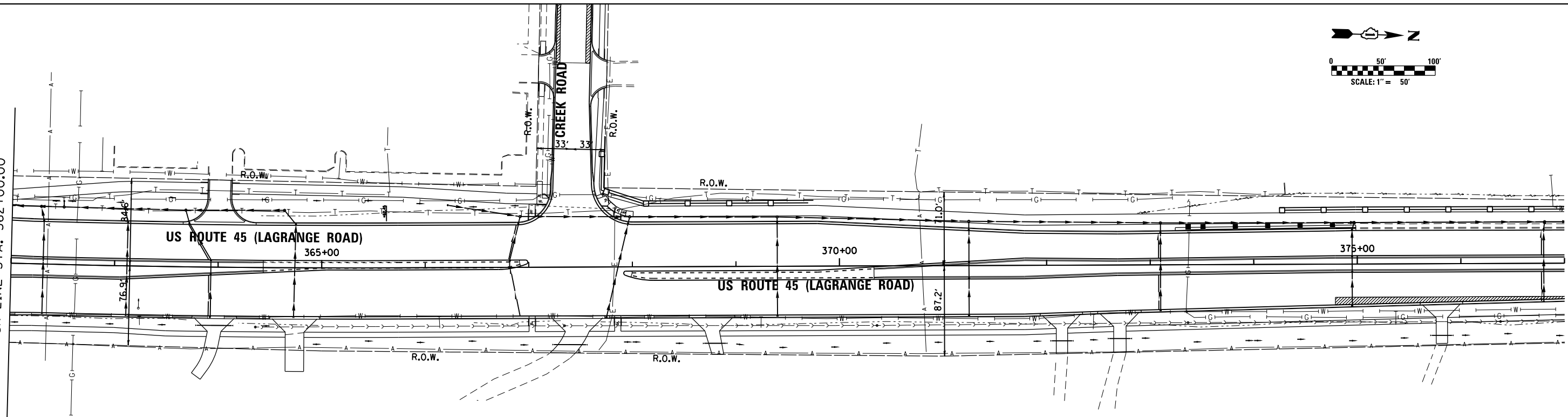

RESTORATION OF WORK AREA, RESTORATION OF THE TRAFFIC SIGNAL WORK AREA SHALL BE INCIDENTAL TO THE RELATED PAY ITEM SUCH AS FOUNDATION, CONDUIT, HANDHOLE, TRENCH AND BACKFILL, ETC., AND NO EXTRA COMPENSATION SHALL BE ALLOWED. ALL ROADWAY SURFACES SUCH AS SHOULDERS, MEDIANS, SIDEWALKS, PAVEMENT, ETC. SHALL BE REPLACED IN KIND. ALL DAMAGE TO MOWED LAWNS SHALL BE REPLACED WITH AN APPROVED SOD, AND ALL DAMAGE TO UNMOWED FIELDS SHALL BE SEEDING IN ACCORDANCE WITH STANDARD SPECIFICATIONS 252 AND 250 RESPECTIVELY.

NOTE:
GALVANIZED STEEL CONDUIT IDENTIFIED AS IN TRENCH (T) OR PUSHED (P) IS SHOWN FOR INFORMATION ONLY. ALL UNDERGROUND CONDUIT SHALL BE PAID FOR AT THE CONTRACT UNIT PRICE PER FOOT FOR UNDERGROUND CONDUIT, OF THE TYPE AND SIZE SPECIFIED, REGARDLESS OF THE METHOD OF INSTALLATION.

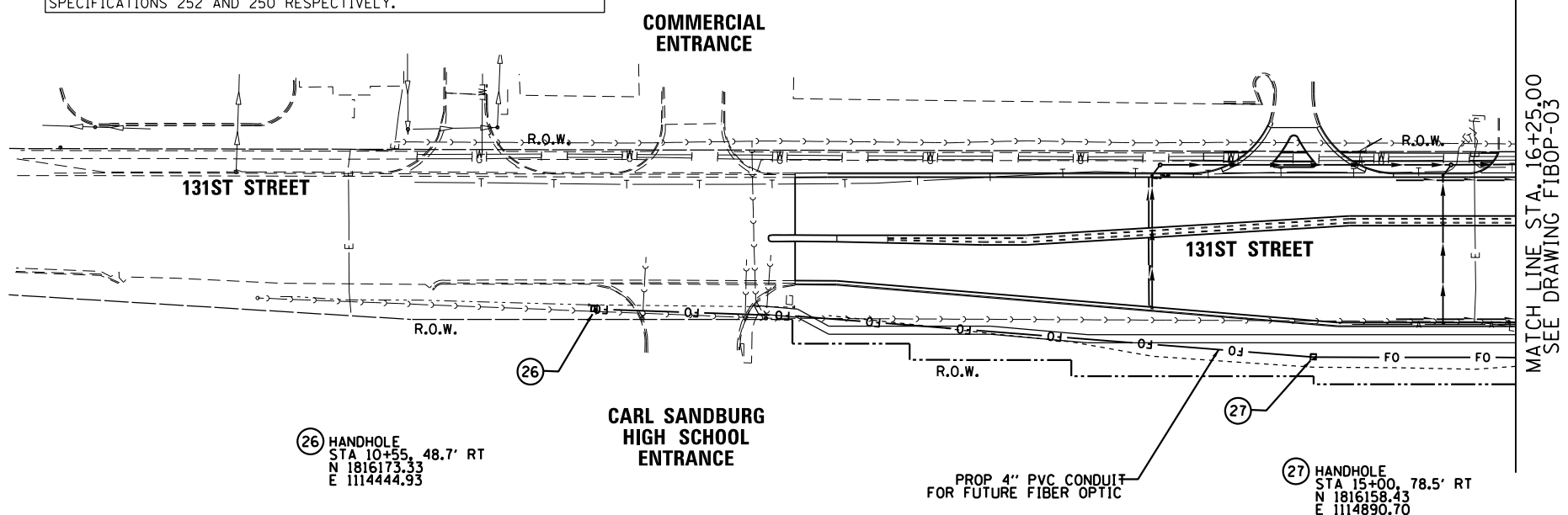
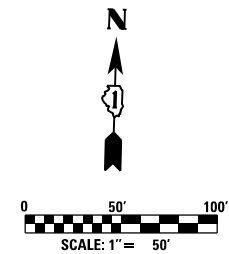

26 HANDHOLE
STA 10+55, 48.7' RT
N 1816173.33
E 1114444.93

27 HANDHOLE
STA 15+00, 78.5' RT
N 1816158.43
E 1114890.70

URS
100 S. WACKER DR.
SUITE 600
CHICAGO, IL 60606
TEL (312) 939-1000
FAX (312) 939-4998

FILE NAME =	USER NAME = Frank.Stallone
D160M62-SHT-FIBOP04.dgn	
SHT_DOUBLE PLAN	

DESIGNED - BA	REVISD -
DRAWN - BA	REVISD -
CHECKED - MJT	REVISD -
DATE - 03/13/13	REVISD -

PLOT SCALE = 100.000000' / in.	
PLOT DATE = 3/15/2013	

**STATE OF ILLINOIS
DEPARTMENT OF TRANSPORTATION**

**PROPOSED FIBER OPTIC CONDUIT
US 45 (LAGRANGE RD)
FROM 135TH STREET TO CREEK ROAD**

SCALE: 1"=50' SHEET 4 OF 5 SHEETS STA. 362+00.00 TO STA. END

F.A.P. RTE.	SECTION	COUNTY	TOTAL SHEETS	SHEET NO.
330	103R-5	COOK	778	241
FIBOP-04			CONTRACT NO. 60M62	
ILLINOIS FED. AID PROJECT				