

RESTORATION OF WORK AREA, RESTORATION OF THE TRAFFIC SIGNAL WORK AREA SHALL BE INCIDENTAL TO THE RELATED PAY ITEM SUCH AS FOUNDATION, CONDUIT, HANDHOLE, TRENCH AND BACKFILL, ETC., AND NO EXTRA COMPENSATION SHALL BE ALLOWED. ALL ROADWAY SURFACES SUCH AS SHOULDERS, MEDIANS, SIDEWALKS, PAVEMENT, ETC. SHALL BE REPLACED IN KIND. ALL DAMAGE TO MOWED LAWNS SHALL BE REPLACED WITH AN APPROVED SOD, AND ALL DAMAGE TO UNMOWED FIELDS SHALL BE SEEDED IN ACCORDANCE WITH STANDARD SPECIFICATIONS 252 AND 250 RESPECTIVELY.

NOTE:
THE TRAFFIC SIGNAL CONTROLLER EQUIPMENT FOR THIS PROJECT SHALL BE "EAGLE" TO MATCH THE EXISTING ADJACENT SYSTEM.

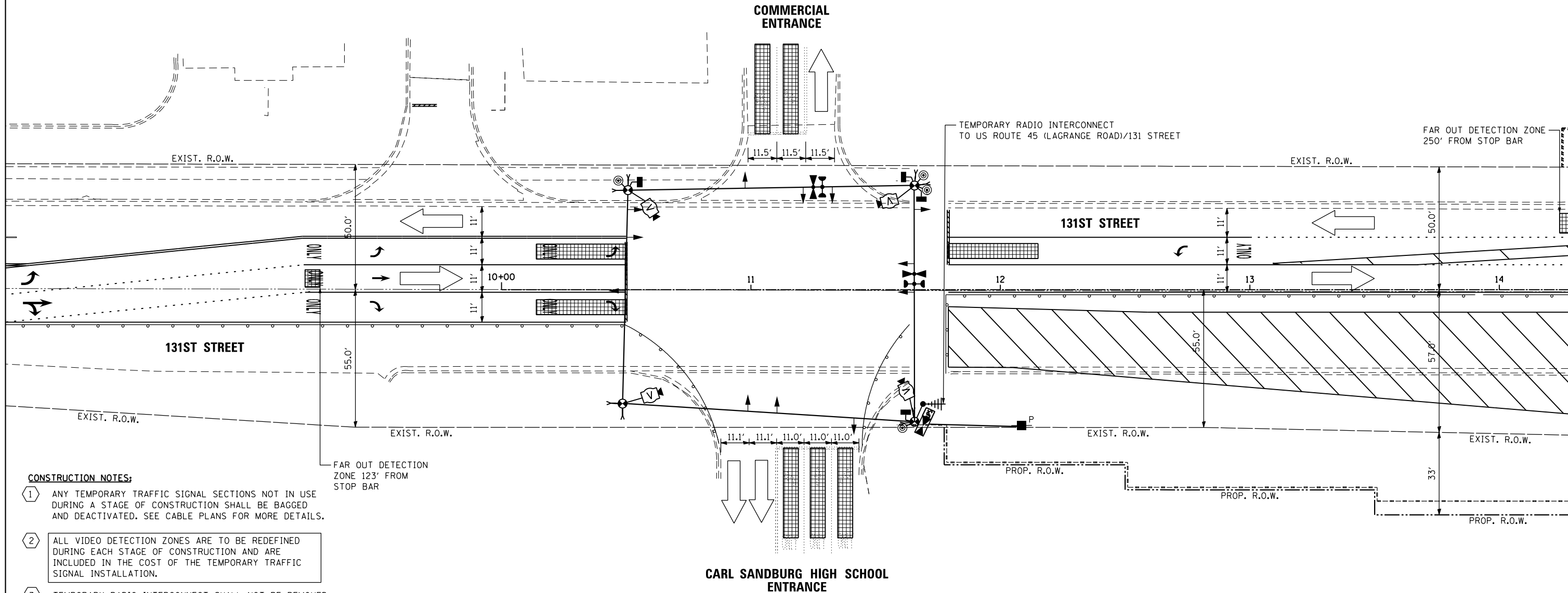
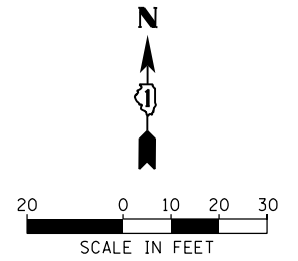

CONSTRUCTION NOTES:

- 1 ANY TEMPORARY TRAFFIC SIGNAL SECTIONS NOT IN USE DURING A STAGE OF CONSTRUCTION SHALL BE BAGGED AND DEACTIVATED. SEE CABLE PLANS FOR MORE DETAILS.
- 2 ALL VIDEO DETECTION ZONES ARE TO BE REDEFINED DURING EACH STAGE OF CONSTRUCTION AND ARE INCLUDED IN THE COST OF THE TEMPORARY TRAFFIC SIGNAL INSTALLATION.
- 3 TEMPORARY RADIO INTERCONNECT SHALL NOT BE REMOVED UNTIL FIBER INTERCONNECT TO US ROUTE 45 (LAGRANGE ROAD)/ 131 STREET IS INSTALLED AND OPERATIONAL.
- 4 IF THE EXISTING TRAFFIC SIGNAL HEADS CONFLICT WITH THE PROPOSED TEMPORARY TRAFFIC SIGNAL INSTALLATION, THE HEADS MAY NEED TO BE REMOVED DURING CONSTRUCTION AFTER THE TEMPORARY TRAFFIC SIGNALS ARE OPERATIONAL, AND RE-INSTALLED BEFORE THE TEMPORARY TRAFFIC SIGNALS ARE REMOVED. THE IDOT TRAFFIC SIGNAL AREA ENGINEER WILL NEED TO APPROVE THIS IN THE FIELD. THIS WORK IS INCLUDED IN THE PAY ITEM "TEMPORARY TRAFFIC SIGNAL INSTALLATION".

100 S. WACKER DR.
 10TH FLOOR
 CHICAGO, IL 60606
 TEL (312) 939-1000
 FAX (312) 939-4998
URS

FILE NAME = D160M62-SHT-TD35.dgn	USER NAME = Anthony.Plutz	DESIGNED - MRF	REVISED -
		DRAWN - MRF	REVISED -
		CHECKED - MJL	REVISED -
SHT.PLAN	PLOT DATE = 3/13/2013	DATE - 03/13/13	REVISED -

**STATE OF ILLINOIS
DEPARTMENT OF TRANSPORTATION**

**TEMPORARY TRAFFIC SIGNAL INSTALLATION - STAGE 1A
131ST STREET AND CARL SANDBURG HIGH SCHOOL ENTRANCE /
COMMERCIAL ENTRANCE**

SCALE: 1"=20' SHEET 2 OF 4 SHEETS STA. TO STA.

F.A.P. RTE. 330	SECTION 103R-5	COUNTY COOK	TOTAL SHEETS 778	SHEET NO. 306
TD-35			CONTRACT NO. 60M62	
ILLINOIS FED. AID PROJECT				