

NOTES:

1. SEE DRAWING E-1 FOR ELECTRICAL SYMBOL LIST AND ABBREVIATIONS. SEE DRAWING E-2 FOR ELECTRICAL GENERAL NOTES.
2. CONTRACTOR MUST COORDINATE THE REMOVAL AND REINSTALLATION OF LIGHT POLE WITH THE PROPOSED RECONSTRUCTION OF CREEK ROAD AND WITH THE OWNER. SEE MAINTENANCE OF TRAFFIC DRAWINGS FOR LaGRANGE ROAD CONSTRUCTION STAGE 3 AND CREEK ROAD STAGING PLANS. CONTRACTOR TO DISCONNECT POWER SOURCE AT NEXT LIGHT POLE WEST OF POLE TO BE RELOCATED. THE CONTRACTOR MUST CONFIRM THE DIAMETER OF EXISTING BOLT CIRCLE FOR POLE TO BE RELOCATED PRIOR TO REMOVAL OF EXISTING POLE AND CONCRETE FOUNDATION. CONTRACTOR TO REINSTALL EXISTING POLE ON PROPOSED CONCRETE FOUNDATION, AND RECONNECT WIRING TO NEXT POLE WEST OF RELOCATED POLE. SEE IDOT STANDARD DRAWING E-45 FOR PROPOSED LIGHTING UNIT FOUNDATION DETAILS. THIS WORK SHALL BE PAID FOR UNDER THE "REMOVE AND RELOCATE EXISTING LIGHT STANDARD", THE "REMOVAL OF POLE FOUNDATION", AND THE "LIGHT POLE FOUNDATION, 24" DIAMETER" PAY ITEMS. SEPARATE PAYMENT WILL NOT BE MADE.

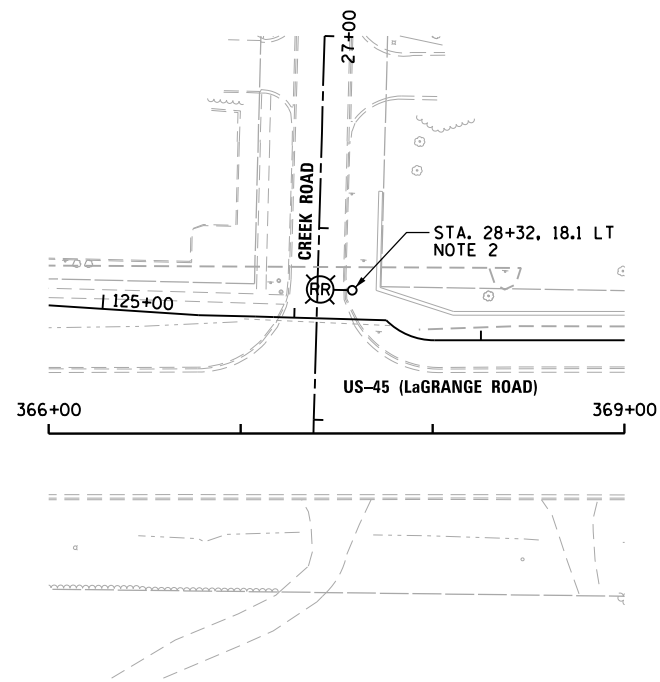

CREEK ROAD ELECTRICAL DEMOLITION PLAN
SCALE: 1" = 50'-0"

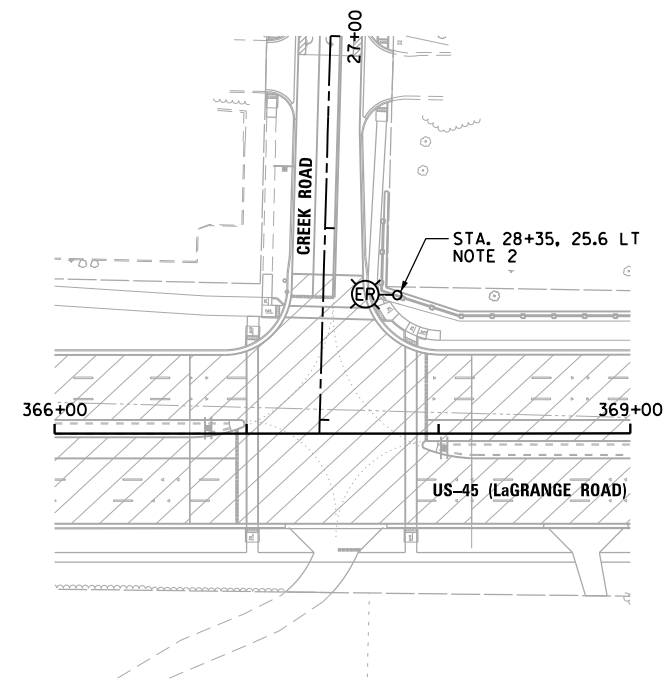

CREEK ROAD PROPOSED ROADWAY LIGHTING PLAN
SCALE: 1" = 50'-0"

100 S. WACKER DR.
 SUITE 500
 CHICAGO, IL 60606
 TEL (312) 939-1000
 FAX (312) 939-4198
URS

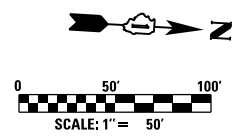

FILE NAME = D160M62-SHT-E08.dgn	USER NAME = Anthony.Plutz	DESIGNED - MAE	REVISED -
SHT.PLAN	PLOT SCALE = 100.000000' / in.	DRAWN - WM	REVISED -
	PLOT DATE = 3/13/2013	CHECKED - DAD	REVISED -
		DATE - 03/13/13	REVISED -

STATE OF ILLINOIS
DEPARTMENT OF TRANSPORTATION

CREEK ROAD ROADWAY LIGHTING PLANS
 SCALE: 1"=50' SHEET 1 OF 1 SHEETS STA. 366+00 TO STA. 369+00

F.A.P. RTE.	SECTION	COUNTY	TOTAL SHEETS	SHEET NO.
330	103R-5	COOK	778	332
E-8			CONTRACT NO. 60M62	
ILLINOIS FED. AID PROJECT				