

**ELEVATION**

(Looking at F.F. of Wall)

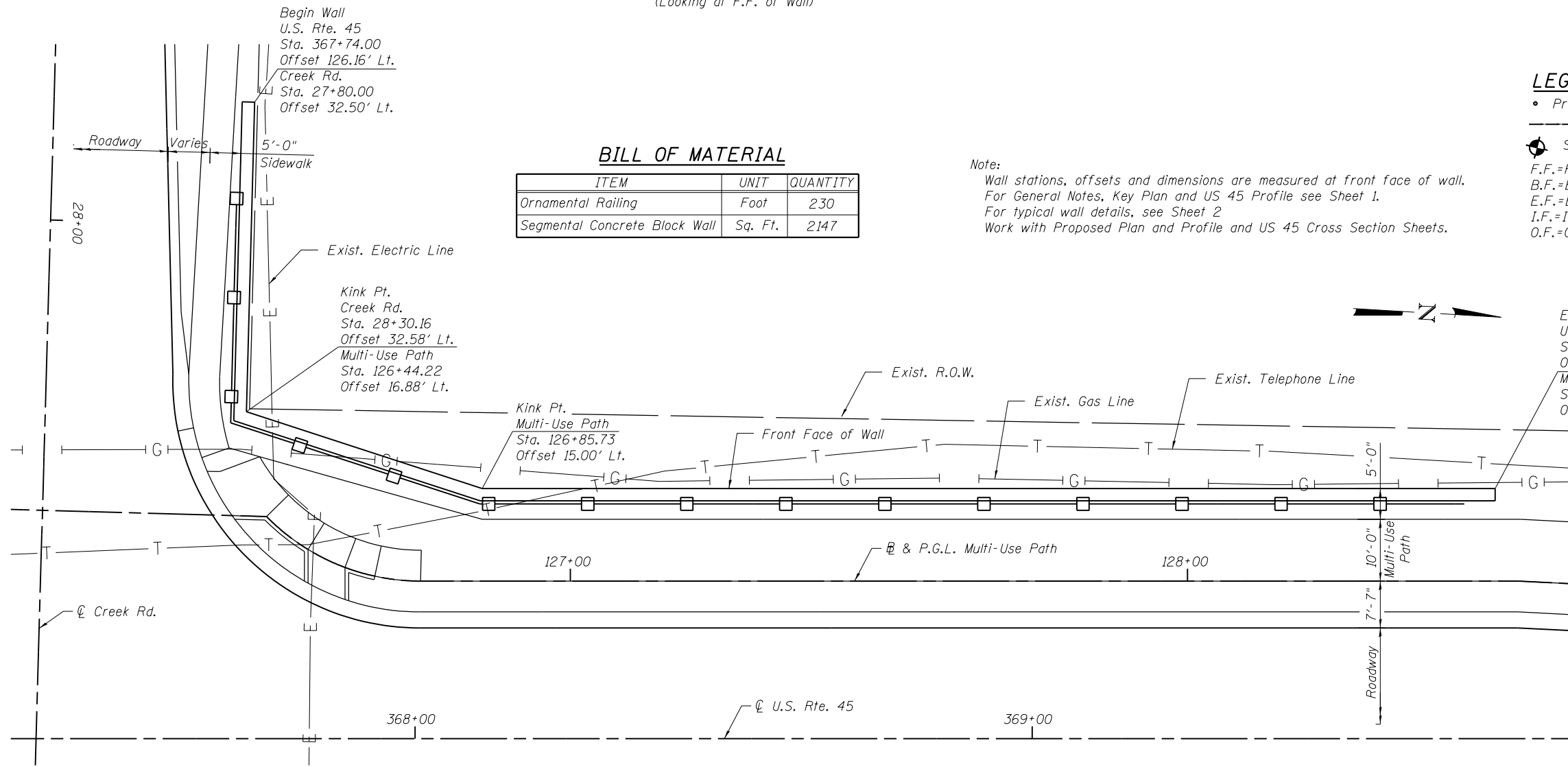

**BILL OF MATERIAL**

ITEM	UNIT	QUANTITY
Ornamental Railing	Foot	230
Segmental Concrete Block Wall	Sq. Ft.	2147

Note:

Wall stations, offsets and dimensions are measured at front face of wall. For General Notes, Key Plan and US 45 Profile see Sheet 1. For typical wall details, see Sheet 2. Work with Proposed Plan and Profile and US 45 Cross Section Sheets.

**LEGEND**

- Prop. Drainage Structure
- Prop. Storm Sewer/Pipe Culvert
- ⊙ Soil Boring
- F.F.=Front Face
- B.F.=Back Face
- E.F.=Each Face
- I.F.=Inside Face
- O.F.=Outside Face

100 S. WACKER DR.  
 SUITE 600  
 CHICAGO, IL 60606  
 TEL (312) 935-1000  
 FAX (312) 935-4988  
**URS**

FILE NAME = D160M62-SHT-Wall.07.dgn	USER NAME = Anthony.Plutz	DESIGNED - PMH	REVISED -
		CHECKED -	REVISED -
	PLOT SCALE = 21.33' / in.	DRAWN - PMH	REVISED -
	PLOT DATE = 3/13/2013	CHECKED -	REVISED -

**STATE OF ILLINOIS  
DEPARTMENT OF TRANSPORTATION**

**RETAINING WALL NO. 7 - S.N. 016-2059  
STATION 367+74 TO 369+75**

SHEET NO. 9 OF 18 SHEETS

F.A.P. RTE. 330	SECTION 103R-5	COUNTY COOK	TOTAL SHEETS 778	SHEET NO. 384
CONTRACT NO. 60M62				
ILLINOIS FED. AID PROJECT				