

- LEGEND**
- Prop. Drainage Structure
  - Prop. Storm Sewer/Pipe Culvert
  - ⊙ Soil Boring
  - F.F.=Front Face
  - B.F.=Back Face
  - E.F.=Each Face
  - I.F.=Inside Face
  - O.F.=Outside Face

**BILL OF MATERIAL**

ITEM	UNIT	QUANTITY
Ornamental Railing	Foot	997
Segmental Concrete Block Wall	Sq. Ft.	8856

**ELEVATION**  
(Looking at F.F. of Wall)

Note:  
Wall stations, offsets and dimensions are measured at front face of wall.  
For General Notes, Key Plan and U.S. Rte. 45 Profile see Sheet 1.  
For typical wall details, see Sheet 2  
Work with Proposed Plan and Profile and US 45 Cross Section Sheets.

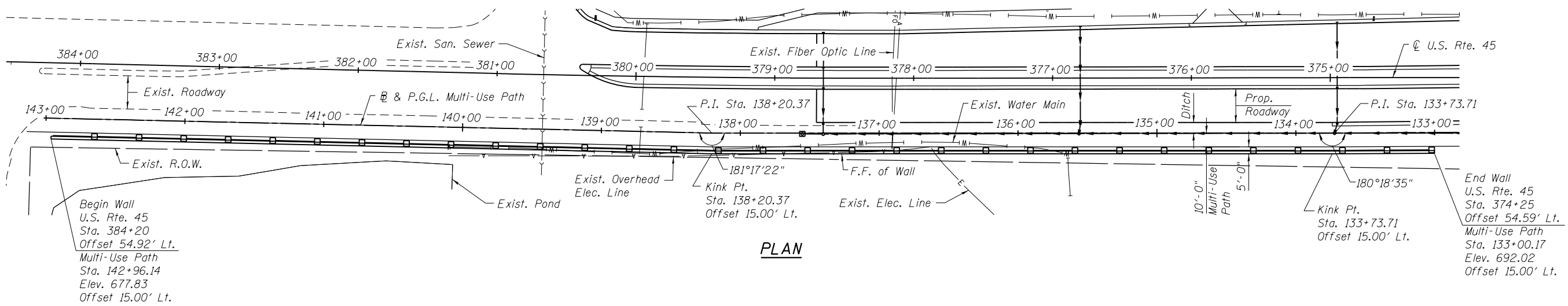

**PLAN**

100 S. WACKER DR.  
 SUITE 600  
 CHICAGO, IL 60606  
 TEL (312) 939-1000  
 FAX (312) 939-4998  
**URS**

FILE NAME = D160M62-SHT-Wall.08.dgn	USER NAME = Anthony.Plutz	DESIGNED - PMH	REVISIED -	<b>STATE OF ILLINOIS DEPARTMENT OF TRANSPORTATION</b>	<b>RETAINING WALL NO. 8 - S.N. 016-2060 STATION 374+25 TO 384+20</b>	F.A.P. RTE. 330	SECTION 103R-5	COUNTY COOK	TOTAL SHEETS 778	SHEET NO. 385	
	PLOT SCALE = 80:8.00 1" = 80'	DRAWN - PMH	REVISIED -			SHEET NO. 10 OF 18 SHEETS					
	PLOT DATE = 3/13/2013	CHECKED -	REVISIED -			CONTRACT NO. 60M62					
ILLINOIS FED. AID PROJECT											