

Bench Mark: Elev. 689.00 Top of brass survey monument located at the west edge of the LaGrange Road southbound pavement, 600 feet north of the SouthWest Highway bridge.

Existing Structure: None

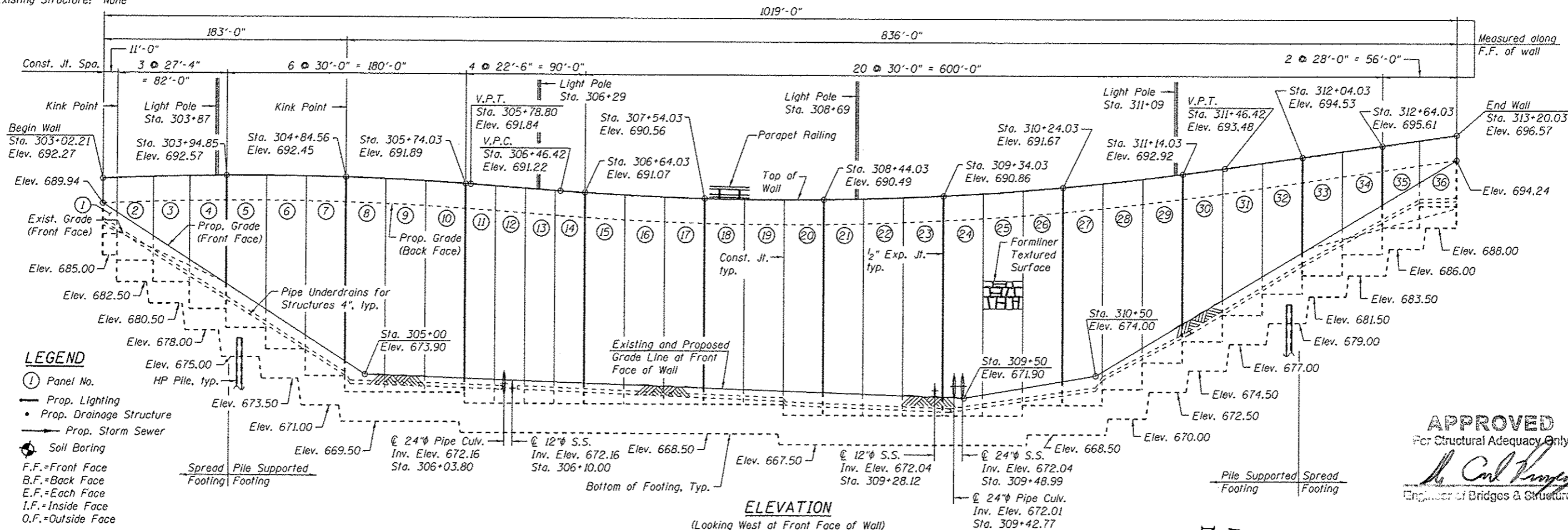

**APPROVED**  
For Structural Adequacy Only  
*Carl Krueger*  
Engineer of Bridges & Structures

**LEGEND**

- ① Panel No.
- Prop. Lighting
- Prop. Drainage Structure
- Prop. Storm Sewer
- ⊕ Soil Boring
- F.F.=Front Face
- B.F.=Back Face
- E.F.=Each Face
- I.F.=Inside Face
- O.F.=Outside Face

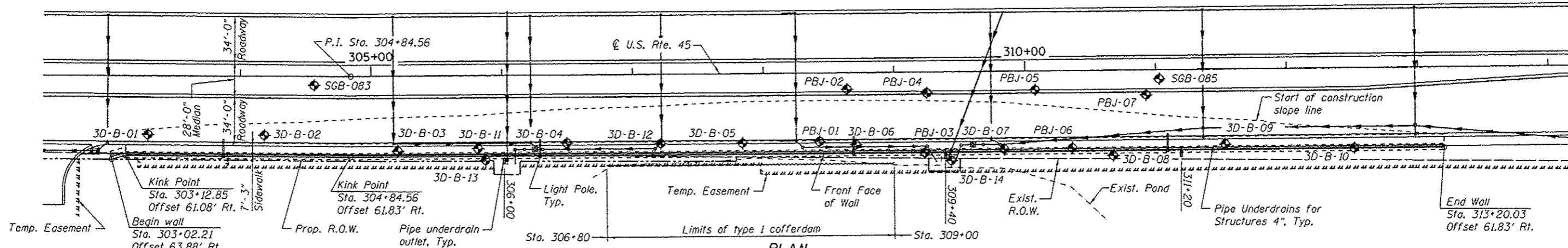

Note: Wall offsets are measured from the @ U.S. Rte. 45 to the front face of wall.

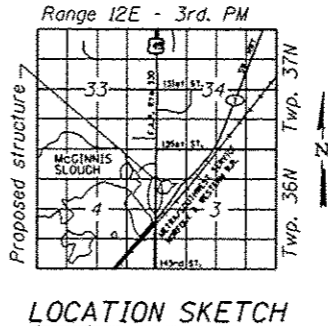

**DESIGN STRESSES**  
FIELD UNITS  
f'c = 3,500 psi  
fy = 60,000 psi (Reinforcement)  
fy = 50,000 psi (M270 Grade 50)

**DESIGN SPECIFICATIONS**  
2012 AASHTO LRFD Bridge Design Specifications, 6th Edition, with 2012 Interims

**LEGEND**

- Prop. Drainage Structure
- Prop. Storm Sewer
- ⊕ Soil Boring
- F.F.=Front Face
- B.F.=Back Face
- E.F.=Each Face
- I.F.=Inside Face
- O.F.=Outside Face

**GENERAL PLAN & ELEVATION**  
U.S. ROUTE 45 - LAGRANGE ROAD  
F.A.P. RTE. 330 SEC. 103R-5  
COOK COUNTY  
STATION 303+02.21 TO 313+20.03  
STRUCTURE NO. 016-Z005



ARSALAN M. KHAN, S.E.  
LICENSE NO.: 081-006258  
EXPIRES: NOVEMBER 30, 2014  
DATE: 03-13-2013

FILE NAME: 016Z005-G0M2-001-GPE.dgn	USER NAME: Kyle.Pearl	DESIGNED: PMH	REVISIONS:	STATE OF ILLINOIS DEPARTMENT OF TRANSPORTATION	F.A.P. RTE. 330	SECTION 103R-5	COUNTY COOK	TOTAL SHEETS 778	SHEET NO. 420
		CHECKED: MJL	REVISIONS:		SHEET NO. 1 OF 21 SHEETS				
		DRAWN: PMH	REVISIONS:						
		CHECKED: MJL	REVISIONS:						

PR 8-15-2013

