

DATE	
BY	
FINISHED SURVEY	
PLOTTED	
TEMPLATE	
NOTE BOOK	
AREAS CHECKED	

DATE	
BY	
ORIGINAL SURVEY	
PLOTTED	
TEMPLATE	
NOTE BOOK	
AREAS CHECKED	

100 S. WACKER DR.
 CHICAGO, IL 60606
 TEL 312/939-1000
 FAX 312/939-4198

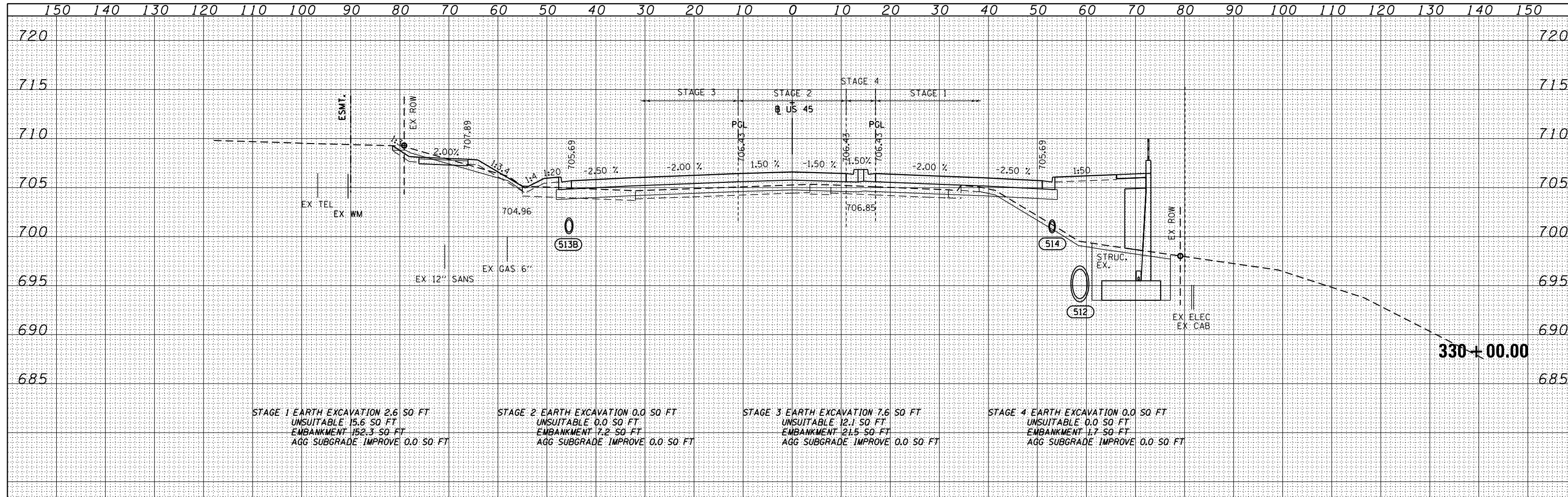

STAGE 1 EARTH EXCAVATION 2.6 SQ FT
 UNSUITABLE 15.6 SQ FT
 EMBANKMENT 152.3 SQ FT
 AGG SUBGRADE IMPROVE 0.0 SQ FT

STAGE 2 EARTH EXCAVATION 0.0 SQ FT
 UNSUITABLE 0.0 SQ FT
 EMBANKMENT 7.2 SQ FT
 AGG SUBGRADE IMPROVE 0.0 SQ FT

STAGE 3 EARTH EXCAVATION 7.6 SQ FT
 UNSUITABLE 12.1 SQ FT
 EMBANKMENT 21.5 SQ FT
 AGG SUBGRADE IMPROVE 0.0 SQ FT

STAGE 4 EARTH EXCAVATION 0.0 SQ FT
 UNSUITABLE 0.0 SQ FT
 EMBANKMENT 1.7 SQ FT
 AGG SUBGRADE IMPROVE 0.0 SQ FT

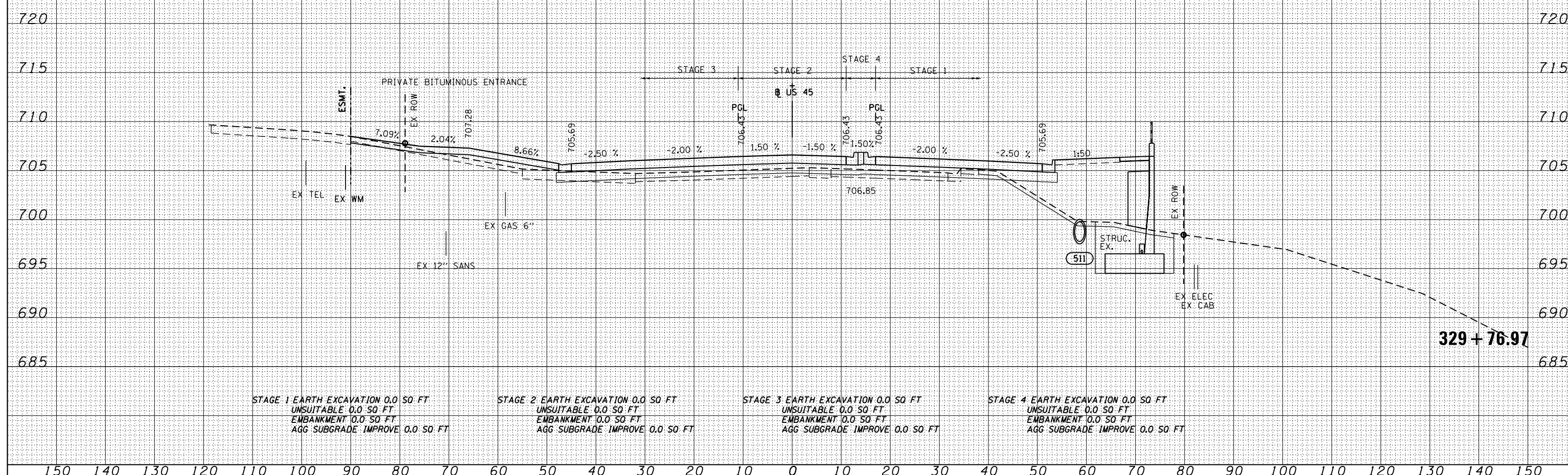

STAGE 1 EARTH EXCAVATION 0.0 SQ FT
 UNSUITABLE 0.0 SQ FT
 EMBANKMENT 0.0 SQ FT
 AGG SUBGRADE IMPROVE 0.0 SQ FT

STAGE 2 EARTH EXCAVATION 0.0 SQ FT
 UNSUITABLE 0.0 SQ FT
 EMBANKMENT 0.0 SQ FT
 AGG SUBGRADE IMPROVE 0.0 SQ FT

STAGE 3 EARTH EXCAVATION 0.0 SQ FT
 UNSUITABLE 0.0 SQ FT
 EMBANKMENT 0.0 SQ FT
 AGG SUBGRADE IMPROVE 0.0 SQ FT

STAGE 4 EARTH EXCAVATION 0.0 SQ FT
 UNSUITABLE 0.0 SQ FT
 EMBANKMENT 0.0 SQ FT
 AGG SUBGRADE IMPROVE 0.0 SQ FT

FILE NAME = D160M62-SHT-XSSH01.dgn	USER NAME = Anthony.Plutz	DESIGNED - JCL	REVISD -	STATE OF ILLINOIS DEPARTMENT OF TRANSPORTATION	US 45 CROSS SECTIONS SCALE: 1"=10'H; 1"=5' SHEET NO. 49 OF 110 SHEETS STA. 329+76.97 TO STA. 330+00.00			F.A.P. RTE. 330	SECTION 103R-5	COUNTY COOK	TOTAL SHEETS 778	SHEET NO. 680
PLOT SCALE = 20.0000 "/td> <td>CHECKED - MJT</td> <td>REVISD -</td> <td colspan="4"> XS-US45-49 </td> <td>CONTRACT NO. 60M62</td>	CHECKED - MJT	REVISD -	XS-US45-49					CONTRACT NO. 60M62				
PLOT DATE = 3/12/2013	DATE - 03/13/13	REVISD -	ILLINOIS FED. AID PROJECT									