

DATE	
BY	
FINISHED	
NO. OF SHEETS	
DATE	
BY	
FINISHED	
NO. OF SHEETS	
DATE	
BY	
FINISHED	
NO. OF SHEETS	

DATE	
BY	
FINISHED	
NO. OF SHEETS	
DATE	
BY	
FINISHED	
NO. OF SHEETS	
DATE	
BY	
FINISHED	
NO. OF SHEETS	

100 S. WACKER DR.
 SUITE 200
 CHICAGO, IL 60606
 TEL (312) 939-4000
 FAX (312) 939-4198

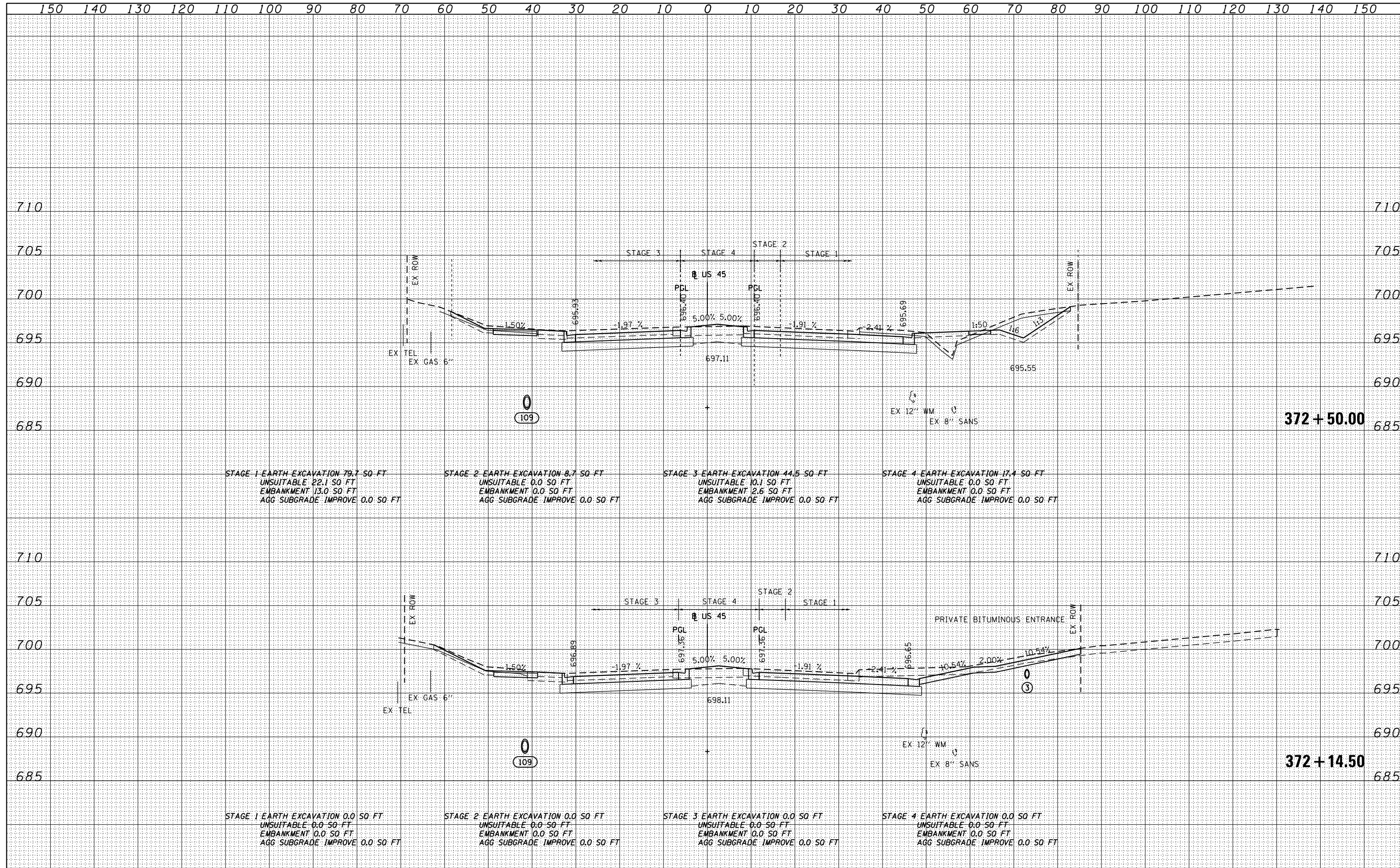

FILE NAME =	USER NAME = Anthony.Plutz	DESIGNED - JCL	REVISED -	STATE OF ILLINOIS DEPARTMENT OF TRANSPORTATION	US 55 CROSS SECTIONS SCALE: 1"=10'H, 1"=5' V SHEET NO. 98 OF 110 SHEETS STA. 372+14.50 TO STA. 372+50.00			F.A.P. RTE.	SECTION	COUNTY	TOTAL SHEETS	SHEET NO.
D160M62-SHT-XSSHT01.dgn		DRAWN - JCL	REVISED -					330	103R-5	COOK	778	729
		CHECKED - MJT	REVISED -					XS-US45-98 CONTRACT NO. 60M62				
		DATE - 03/13/13	REVISED -									ILLINOIS FED. AID PROJECT