

SECTION A-A

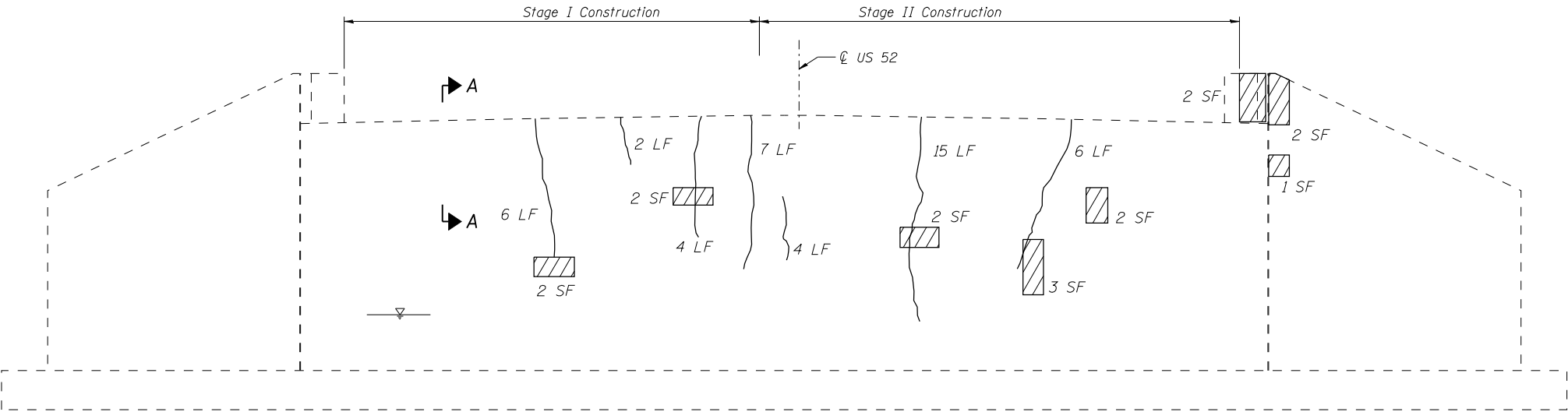

ELEVATION - REMOVAL AND REPAIR
(Looking South)

— Epoxy Crack Injection
Formed Concrete Repair Depth $\leq 5"$

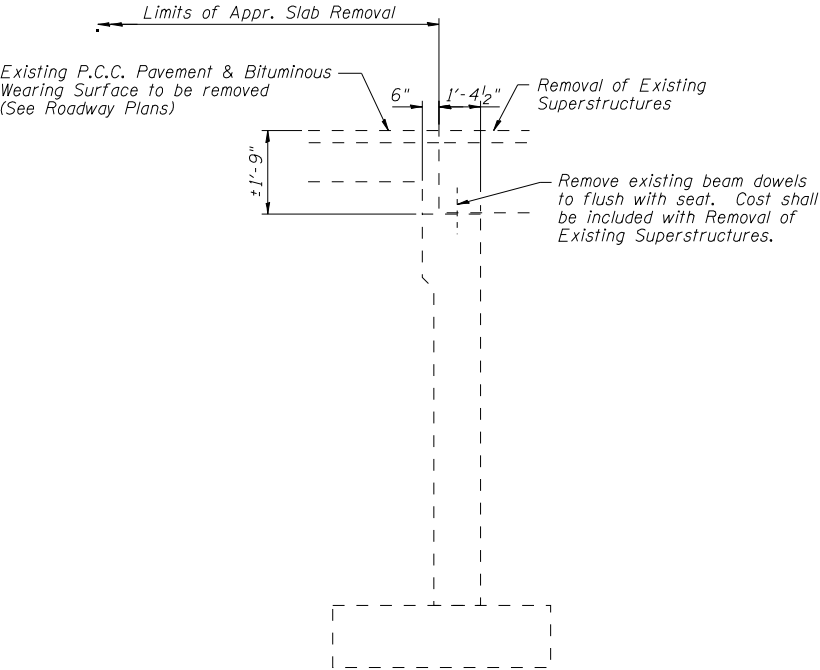

EXISTING SECTION THRU ABUTMENT

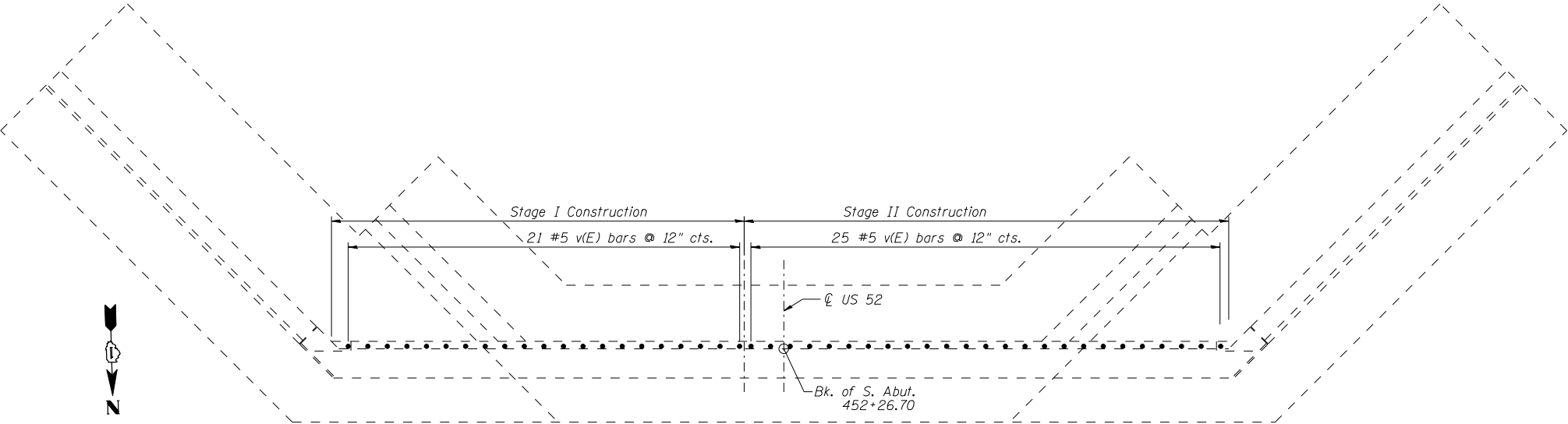

PLAN

NOTES

Existing reinforcement bars which have lost 25% or more of their original diameter shall be supplemented by new epoxy coated bars of the same diameter. New bars shall be drilled and epoxy grouted in place adjacent to the original bars, as directed by the Engineer.

Epoxy grout v(E) bars in drilled holes of the depth specified by the manufacturer according to Art. 584 of the Standard Specifications. Bar lengths shown are based on 9 inch min. drilled holes. Actual bar lengths shall be adjusted as necessary.

See sht. S7 of S16 for proposed section thru abutment.

BILL OF MATERIAL

Bar	No.	Size	Length	Shape
v(E)	46	#5	3'-1"	—
Epoxy Crack Injection			Foot	44
Structural Repair of Concrete (Depth less than equal to 5")			Sq. Ft.	16
Reinforcement Bars, Epoxy Coated			Pound	150