

PROPOSED TYPICAL SECTIONS
 STA. 3+59 TO STA. 73+10
 STA. 81+70 TO STA. 141+00
 STA. 156+50 TO STA. 163+34

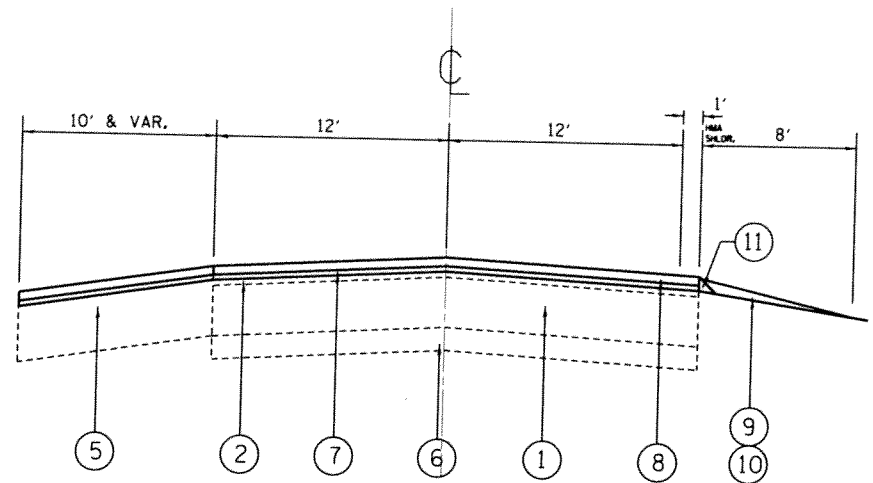

PROPOSED TYPICAL SECTIONS
 STA. 73+10 TO STA. 81+70

- LEGEND:**
- ① EXIST. P.C.C. PAVEMENT, ±9"
 - ② EXIST. HOT-MIX ASPHALT SURFACE, ±4" (AFTER HEATING AND SCARIFICATION)
 - ③ EXIST. COMBINATION CONCRETE CURB AND GUTTER, TYPE B-6.12
 - ④ EXIST. AGGREGATE SHOULDER
 - ⑤ EXIST. HOT-MIX ASPHALT SHOULDER
 - ⑥ EXIST. STABILIZED SUB-BASE
 - ⑦ PROP. HOT IN-PLACE RECYCLING, 1"
 - ⑧ PROP. POLYMERIZED HOT-MIX ASPHALT SURFACE COURSE, MIX "D", N70, 2"
 - ⑨ PROP. GRADING AND SHAPING SHOULDERS
 - ⑩ PROP. AGGREGATE WEDGE SHOULDER, TYPE B
 - ⑪ PROP. SAFETY EDGE
- R CURB AND GUTTER REMOVAL AND REPLACEMENT

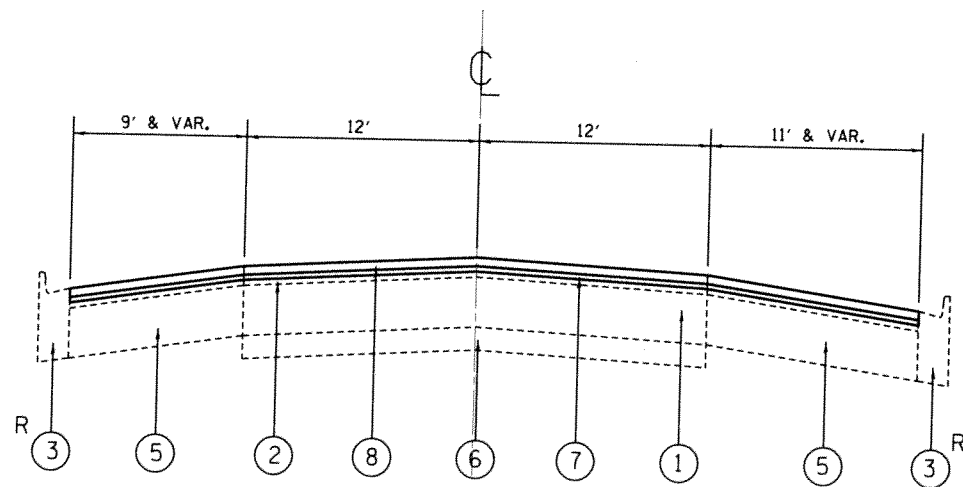

PROPOSED TYPICAL SECTIONS
 STA. 141+50 TO STA. 156+50

FILE NAME =	USER NAME = steedpa	DESIGNED -	REVISED -
e:\pw-work\pwidot\steedpa\d0249543\0138	11-shr-plan.dgn	DRAWN -	REVISED -
	PLOT SCALE = 100.0000 1/4 in.	CHECKED -	REVISED -
	PLOT DATE = 1/31/2013	DATE -	REVISED -

STATE OF ILLINOIS
 DEPARTMENT OF TRANSPORTATION

PROPOSED TYPICAL CROSS SECTIONS
 F.A.P. 330/ US 45 (LA GRANGE RD.)--SAGER RD. TO STUENKAL RD.

F.A.P. RTE.	SECTION	COUNTY	TOTAL SHEETS	SHEET NO.
330	104-R5-10	WILL	20	6

CONTRACT NO. 60N32

SCALE: SHEET NO. OF SHEETS STA. TO STA.