

EXISTING TYPICAL SECTION

STA. 944+42 TO STA. 976+75
 STA. 983+00 TO STA. 995+50
 STA. 1002+25 TO STA. 1014+75
 STA. 1020+75 TO STA. 1031+00
 STA. 1042+00 TO STA. 1049+56

LEGEND

- ① EXISTING +/- 2 1/2" HMA
- ② EXISTING +/-10" P.C.C. BASE
- ③ EXISTING CURB AND GUTTER
- ④ EXISTING HMA SHOULDER +/-8"
- ⑤ HMA SURFACE REMOVAL - 2 1/2" (SEE NOTE 1)
- ⑥ HOT-MIX ASPHALT SURFACE COURSE, MIX "D", N70 (IL-9.5MM) - 2"
- ⑦ POLYMERIZED LEVELING BINDER (MACHINE METHOD), IL-4.75, N50 -1"
- ⑧ POLYMERIZED HOT-MIX ASPHALT SURFACE COURSE, STONE MATRIX ASPHALT, N80 -2"
- ⑨ HMA SURFACE REMOVAL - 2 1/2"
- ⑩ EXISTING CONCRETE MEDIAN SURFACE REMOVAL - 4"
- ⑪ REMOVAL AND DISPOSAL OF UNSUITABLE MATERIAL
- ⑫ PROPOSED LANDSCAPE MEDIAN BURN AND SWALES, WITH TOPSOIL - VARIABLE DEPTH AND SEEDING, CLASS 2A (SEE LANDSCAPING DETAIL)
- ⑬ PROP. CONCRETE CURB AND GUTTER (TYPE AND LOCATIONS TO BE DETERMINED BY THE ENGINEER)
- ⑭ EXISTING STABILIZED SUB-BASE, 4"
- ⑮ HOT MIX ASPHALT SURFACE REMOVAL, VARIABLE DEPTH

NOTES

1. THE CONTRACTOR SHALL PERFORM THE PAVEMENT PATCHING OPERATIONS PRIOR TO THE HMA SURFACE REMOVAL OPERATION. SEE IDOT DISTRICT 1 DETAIL PAVEMENT PATCHING FOR HMA SURFACED PAVEMENT (BD-22) FOR ADDITIONAL INFORMATION.
2. NO ADDITIONAL COMPENSATION WILL BE GIVEN TO THE CONTRACTOR FOR ANY EXTRA WORK REQUIRED TO MILL THE HMA SHOULDER ADJACENT TO THE EXISTING BARRIER WALL. THIS WORK WILL BE INCLUDED IN THE CONTRACT UNIT PRICE FOR HMA SURFACE REMOVAL - 2 1/2" .
3. PLACEMENT OF POLYMERIZED LEVELING BINDER SHALL STOP ONE FOOT FROM THE EDGE OF SHOULDER (NO CURB AND GUTTER). SURFACE MIX WILL BE USED FULL DEPTH WITHIN THE REMAINING FOOT.

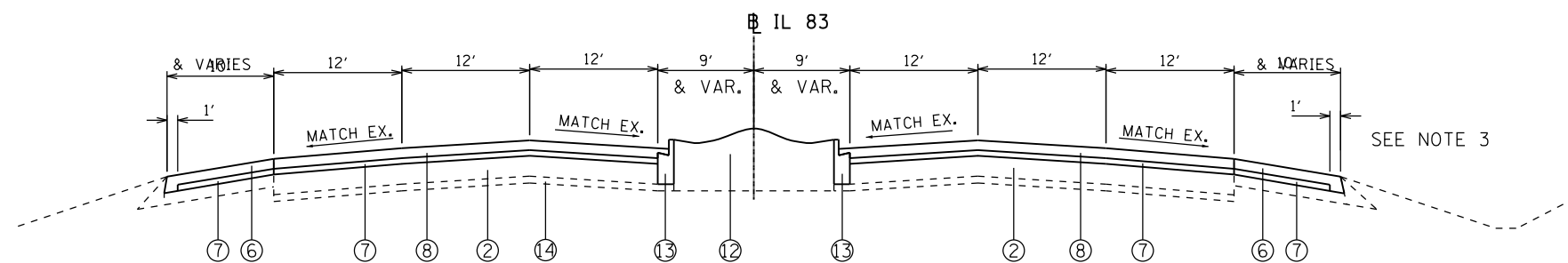

PROPOSED TYPICAL SECTION

STA. 944+42 TO STA. 976+75
 STA. 983+00 TO STA. 995+50
 STA. 1002+25 TO STA. 1014+75
 STA. 1020+75 TO STA. 1031+00
 STA. 1042+00 TO STA. 1049+56

FILE NAME = c:\pwork\pwork\bid\bilgramisa\d0315608\100313-sh-t-plan.dgn	USER NAME = Bilgramisa	DESIGNED -	REVISED - SB 3/14/13	STATE OF ILLINOIS DEPARTMENT OF TRANSPORTATION	IL 83 (IL 64 TO IL 19) EXISTING AND PROPOSED TYPICAL SECTIONS		F.A.P. RTE.	SECTION	COUNTY	TOTAL SHEETS	SHEET NO.
	PLOT SCALE = 100.0000' / in.	CHECKED -	REVISED -				344	540R-RS-3	DUPAGE	38	8
\$MODELNAME\$	PLOT DATE = 3/15/2013	DATE -	REVISED -	SCALE: SHEET OF SHEETS STA. TO STA.		ILLINOIS FED. AID PROJECT					
							CONTRACT NO. 60V54				