

NORTH ELEVATION
*Dimensions at Right Angles

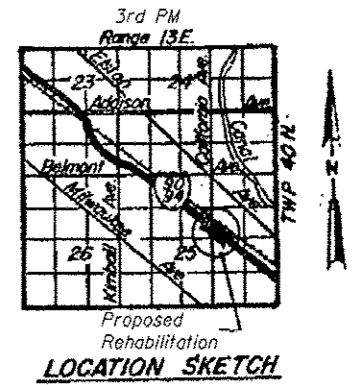

Proposed Rehabilitation
LOCATION SKETCH

SCOPE OF WORK

1. Expansion Joint Repairs
2. Substructure Repairs

DESIGN SPECIFICATIONS
2002 AASHTO Standard Specifications
for Highway Bridges (17th Edition)

LOADING HS20-44

LEGEND

- Joint Repair Area
- 10.0 LF Scope of Work

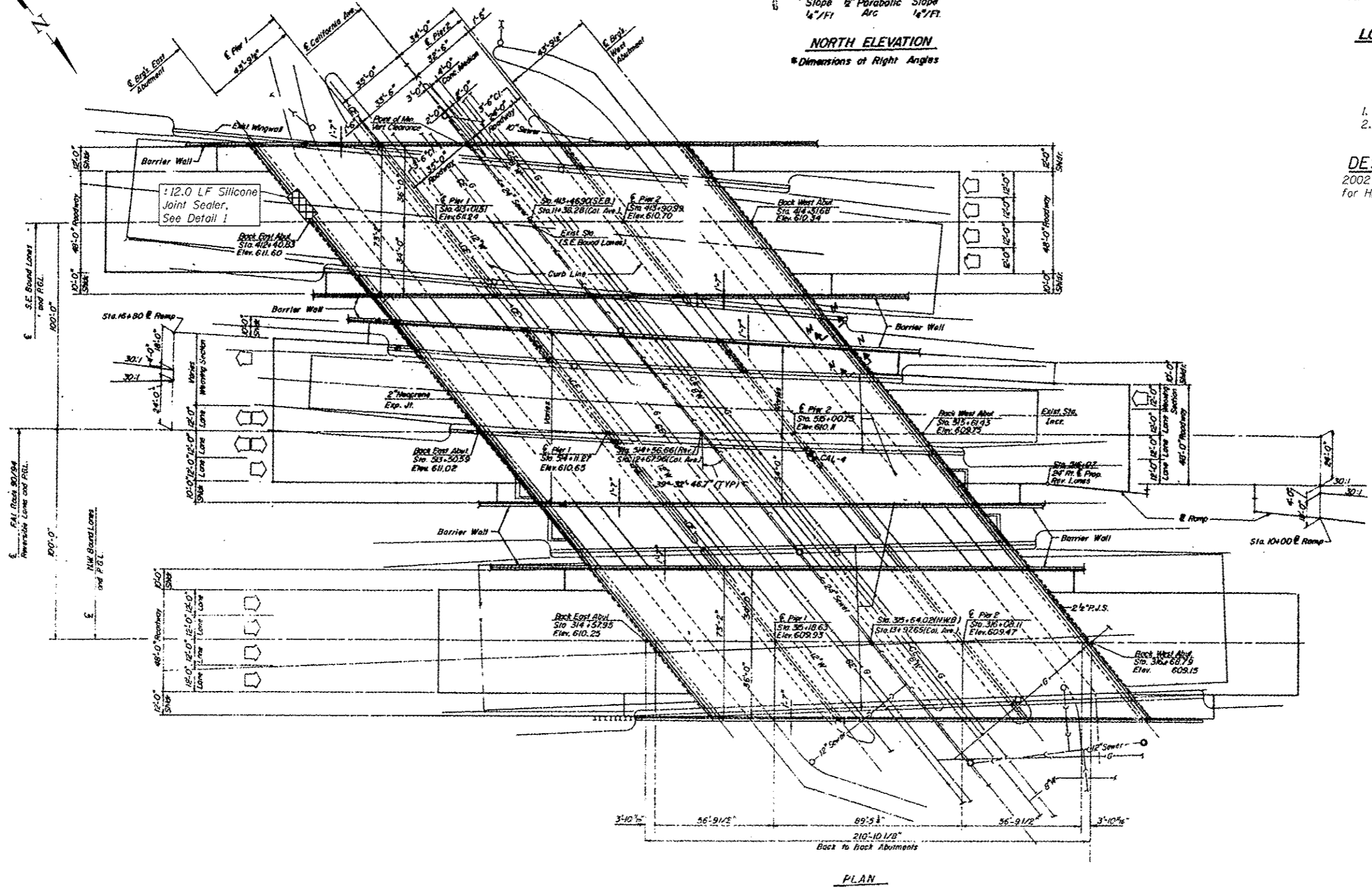

PLAN

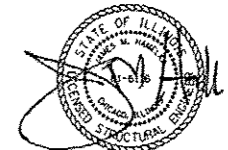

COLLINS ENGINEERS, INC.
JAMES M. HAMELKA
NO. 81-6116
EXPIRES 11-30-2014

COLLINS ENGINEERS, INC. 123 N. State St. Suite 500 Chicago, IL 60604 Tel: 312.721.1000 Fax: 312.721.1001 www.collinseng.com	USER NAME =	DESIGNED - AMS	REVISED -	STATE OF ILLINOIS DEPARTMENT OF TRANSPORTATION	GENERAL PLAN AND ELEVATION - I-90/94 OVER CALIFORNIA AVE. (SN 016-1077, 016-1076, & 016-0124)	F.A.I. RTE. =	SECTION	COUNTY	TOTAL SHEETS	SHEET NO.	
	PLOT SCALE =	DRAWN - AMS	REVISED -			90/94	2012-055BR	COOK	107	45	
	PLOT DATE =	CHECKED - JMH	REVISED -			CONTRACT NO. 60V58					
		DATE - DECEMBER 2012	REVISED -			ILLINOIS FED. AID PROJECT					