

PIER 18 SOUTH ELEVATION
(Looking North)

Note:
Beams are numbered East to West.

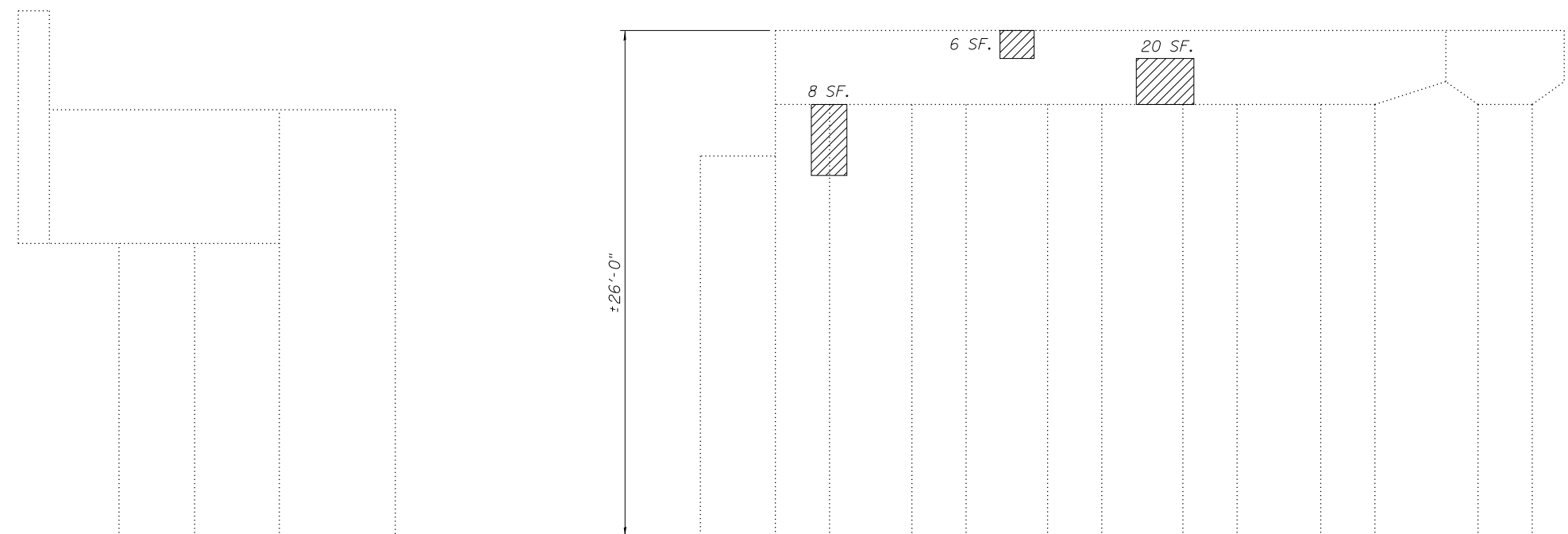

PIER 18 NORTH ELEVATION
(Looking South)

PIER 18 GIRDER REACTION TABLE		
	Span 18	Span 19
R _{DL} (k)	51.1	53.7
R _{SDL} (k)	16.1	15.4
R _{LL} (k)	43.0	37.5
R _T (k)	11.0	9.2
R _{Total} (k)	121.2	115.8

Note:
Due to variable girder type, spacing, and span, reactions provided are a general indication for the loads within the indicated span. Contractor shall verify loading at each shoring location. Cost included in pay item 'Temporary Shoring and Cribbing.'

BILL OF MATERIAL

SYMBOL	ITEM	UNIT	QUANTITY
	Structural Repair of Concrete, (Depth Equal To or Less Than 5")	Sq. Ft.	208
	Temporary Shoring and Cribbing	Each	6