

DATE	
BY	
SURVEYED	
ALIGNED	
CHECKED	
PT. OF WAY CHECKED	
AND FILED	
NO.	
PLAN	
NOTE BOOK	

DATE	
BY	
SURVEYED	
LOADES CHECKED	
B.M. NOTED	
STRUCTURE NOTATIONS CHECKED	
NO.	
PROFILE	
NOTE BOOK	

COMPANY NAME: HRGreen.com  
 PROJECT CONTACT: SMP  
 CLIENT: STATE OF ILLINOIS  
 DATE PLOTTED: 2/8/2013 10:05:18 PM  
 FILE NAME: 6352.mrtyp001.dgn  
 PLOT DRIVE: pdf\_wcpf  
 PEN TABLE: s1 (color) (17ms, 7%)

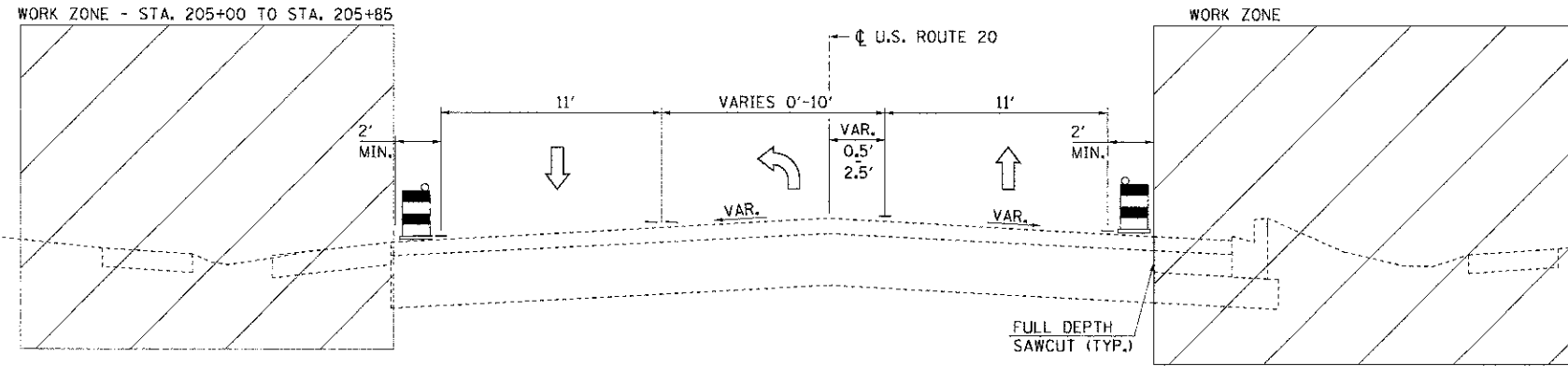

**U.S. ROUTE 20 - STAGE 1**  
 STA 198+00.00 TO STA 215+00.00

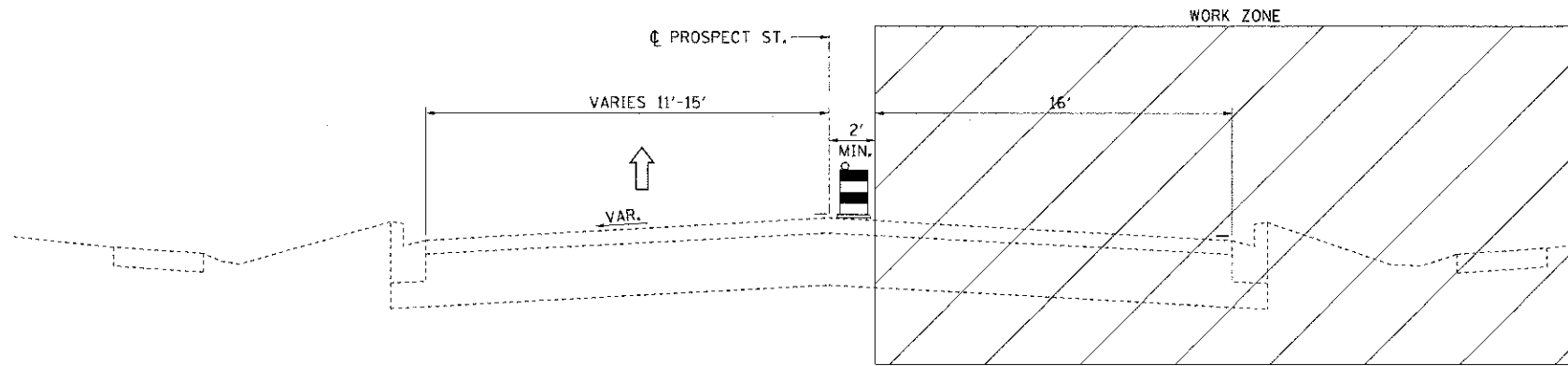

**PROSPECT STREET - STAGE 1**  
 STA 10+00.00 TO STA 24+80.00  
 STA 45+55.00 TO STA 51+00.00

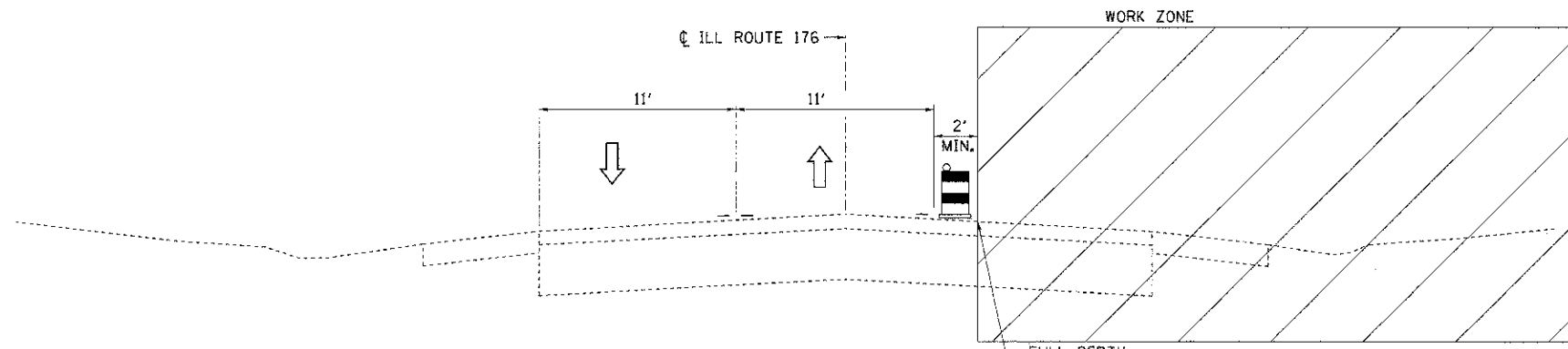

**ILL ROUTE 176 - STAGE 1**  
 STA 102+50.00 TO STA 117+75.00

USER NAME = spanel	DESIGNED DCJ	REVISED -
	DRAWN SMP	REVISED -
PLST SCALE = N/A	CHECKED - TEH	REVISED -
PLST DATE = 2/8/2013	DATE - 2/5/13	REVISED -

**STATE OF ILLINOIS**  
**DEPARTMENT OF TRANSPORTATION**

**SUGGESTED MAINTENANCE OF TRAFFIC - STAGE 1**  
**TYPICAL SECTIONS**

SCALE: N/A SHEET NO. 2 OF 10 SHEETS STA. TO STA.

F.A.U. RTE.	SECTION	COUNTY	TOTAL SHEETS	SHEET NO.
4087	98-0024-00-WR	MCHENRY	115	33
FED. ROAD DIST. NO.			ILLINOIS FED. AID PROJECT	
			CONTRACT NO. 63532	