

PLAN	DATE
NO.	
BY	
DATE	
REVISIONS	
NO.	DESCRIPTION
1	ISSUED FOR PERMITS
2	ISSUED FOR CONSTRUCTION
3	ISSUED FOR AS-BUILT

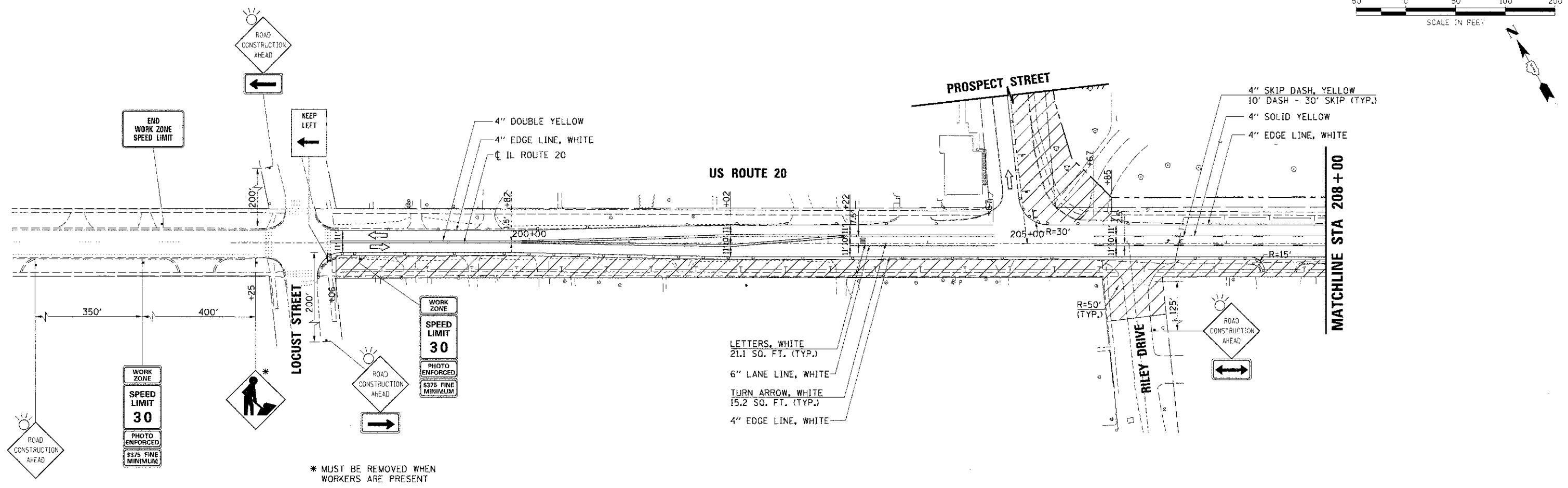

\* MUST BE REMOVED WHEN WORKERS ARE PRESENT

PROFILE	DATE
NO.	
BY	
DATE	
REVISIONS	
NO.	DESCRIPTION
1	ISSUED FOR PERMITS
2	ISSUED FOR CONSTRUCTION
3	ISSUED FOR AS-BUILT

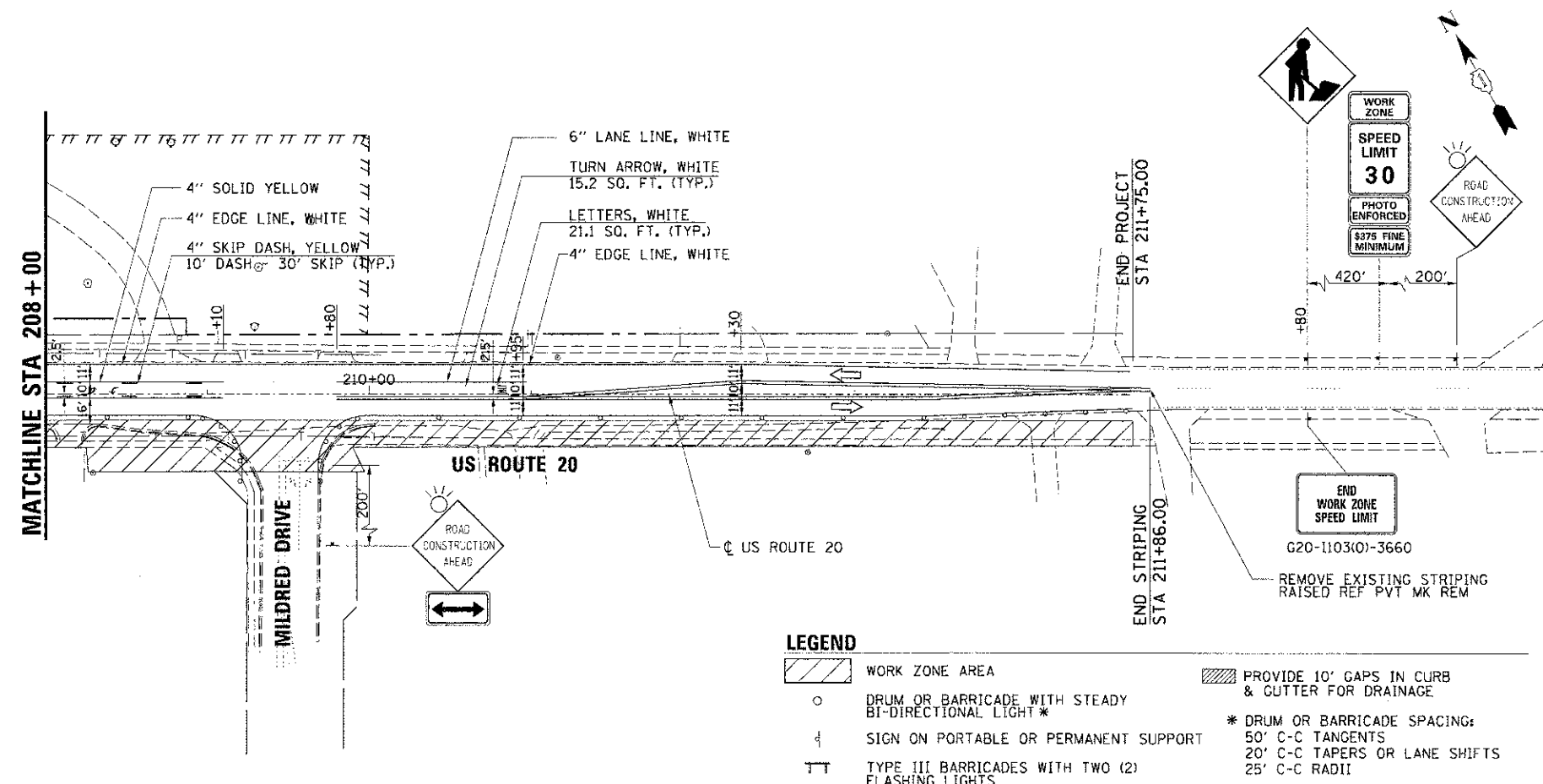

**LEGEND**

- WORK ZONE AREA
- DRUM OR BARRICADE WITH STEADY BI-DIRECTIONAL LIGHT \*
- SIGN ON PORTABLE OR PERMANENT SUPPORT
- TYPE III BARRICADES WITH TWO (2) FLASHING LIGHTS
- PROVIDE 10' GAPS IN CURB & GUTTER FOR DRAINAGE
- \* DRUM OR BARRICADE SPACING: 50' C-C TANGENTS 20' C-C TAPERS OR LANE SHIFTS 25' C-C RADIUS

COMPANY NAME: HRGreen  
 PROJECT CONTACT: [Name]  
 CLIENT: [Name]  
 DATE PLOTTED: 2/8/2013 10:12:14 AM  
 FILE NAME: 636\_m04\_sta01.dwg  
 PLOT DRIVER: pdf\_printer  
 PEN TABLE: standard-trans.tbl

**HRGreen.com**  
 Illinois Professional Design Firm  
 #164-201322

USER NAME = sperral	DESIGNED DCJ	REVISED -
	DRAWN SMP	REVISED -
PLOT SCALE = 1" = 50'	CHECKED - TEH	REVISED -
PLOT DATE = 2/8/2013	DATE - 2/5/13	REVISED -

**STATE OF ILLINOIS  
 DEPARTMENT OF TRANSPORTATION**

**SUGGESTED MAINTENANCE OF TRAFFIC - STAGE 1  
 U.S. ROUTE 20**

SCALE: 1" = 50' SHEET NO. 5 OF 10 SHEETS STA. 198+06.00 TO STA. 211+75.00

F.A.I.D. NO. 4087	SECTION 98-0024-00-WR	COUNTY MCHENRY	TOTAL SHEETS 115	SHEET NO. 36
FED. ROAD DIST. NO. ILLINOIS FED. AID PROJECT			CONTRACT NO. 63532	