

DATE	
BY	
PROJECT	
CLIENT	
DATE PLOTTED	
FILE NAME	
PLT FILE	
PRINT SCALE	
PRINT DATE	

DATE	
BY	
PROJECT	
CLIENT	
DATE PLOTTED	
FILE NAME	
PLT FILE	
PRINT SCALE	
PRINT DATE	

COMPANY NAME: HRGreen
 PROJECT CONTACT: HRGreen.com
 CLIENT: Illinois Professional Design Firm
 DATE PLOTTED: 2/8/2013 10:02:18 PM
 FILE NAME: 636.mst.s98.02.dgn
 PLT FILE: 636.plt
 PRINT SCALE: 1"=50'
 PRINT DATE: 2/8/2013

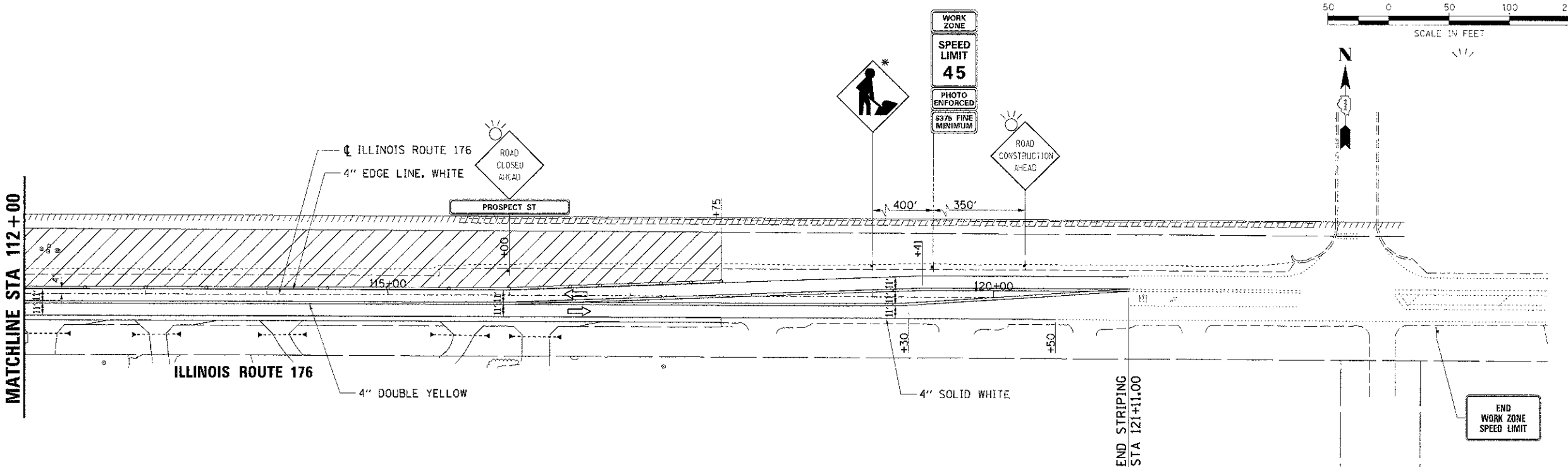
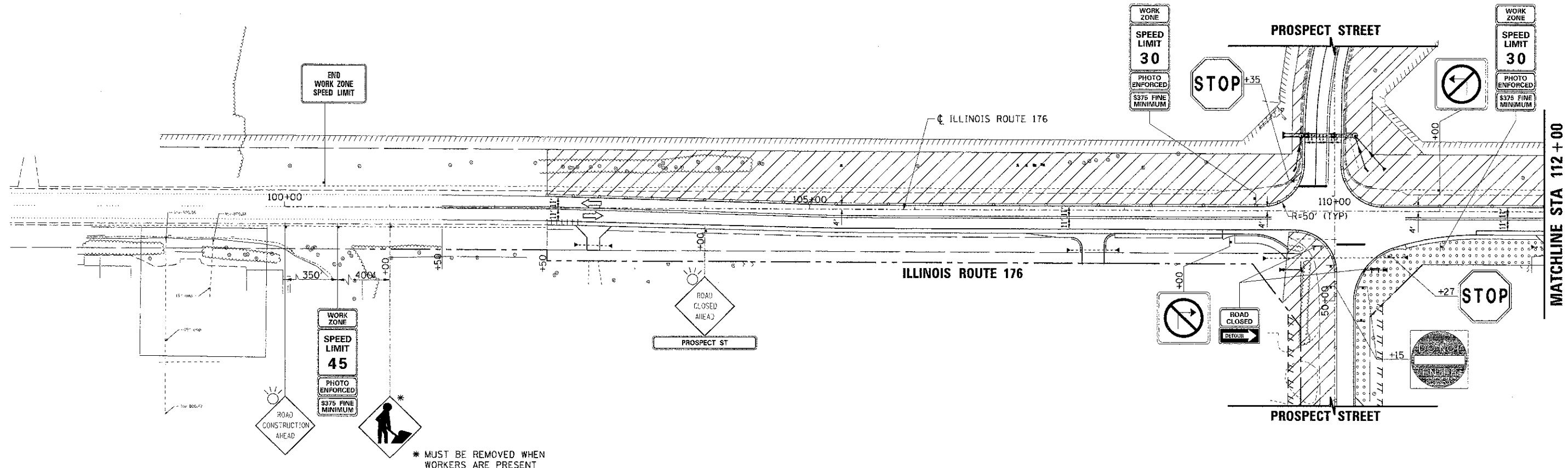

LEGEND

WORK ZONE AREA	PROVIDE 10' GAPS IN CURB & GUTTER FOR DRAINAGE
DRUM OR BARRICADE WITH STEADY BI-DIRECTIONAL LIGHT *	* DRUM OR BARRICADE SPACING: 50' C-C TANGENTS 20' C-C TAPERS OR LANE SHIFTS 25' C-C RADII
SIGN ON PORTABLE OR PERMANENT SUPPORT	
TYPE III BARRICADES WITH TWO (2) FLASHING LIGHTS	

USER NAME = sperral	DESIGNED DCJ	REVISED -
	DRAWN SMP	REVISED -
	CHECKED TEH	REVISED -
	DATE 2/5/13	REVISED -

**STATE OF ILLINOIS
DEPARTMENT OF TRANSPORTATION**

**SUGGESTED MAINTENANCE OF TRAFFIC - STAGE 2
ILLINOIS ROUTE 176**

SCALE: 1" = 50' SHEET NO. 10 OF 10 SHEETS STA. 102+50.00 TO STA. 117+75.00

F.A.I.L. RTE. 4087	SECTION 98-0024-00-WR	COUNTY MCHENRY	TOTAL SHEETS 115	SHEET NO. 41
FED. ROAD DIST. NO. ILLINOIS FED. AID PROJECT			CONTRACT NO. 63532	