

LEGEND

- EXISTING RIGHT-OF-WAY
- EXISTING PERMANENT EASEMENT
- PROPOSED RIGHT-OF-WAY
- PROPOSED TEMPORARY EASEMENT
- PRC FES
- PRECAST REINFORCED CONCRETE FLARED END SECTION
- PCUL-CL-A1 PIPE CULVERTS, CLASS A, TYPE 1
- SS-CL-A1 STORM SEWERS, CLASS A, TYPE 1
- SS-CL-A2 STORM SEWERS, CLASS A, TYPE 2
- INLETS TA INLETS, TYPE A
- CB TA CATCH BASINS, TYPE A
- CB TC CATCH BASINS, TYPE C
- MH TA MANHOLES, TYPE A
- T1F CL TYPE 1 FRAME, CLOSED LID
- T8G TYPE 8 GRATE
- T11 F&G TYPE 11 FRAME & GRATE
- T24 F&G TYPE 24 FRAME & GRATE

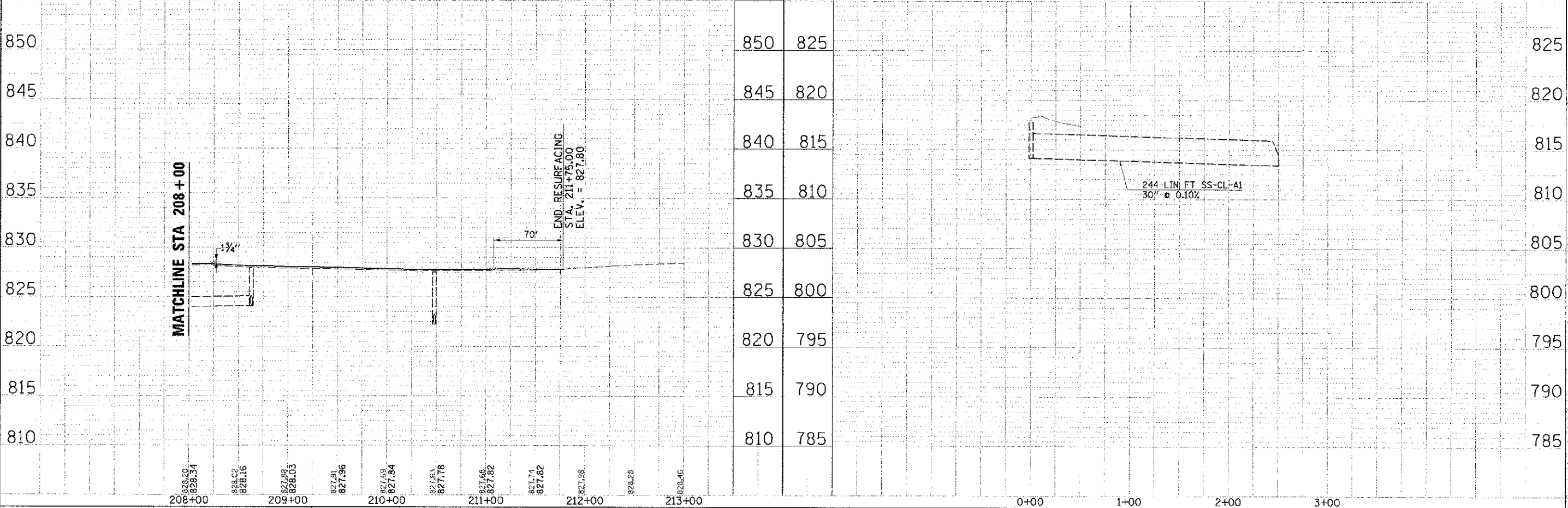

PLAN

DATE	BY
REVISIONS	DATE
1	
2	
3	

PROFILE

DATE	BY
REVISIONS	DATE
1	
2	
3	

COMPANY NAME: HRGreen.com
 PROJECT CONTACT: [Name]
 DATE: 2/21/2013
 FILE NAME: 636-aroad2-1020-00-00
 PLOT DRIVER: pldrvr.plt
 PEN TABLE: s:\pen\of-frames.tbl

DESIGNED	DCJ	REVISIONS	-
DRAWN	SMP	REVISIONS	-
CHECKED	TEH	REVISIONS	-
DATE	2/5/13	REVISIONS	-

**STATE OF ILLINOIS
 DEPARTMENT OF TRANSPORTATION**

**DRAINAGE PLAN AND PROFILE
 U.S. ROUTE 20 STORM SEWER OUTFALL**

F.A.U. RTE.	SECTION	COUNTY	TOTAL SHEETS	SHEET NO.
4087	98-0024-00-WR	MCHENRY	115	44
CONTRACT NO.			63532	

SCALE: 1" = 50' SHEET NO. 2 OF 6 SHEETS STA. 208+00.00 TO STA. 211+75.00
 FED. ROAD DIST. NO. ILLINOIS FED. AID PROJECT