

DATE	
BY	
REVISIONS	
1. PLOTTED	
2. CHECKED	
3. APPROVED	
4. DATE	
5. FILE NAME	
6. PLOT FILE NAME	

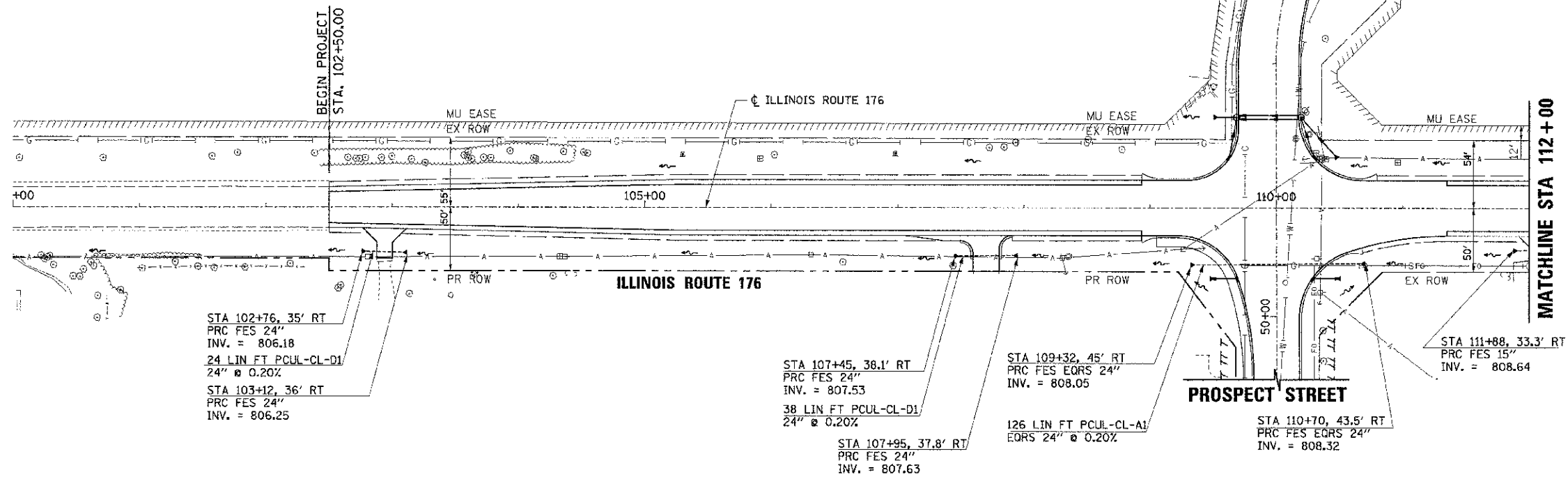

LEGEND	
	EXISTING RIGHT-OF-WAY
	EXISTING PERMANENT EASEMENT
	PROPOSED RIGHT-OF-WAY
	PROPOSED TEMPORARY EASEMENT
	PRECAST REINFORCED CONCRETE FLARED END SECTION
	PCUL-CL-A1 PIPE CULVERTS, CLASS A, TYPE 1
	SS-CL-A1 STORM SEWERS, CLASS A, TYPE 1
	SS-CL-A2 STORM SEWERS, CLASS A, TYPE 2
	INLETS TA INLETS, TYPE A
	CB TA CATCH BASINS, TYPE A
	CB TC CATCH BASINS, TYPE C
	MH TA MANHOLES, TYPE A
	T1F CL TYPE 1 FRAME, CLOSED LID
	T8G TYPE 8 GRATE
	T11 F&G TYPE 11 FRAME & GRATE
	T24 F&G TYPE 24 FRAME & GRATE

DATE	
BY	
REVISIONS	
1. PLOTTED	
2. CHECKED	
3. APPROVED	
4. DATE	
5. FILE NAME	
6. PLOT FILE NAME	

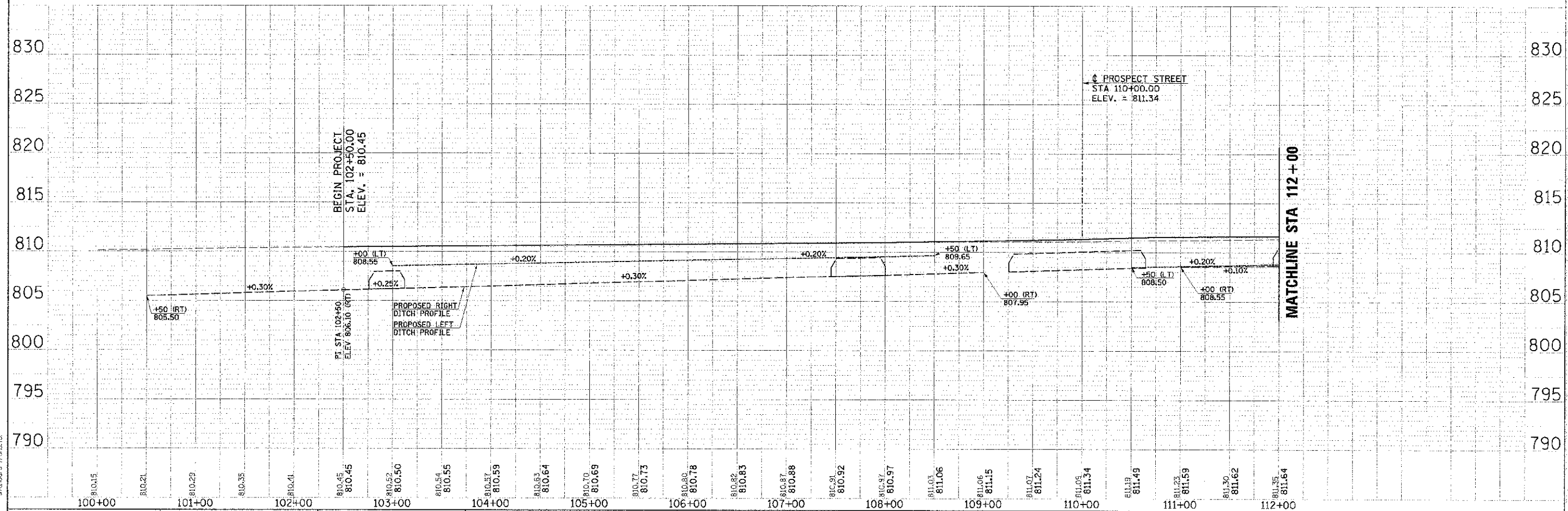

COMPANY NAME: HRGreen

PROJECT CONTACT: HRGreen.com

DATE PLOTTED: 2/21/2013 10:24 AM

FILE NAME: 616-drainage-176.dwg

PLT DRIVER: data\_xout

PEN TABLE: standard-trans.tbl

	DESIGNED DCJ	REVISIONS -	<b>STATE OF ILLINOIS</b> <b>DEPARTMENT OF TRANSPORTATION</b>	<b>DRAINAGE PLAN AND PROFILE</b> <b>ILLINOIS ROUTE 176</b>	F.A.U. 4087	SECTION 98-C024-00-WR	COUNTY MCHENRY	TOTAL SHEETS 15	SHEET NO. 47
	PL0" SCALE = 1" = 50' PL0" DATE = 2/21/2013	CHECKED - TEH DATE - 2/3/13			REVISIONS - REVISIONS - REVISIONS -	SCALE: 1" = 50' SHEET NO. 5 OF 6 SHEETS STA. 102+50.00 TO STA. 112+00.00	CONTRACT NO. 63532 ILLINOIS FED. AID PROJECT		