

LEGEND

- DRUM WITH STEADY BURN MONO DIRECTION LIGHT
- ← DIRECTION OF TRAFFIC

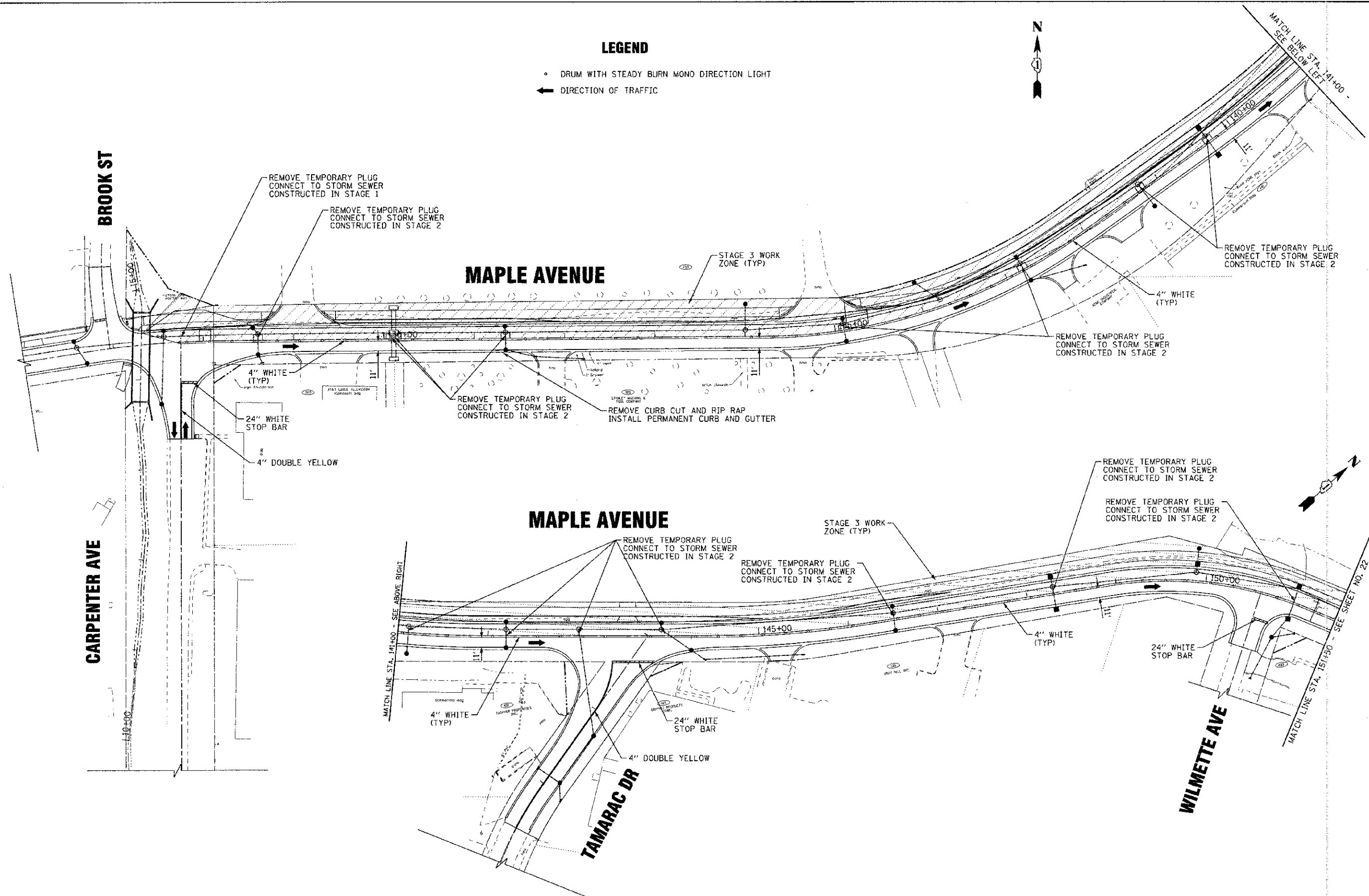

COPYRIGHT © 2012 BY RACER & WOODMAN, INC.
 STATE OF ILLINOIS, PROFESSIONAL DESIGN FIRM
 LICENSE NO. 061-00001, CONTRACT 4730/PV01
 PROJECT NO. 95-00049-00-PV, SHEET 21
 FILED: 06/20/12



DESIGNED -	DJS	REVISED -	PER IDOT 10/19/12
DRAWN -	LRB	REVISED -	
CHECKED -	RWL	REVISED -	
DATE -	06/20/12	FILE -	110954-MTS3-1.sht

STATE OF ILLINOIS
DEPARTMENT OF TRANSPORTATION

SUGGESTED MAINTENANCE OF TRAFFIC
STAGE 3
MAPLE AVENUE

SCALE: 1" = 50'

STA. 141+00 TO STA. 151+50

F.A.I.L. RTE.	SECTION	COUNTY	TOTAL SHEETS	SHEET NO.
4006	95-00049-00-PV	KANE	138	21
CONTRACT NO. 63745				
FED. ROAD DIST. NO. 1 ILLINOIS FED. AID PROJECT N-6003 (095)				