

MAPLE AVENUE

PROP. CURVE MAPLE-CL-6
 PI STA. = 155+06.16
 Δ = 13° 57' 53" (LT)
 D = 7° 09' 45"
 R = 799.95'
 T = 97.97'
 L = 194.97'
 E = 5.98'
 e = NC
 T.R. = NA
 S.E. RUN = NA
 P.C. STA = 154+08.19
 P.T. STA = 156+03.16

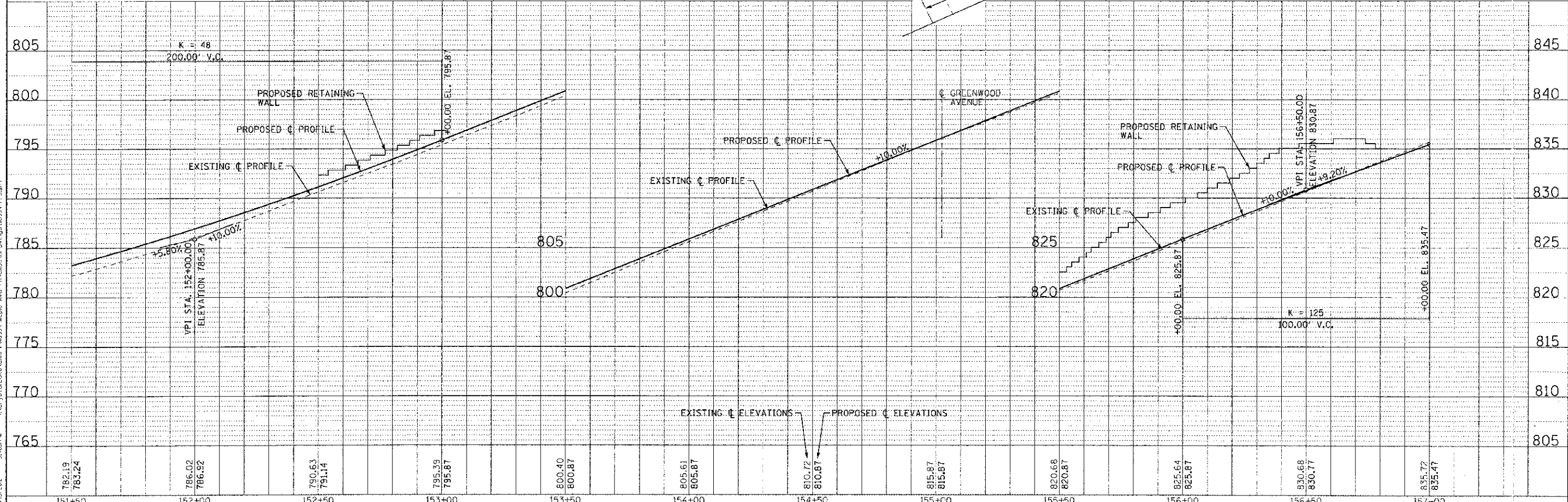

DESIGNED BY: DANIEL A. WOODMAN, INC.
 STATE OF ILLINOIS
 LICENSE NO. 184-0021 - EXPIRES 7/31/2013
 1100 West Lake County Road 100, Joliet, IL 61734
 815-726-1200
 12/29/2012 3:46:58 PM

DESIGNED - DJS	REVISED - PER 1007 10/19/12
DRAWN - LKB	REVISED -
CHECKED - RWL	REVISED -
DATE - 06/20/12	FILE - 110994-PP9.sht

**STATE OF ILLINOIS
 DEPARTMENT OF TRANSPORTATION**

**GEOMETRIC PLAN AND PROFILE
 MAPLE AVENUE**

SCALE: H: 1"=20' V: 1"=5'
 STA. 151+50 TO STA. 157+00

F.A. RTE. 4006	SECTION 95-00049-00-PV	COUNTY KANE	TOTAL SHEETS 138	SHEET NO. 31
FED. ROAD DIST. NO. ILLINOIS FED. AID PROJECT W-8003 (0995)			CONTRACT NO. 63745	