

MAPLE AVENUE

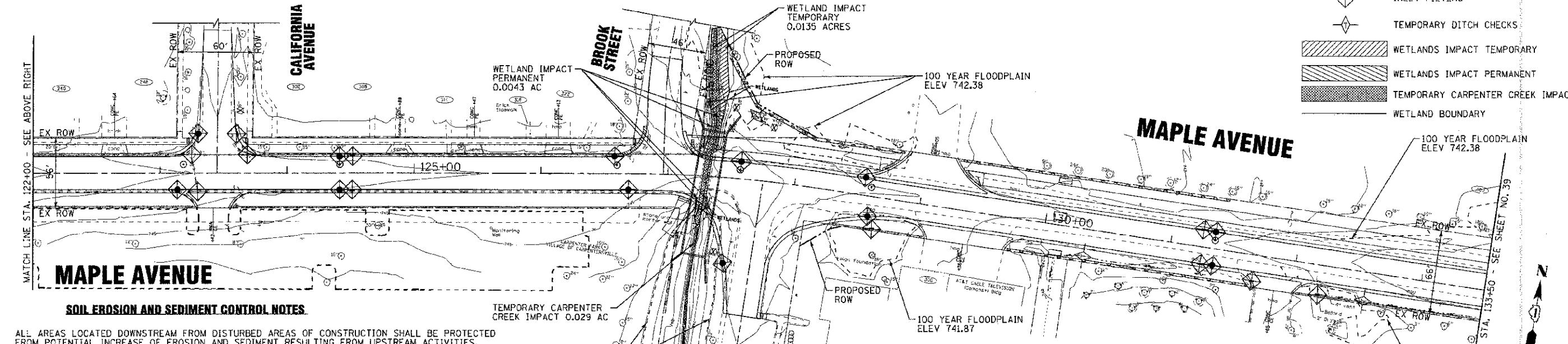

MAPLE AVENUE

SOIL EROSION AND SEDIMENT CONTROL NOTES

- A. ALL AREAS LOCATED DOWNSTREAM FROM DISTURBED AREAS OF CONSTRUCTION SHALL BE PROTECTED FROM POTENTIAL INCREASE OF EROSION AND SEDIMENT RESULTING FROM UPSTREAM ACTIVITIES.
- B. SOIL DISTURBANCE SHALL BE CONDUCTED IN SUCH A MANNER AS TO MINIMIZE EROSION. AREA OF CONSTRUCTION SITE THAT ARE NOT TO BE GRADED SHALL BE PROTECTED FROM CONSTRUCTION TRAFFIC OR OTHER DISTURBANCE UNTIL FINAL SEEDING IS PERFORMED.
- C. SOIL EROSION AND SEDIMENT CONTROL FEATURES SHALL BE CONSTRUCTED AND FUNCTIONAL PRIOR TO THE START OF DISTURBANCE.
- D. STABILIZATION MEASURES SHALL BE INITIATED AS SOON AS PRACTICAL IN PORTIONS OF THE SITE WHERE CONSTRUCTION ACTIVITIES HAVE TEMPORARILY OR PERMANENTLY CEASED; BUT IN NO CASE SHALL THESE MEASURES BE INSTALLED MORE THAN 7 DAYS AFTER THE CONSTRUCTION IN THIS AREA TEMPORARILY OR PERMANENTLY CEASES.
- E. ALL STORM SEWER STRUCTURES THAT RECEIVE RUNOFF DURING CONSTRUCTION SHALL INCLUDE INLET PROTECTION FILTERS TO PREVENT DEBRIS AND EXCESSIVE SEDIMENT FROM ENTERING THE STORM SEWER SYSTEM. THESE PROTECTIVE MEASURES SHALL BE PROPERLY INSTALLED, MAINTAINED, AND REMOVED IN THEIR ENTIRETY AFTER THE AREA TRIBUTARY TO THE STORM STRUCTURE IS STABILIZED.
- F. DISCHARGES FROM DEWATERING OPERATIONS SHALL ENTER OR BE ROUTED THROUGH A SEDIMENT BAG OR OTHER EROSION CONTROL DEVICE APPROVED BY THE ENGINEER PRIOR TO DISCHARGE.
- G. ALL TEMPORARY EROSION AND SEDIMENT CONTROL MEASURES SHALL BE REMOVED WITHIN 30 DAYS AFTER FINAL SITE STABILIZATION IS ACHIEVED OR AFTER THE TEMPORARY MEASURES ARE NO LONGER NEEDED. TRAPPED SEDIMENT SHALL BE PROPERLY STABILIZED OR DISPOSED.
- H. REPAIR, REPLACE OR MAINTAIN EROSION AND SEDIMENT CONTROL STRUCTURES AFTER A RAINFALL EVENT OF 1/2 INCH OR MORE OVER A 24-HOUR PERIOD AND ON A BIWEEKLY BASIS AS A MINIMUM.
- I. MAKE ADJUSTMENTS TO THE SEDIMENTATION AND EROSION CONTROL PLAN AND METHODS, AS NEEDED, TO ACCOMPLISH THE INTENDED PURPOSE.
- J. ALL ADJACENT ROADWAYS MUST BE KEPT CLEAR OF DEBRIS, INSPECTED DAILY, AND CLEANED WHEN NECESSARY OR AS DETERMINED BY THE VILLAGE OF CARPENTERSVILLE OR THE ENGINEER.

SOIL EROSION AND SEDIMENT CONTROL NOTES CONT.

- K. THE CONTRACTOR SHALL NOT CAUSE OR PERMIT THE DUMPING, DEPOSITING, DROPPING, THROWING, DISCARDING OR LEAVING OF CONSTRUCTION MATERIAL AND/OR DEBRIS UPON LOCATIONS MEANT TO CONVEY SITE DRAINAGE.
- L. IF THE CONTRACTOR IS NOTIFIED BY THE ENGINEER OF AN EROSION AND SEDIMENT CONTROL DEFICIENCY, THE DEFICIENCY MUST BE CORRECTED WITHIN 24-HOURS OF BEING NOTIFIED.
- M. NO STOCKPILING OF MATERIAL ALLOWED IN THE FLOODPLAIN.
- N. THE CONTRACTOR SHALL CONTACT THE U.S. ARMY CORPS OF ENGINEERS (ACOE), CHICAGO DISTRICT AT 312-846-5532 PRIOR BEGINNING WORK WITHIN A WATERWAY. THE MEANS AND METHODS FOR COMPLETING WORK WITHIN A WATERWAY MUST BE APPROVED BY ACOE PRIOR TO COMMENCEMENT OF WORK. ACOE WILL APPROVE PLANS TO ENSURE EROSION CONTROL STANDARDS ONLY. ALL WORK NEEDED TO SATISFY ACOE REQUIREMENTS SHALL BE INCLUDED IN THE COST FOR REMOVING EXISTING STRUCTURES.
- O. WORK WITHIN A WATERWAY SHALL BE TIMED TO TAKE PLACE DURING LOW OR NO-FLOW CONDITIONS. NO EQUIPMENT SHALL ENTER THE WATER AT ANY TIME.
- Q. IF BYPASS PUMPING IS NECESSARY, THE PUMP SHALL BE PLACED ON A STABLE SURFACE OR FLOATED TO PREVENT SEDIMENT FROM BEING SUCKED INTO THE HOSE. THE BYPASS DISCHARGE SHALL BE PLACED ON A NON-ERODIBLE, ENERGY DISSIPATING SURFACE PRIOR TO REJOINING THE STREAM FLOW AND SHALL NOT CAUSE EROSION OF DOWNSTREAM AREAS. CLEANING OR FILTERING OF BYPASS WATER IS NOT NECESSARY UNLESS OTHERWISE REQUIRED.
- R. SIDE SLOPES SHALL BE RESEEDED AND STABILIZED WITH AN APPROPRIATE EROSION CONTROL BLANKET PRIOR TO ACCEPTING FLOWS. THE SUBSTRATE SHALL BE RESTORED TO PRE-CONSTRUCTION CONDITIONS AND STABLE ENOUGH TO ACCEPT FLOWS.
- S. WHERE STREAM DISTURBANCE IS NECESSARY, THE STREAM BED AND BANKS, SHALL BE RESTABILIZED WITHIN FORTY-EIGHT (48) HOURS AFTER DISTURBANCE IS COMPLETE OR INTERRUPTED.
- T. THE CONTRACTOR AND ENGINEER SHALL MEET WITH THE KANE-DUPAGE SOIL AND WATER CONSERVATION DISTRICT TO COORDINATE ALL IN-STREAM WORK ACTIVITIES. THE CONTRACTOR'S IN-STREAM WORK PLAN SHALL BE SUBMITTED TO THE SOIL AND WATER CONSERVATION DISTRICT FOR REVIEW AND APPROVAL PRIOR TO STARTING ANY WORK.

LEGEND

- PERIMETER EROSION BARRIER
- INLET FILTERS
- TEMPORARY DITCH CHECKS
- WETLANDS IMPACT TEMPORARY
- WETLANDS IMPACT PERMANENT
- TEMPORARY CARPENTER CREEK IMPACT
- WETLAND BOUNDARY

DESIGNED - DJS	REVISED - PER IDOT 10/19/12
DRAWN - LKB	REVISED -
CHECKED - RWL	REVISED -
DATE - 06/20/12	FILE - 110994-EROSI.sht

STATE OF ILLINOIS
DEPARTMENT OF TRANSPORTATION

EROSION CONTROL PLAN

SCALE: 1"=40'
STA. 110+50 TO STA. 133+50

F.A.U. R.I.E. 4006	SECTION 95-00049-00-PV	COUNTY KANE	TOTAL SHEETS 138	SHEET NO. 38
FED. ROAD DIST. NO. 1 ILLINOIS FED. AID PROJECT M-603 10951			CONTRACT NO. 63745	

COPYRIGHT © 2002 BY BAXTER & WOODMAN, INC.
 STATE OF ILLINOIS, PROFESSIONAL DESIGN FIRM
 LICENSE NO. 06-00777-0001
 215 S. WASHINGTON ST., CHICAGO, IL 60604
 TEL: 312.467.1000 FAX: 312.467.1001
 WWW.BAXTERANDWOODMAN.COM