

### MAPLE AVENUE

NO.	TYPE	TY	DIA (IN)	LENGTH (FT)	SLOPE	TBF (CY)
P-7	STORM SEWERS, CLASS A RUBBER GASKET	1	12	20	0.75%	6
P-8	STORM SEWERS, CLASS A RUBBER GASKET	1	15	6	1.67%	2
P-9	STORM SEWERS, CLASS A RUBBER GASKET	1	12	8	0.62%	3
P-10	STORM SEWERS, CLASS A RUBBER GASKET	1	24	80	0.41%	62
P-11	STORM SEWERS, CLASS A RUBBER GASKET	1	12	20	0.75%	6
P-12	STORM SEWERS, CLASS A RUBBER GASKET	1	12	7	0.86%	2
P-13	STORM SEWERS, CLASS A RUBBER GASKET	2	24	204	0.40%	161
P-14	STORM SEWERS, CLASS A RUBBER GASKET	2	24	20	0.75%	20
P-15	STORM SEWERS, CLASS A RUBBER GASKET	1	12	6	0.83%	2
P-16	STORM SEWERS, CLASS A RUBBER GASKET	2	24	76	0.87%	76
P-16A	STORM SEWERS, CLASS A RUBBER GASKET	2	24	12	0.42%	0
P-16B	STORM SEWERS, CLASS A RUBBER GASKET	2	24	96	0.40%	207
P-17	STORM SEWERS, CLASS A RUBBER GASKET	1	12	7	0.71%	2
P-18	STORM SEWERS (WATER MAIN REQUIREMENTS)	1	12	146	0.79%	38

LABEL	STATION	OFFSET (FT)	TYPE	FRAME	ELEVATION	RIM/EP	Elevation (invert) (ft)
S-7	116+63	13'	RT CATCH BASIN TYPE C	T-24 F&G	749.53	EP	746.35 12"N
S-8	116+63	7'	LT MANHOLE TYPE A, 5DIA	T-1 F, C.L	749.93	RIM	745.00 24"E; 745.50 18"W; 746.00 15"N; 746.20 12"S
S-9	116+62	13'	LT CATCH BASIN TYPE A, 4'DIA	T-24 F&G	750.06	EP	746.50 15"W; 746.85 12"E
S-10	116+71	14'	LT INLET TYPE A	T-24 F&G	750.07	EP	746.90 12"W
S-11	117+42	13'	RT CATCH BASIN TYPE C	T-24 F&G	749.70	EP	746.50 12"N
S-12	117+42	7'	LT MANHOLE TYPE A, 5DIA	T-1 F, C.L	750.10	RIM	744.58 24"E; 744.68 24"W; 746.84 12"N; 746.35 12"S
S-13	117+42	13'	LT CATCH BASIN TYPE C	T-24 F&G	750.22	EP	747.00 12"S
S-14	119+47	13'	RT CATCH BASIN TYPE A, 5'DIA	T-24 F&G	749.91	EP	742.94 24"SE; 743.50 24"N
S-14A	120+11	53'	RT MANHOLE TYPE A, 6DIA	T-1 F, C.L	747.95	RIM	737.06 24"SE; 737.16 24"N; 742.29 24"NW
S-14B	120+00	43'	LT MANHOLE TYPE A, 5DIA	T-1 F, C.L	750.42	RIM	737.54 24"S
S-15	119+46	7'	LT MANHOLE TYPE A, 5DIA	T-1 F, C.L	749.81	RIM	743.65 24"S; 743.75 24"W; 746.70 12"N
S-16	119+46	13'	LT CATCH BASIN TYPE C	T-24 F&G	749.93	EP	746.75 12"S
S-17	120+29	7'	LT MANHOLE TYPE A, 4DIA	T-1 F, C.L	749.39	RIM	746.12 12"E; 746.22 12"N
S-18	120+29	13'	LT CATCH BASIN TYPE C	T-24 F&G	749.44	EP	746.27 12"S

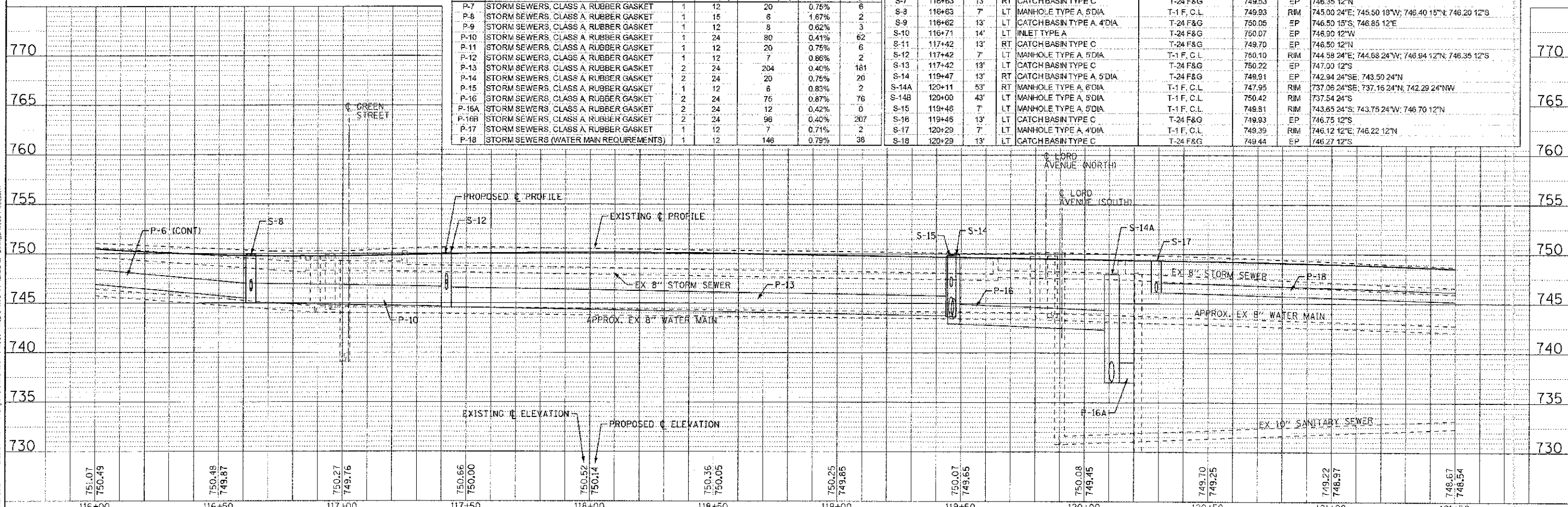

CONSULT: 012 BY: BAXTER A. WOODMAN AS  
 STATE OF ILLINOIS - ROAD DESIGN DIVISION  
 PROJECT NO. 95-0049-00-00-00-00-00-00  
 DATE: 06/20/12

	DESIGNED - AMW	REVISED - PER 10/19/12	<b>STATE OF ILLINOIS</b> <b>DEPARTMENT OF TRANSPORTATION</b>	<b>DRAINAGE AND UTILITY</b> <b>MAPLE AVENUE</b>		F.A. RTE. 4006	SECTION 95-0049-00-PV	COUNTY KANE	TOTAL SHEETS 138	SHEET NO. 42
	DRAWN - JKB	REVISED		SCALE: H: 1"=70' V: 1"=5'	STA. 116+00 TO STA. 121+50	FED. ROAD DIST. NO. 1	ILLINOIS FED. AID PROJECT M-8003 (095)	CONTRACT NO. 63745		
	CHECKED - JWL	REVISED								
	DATE - 06/20/12	FILE - 110994-DU2.sht								