

LABEL	STATION	OFFSET (FT)	TYPE	FRAME	ELEVATION	RIM/EP	Elevation (invert) (ft)
S-96	152+51	7'	LT MANHOLE TYPE A, 4 DIA	T-1 F, C.L.	790.99	RIM	786.50 15°SW; 787.74 15°NE
S-97	153+50	13'	LT INLETS, SPECIAL NO. 2		809.61	EP	794.70 16°SW; 797.36 16°NE; 797.30 12°SE
S-98	153+51	13'	RT INLETS, SPECIAL NO. 2		800.61	EP	797.50 12°NW
S-99	154+00	7'	LT MANHOLE TYPE A, 4 DIA	T-1 F, C.L.	805.61	RIM	800.00 15°SW; 802.25 12°NW; 802.78 12°NE
S-100	154+00	34'	RT CATCH BASIN TYPE C	T-8 G	805.66	RIM	802.50 12°SE
S-100A	154+25	25'	RT FLARED END SECTION 15"				806.42 15°NE
S-101	154+88	13'	LT MANHOLE TYPE A, 4 DIA	T-1 F, C.L.	814.41	EP	811.58 12°NE; 809.80 12°SW
S-101A	154+51	13'	RT INLETS, SPECIAL NO. 2		810.61	EP	807.00 16°SW; 807.17 16°NE
S-102	155+50	13'	LT INLETS, SPECIAL NO. 2		820.61	EP	817.40 12°SE
S-103	155+50	9.5'	LT MANHOLE TYPE A, 4 DIA	T-1 F, C.L.	820.69	RIM	817.86 12°NE; 815.75 12°SW; 817.86 12°NW
S-104	155+50	13'	RT INLETS, SPECIAL NO. 1		820.61	EP	813.98 15°SW; 817.05 15°NE
S-105	155+60	13'	RT INLET TYPE B	T-24 F&G	821.61	EP	817.15 16°SW
S-106	156+39	7'	LT MANHOLE TYPE A, 4 DIA	T-1 F, C.L.	829.67	RIM	826.84 12°NE; 826.74 12°SW

NO.	TYPE	TY	DIA (IN)	LENGTH (FT)	SLOPE	TBF (CY)
P-96	STORM SEWERS, CLASS A, RUBBER GASKET	1	15	100	6.96%	66
P-97	STORM SEWERS, CLASS A, RUBBER GASKET	1	12	32	0.63%	9
P-98	STORM SEWERS, CLASS A, RUBBER GASKET	1	15	51	5.18%	21
P-99	STORM SEWERS, CLASS A, RUBBER GASKET	1	12	27	0.93%	8
P-100	STORM SEWERS, CLASS A, RUBBER GASKET	1	12	88	7.98%	29
P-100A	STORM SEWERS (WATER MAIN REQUIREMENTS)	1	15	29	2.00%	8
P-101	STORM SEWERS, CLASS A, RUBBER GASKET	1	12	60	6.95%	20
P-101A	STORM SEWERS (WATER MAIN REQUIREMENTS)	1	15	100	6.81%	72
P-102	STORM SEWERS, CLASS A, RUBBER GASKET	1	12	5	1.00%	2
P-103	STORM SEWERS (WATER MAIN REQUIREMENTS)	1	15	10	1.00%	4
P-104	STORM SEWERS, CLASS A, RUBBER GASKET	1	12	89	9.98%	20
P-106	STORM SEWERS, CLASS A, RUBBER GASKET	1	12	94	9.05%	21

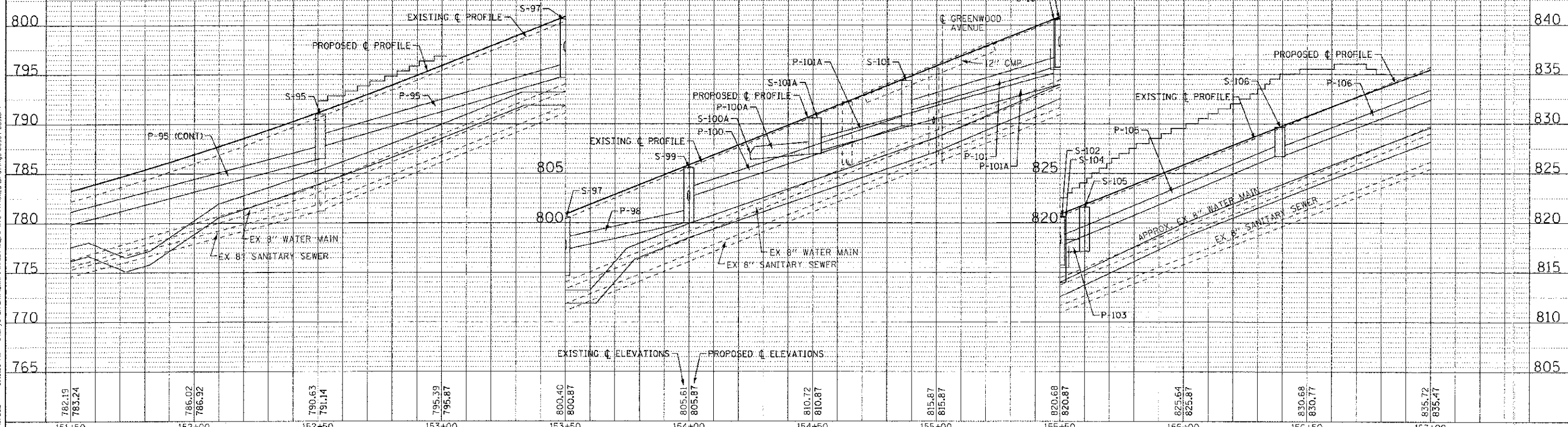

	DESIGNED - AMM	REVISED - PER IDOT 10/19/12	STATE OF ILLINOIS DEPARTMENT OF TRANSPORTATION DRAINAGE AND UTILITY MAPLE AVENUE	F.A. RTE.	SECTION	COUNTY	TOTAL SHEET NO.
	DRAWN - UKB	REVISED		4006	95 00049 00-PV	KANE	138 49
	CHECKED - RWL	REVISED		CONTRACT NO. 63745			
	DATE - 06/20/12	FILE - 110994-DU9.sht		FED. ROAD DIST. NO. 1 ILLINOIS FED. AID PROJECT W-8003 (095)			

COPYRIGHT © 2012 BY DEXTER WOODMAN CONSULTING ENGINEERS, INC. ALL RIGHTS RESERVED. THIS DOCUMENT IS THE PROPERTY OF DEXTER WOODMAN CONSULTING ENGINEERS, INC. AND IS NOT TO BE REPRODUCED OR TRANSMITTED IN ANY FORM OR BY ANY MEANS, ELECTRONIC OR MECHANICAL, WITHOUT THE WRITTEN PERMISSION OF DEXTER WOODMAN CONSULTING ENGINEERS, INC.