

REPLACE EXISTING 8" SANITARY SEWER WITH 26 LF OF 8" WATER MAIN QUALITY PIPE SANITARY SEWER, FROM MANHOLE TO CUT END OF EXISTING PIPE, MATCH EXISTING LOCATION AND SLOPE OF PIPE, AND CONNECT TO EXISTING 8" SANITARY SEWER

REMOVE EXISTING ECCENTRIC CONE AND REMOVE EXISTING REMAINING MANHOLE STEPS, ADD A 12" TALL MANHOLE SECTION TO MANHOLE, REINSTALL EXISTING ECCENTRIC CONE WITH OPENING AND STEPS TO NORTHWESTERLY SIDE OF MANHOLE. INSTALL NEW MANHOLE STEPS IN DRILLED HOLES LOCATED BELOW STEPS IN ECCENTRIC CONE (16" SPACING AND ON NORTHWEST SIDE OF MANHOLE). INSTALL MANHOLE FRAME ADJUSTING RINGS AS REQUIRED, AND REINSTALL EXISTING FRAME AND COVER BEHIND CURB.

NOTE: INSTALL PROPOSED 16" WATER MAIN BELOW EXISTING WATER MAIN PIPES, FIRE HYDRANT LEADER PIPES, WATER SERVICE PIPES, AND SANITARY SEWER PIPES BETWEEN STA. 142+50 AND STA. 146+25

WATER MAIN PIPES			
NO.	LENGTH (LFT)	DIA (IN.)	INSTALLATION METHOD
WM-P15	16	6 RJT	OPEN CUT
WM-P16	556	16 RJT	H.D.D.
WM-P17	20	8 RJT	OPEN CUT
WM-P18	20	6 RJT	OPEN CUT
WM-P19	20	6 RJT	OPEN CUT

- NOTES:
1. LOCATION AND SIZE OF WATER SERVICE LINES TO BE DETERMINED IN THE FIELD AT THE TIME OF CONSTRUCTION. ANTICIPATED QUANTITY AND SIZES OF WATER SERVICE LINES: 3 SERVICE LINES WITH 6" PIPE, FITTINGS, AND VALVES; 1 - 1-1/2" SAME SIDE.
 2. IT IS ANTICIPATED THERE MAY BE 3 SANITARY SEWER SERVICES WITHIN MAPLE AVENUE RIGHT-OF-WAY SHOWN ON THIS SHEET.

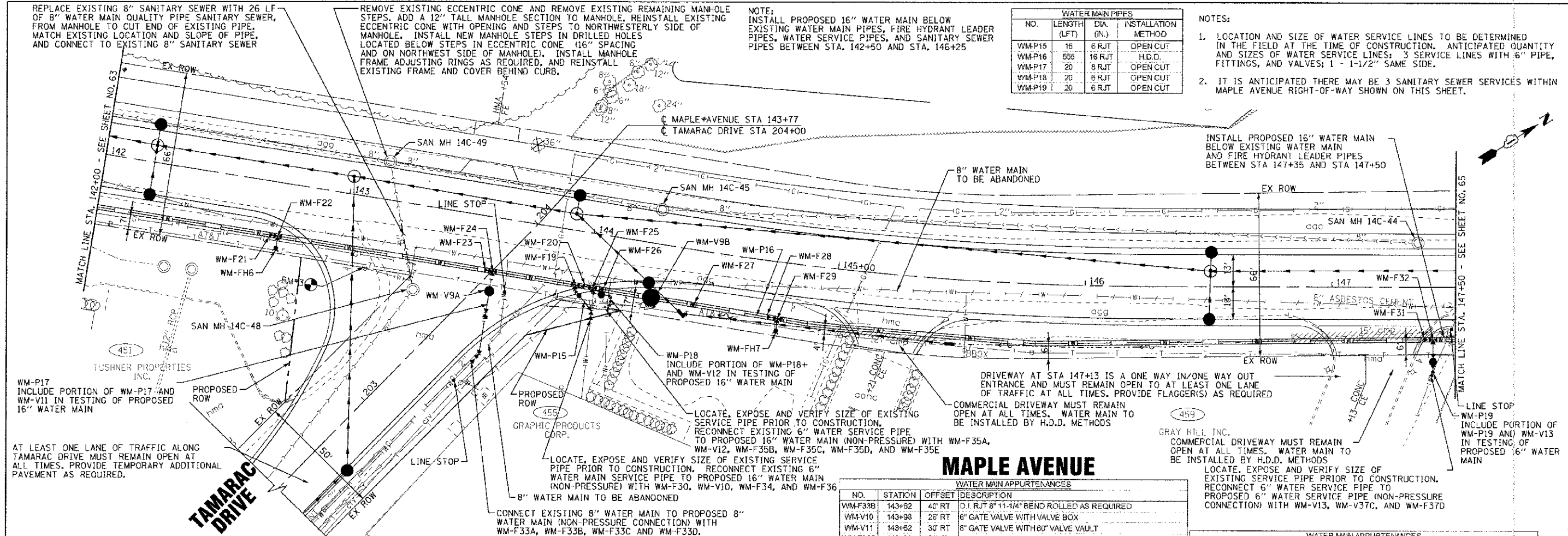

WATER MAIN APPURTENANCES			
NO.	STATION	OFFSET	DESCRIPTION
WM-F19	143.96	22' RT	D.I. RJT 16" X 6" TEE
WM-F20	143.98	22' RT	D.I. RJT 16" SLEEVE
WM-FH6			NOT USED
WM-F21	142+71	21.5' RT	D.I. RJT 16" SLEEVE
WM-F22	142+74	21.5' RT	D.I. RJT 16" X 6" TEE
WM-FH6	142+90	26.5' RT	FIRE HYDRANT WITH AUXILIARY VALVE AND BOX
WM-F23	143+59	21.5' RT	D.I. RJT 16" SLEEVE
WM-F24	143+82	21.5' RT	D.I. RJT 16" X 8" TEE
WM-F25	144+03	21.5' RT	D.I. RJT 16" X 8" TEE
WM-F26	144+07	21.5' RT	D.I. RJT 16" SLEEVE
WM-V9A	143+62	30' RT	8" GATE VALVE WITH 60" VALVE VAULT

WATER MAIN APPURTENANCES			
NO.	STATION	OFFSET	DESCRIPTION
WM-V9B	144+27	22' RT	16" GATE VALVE WITH 72" VALVE VAULT
WM-F27	144+44	22' RT	D.I. RJT 16" SLEEVE
WM-F28	144+75	23' RT	D.I. RJT 16" SLEEVE
WM-F29	144+78	23' RT	D.I. RJT 16" X 6" TEE
WM-FH7	144+78	28' RT	FIRE HYDRANT WITH AUXILIARY VALVE AND BOX
WM-F30	143+96	22.5' RT	D.I. RJT 6" 45° BEND
WM-F31	147+38	21' RT	D.I. RJT 16" SLEEVE
WM-F32	147+41	21' RT	D.I. RJT 16" X 6" TEE
WM-F33A	143+62	39' RT	D.I. RJT 8" 22-1/2° BEND ROLLED AS REQUIRED WITH CONCRETE THRUST BLOCK

WATER MAIN APPURTENANCES			
NO.	STATION	OFFSET	DESCRIPTION
WM-F33B	143+62	40' RT	D.I. RJT 8" 11-1/4° BEND ROLLED AS REQUIRED
WM-V10	143+98	26' RT	6" GATE VALVE WITH VALVE BOX
WM-V11	143+62	30' RT	6" GATE VALVE WITH 60" VALVE VAULT
WM-F33C	143+62	56' RT	D.I. RJT 8" 45° BEND
WM-F33D	143+60.5	58' RT	D.I. RJT 8" SLEEVE
WM-F34	144+04	31' RT	D.I. RJT 6" 45° BEND WITH CONCRETE THRUST BLOCK
WM-F35A	144+03	24' RT	D.I. RJT 8" 90° BEND
WM-V12	144+07	24' RT	8" GATE VALVE WITH VALVE BOX
WM-F35B	144+11	24' RT	D.I. RJT 8" 90° BEND WITH CONCRETE THRUST BLOCK
WM-F35C	144+11	27' RT	D.I. RJT 8" 11-1/4° BEND WITH CONCRETE THRUST BLOCK
WM-F35D	144+11	28.5' RT	D.I. RJT 8" X 6" REDUCER
WM-F35E	144+11.5	30' RT	D.I. RJT 6" SLEEVE

WATER MAIN APPURTENANCES			
NO.	STATION	OFFSET	DESCRIPTION
WM-F36	144+04	33' RT	D.I. RJT 6" SLEEVE
WM-F37A			NOT USED
WM-F37B			NOT USED
WM-V13	147+41	30' RT	6" GATE VALVE WITH VALVE BOX
WM-F37C	147+41	32' RT	D.I. RJT 8" 22-1/2° BEND WITH CONCRETE THRUST BLOCK
WM-F37D	147+40	34' RT	D.I. RJT 6" SLEEVE

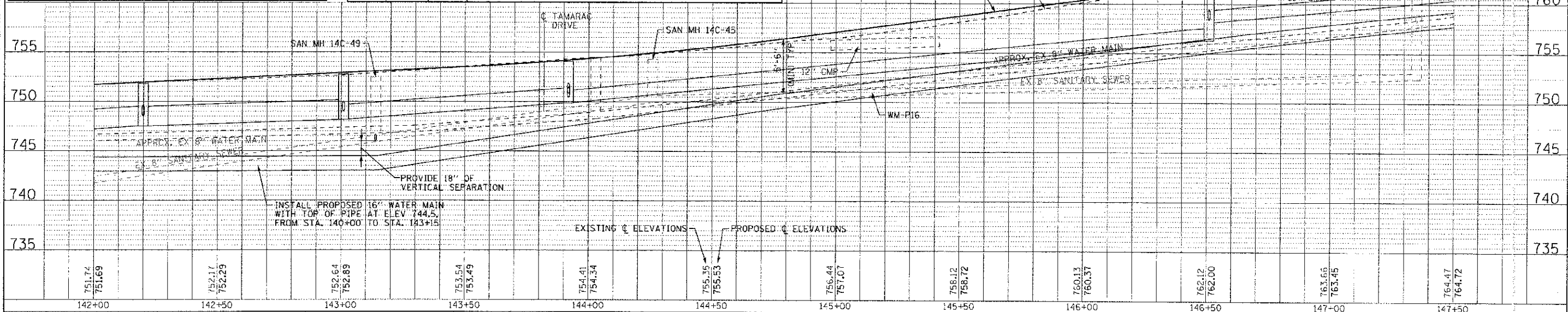

	DESIGNED - SMV	REVISED - PER IDCT 10/19/12	STATE OF ILLINOIS DEPARTMENT OF TRANSPORTATION	WATER MAIN AND SANITARY SEWER MAPLE AVENUE		F.A. R.T.E.	SECTION	COUNTY	TOTAL SHEETS	SHEET NO.
	DRAWN - UKB	REVISED -				4006	95-00049-00-PV	KANE	138	64
	CHECKED - RWL	REVISED -				CONTRACT NO. 63745				
	DATE - 06/20/12	FILE - I10994-WM-PP7.sht				FED. ROAD DIST. NO. 1 ILLINOIS FED. AID PROJECT M-8003-10951				

COPYRIGHT © 2012 BY BAXTER WOODMAN, INC. ALL RIGHTS RESERVED. NO PART OF THIS DOCUMENT IS TO BE REPRODUCED OR TRANSMITTED IN ANY FORM OR BY ANY MEANS, ELECTRONIC OR MECHANICAL, INCLUDING PHOTOCOPYING, RECORDING, OR BY ANY INFORMATION STORAGE AND RETRIEVAL SYSTEM.