

WATER MAIN PIPES			
NO.	LENGTH (L+J)	DIA (IN.)	INSTALLATION METHOD
WM-P20	NOT USED		
WM-P21	90	16 RJT	H.D.D.
WM-P22	65	16 RJT	OPEN CUT
WM-P23	28	16 RJT	OPEN CUT
WM-P24	220	16 RJT	OPEN CUT
WM-P25	NOT USED		
WM-P26	75	8 RJT	OPEN CUT
WM-P27	NOT USED		
WM-P28	20	6 RJT	OPEN CUT

\*\* WATER MAIN INSIDE 30" CASING PIPE

WATER MAIN APPURTENANCES			
NO.	STATION	OFFSET	DESCRIPTION
WM-V14	147+85	20.5' RT	16" GATE VALVE WITH 72" VALVE VAULT
WM-F38	147-62	26' RT	FIRE HYDRANT WITH AUXILIARY VALVE AND BOX
WM-F38	147-62	21' RT	D.I. RJT 16" x 6" TEE
WM-V15	150-62	6.5' RT	16" GATE VALVE WITH 72" VALVE VAULT
WM-F39	150-72	6.5' RT	D.I. RJT 16" x 8" TEE
WM-F40	147-64	21' RT	D.I. RJT 16" SLEEVE
WM-F41	148-56	18' RT	D.I. RJT 16" 45° BEND ROLLED UP
WM-F42	151+06	6.6' RT	D.I. RJT 16" x 6" TEE
WM-F39	151+06	31' RT	FIRE HYDRANT WITH AUXILIARY VALVE AND BOX
WM-F43			NOT USED
WM-V16	150-94	8.5' RT	16" GATE VALVE WITH 72" VALVE VAULT
WM-F44A	150-72	58' RT	D.I. RJT 8" 45° BEND
WM-F44B	150-80	66' RT	D.I. RJT 8" 45° BEND WITH CONCRETE THRUS-BLOCK
WM-V17	150-72	32' RT	8" GATE VALVE WITH 60" VALVE VAULT
WM-F44C	150-80	73' RT	D.I. RJT 8" x 4" REDUCER
WM-F44D	150-80	75' RT	D.I. RJT 4" SLEEVE
WM-F45	148+76	6.5'	D.I. RJT 16" 45° BEND ROLLED DOWN
WM-V18			NOT USED
WM-F46			NOT USED

**NOTES:**

- LOCATION AND SIZE OF WATER SERVICE LINES TO BE DETERMINED IN THE FIELD AT THE TIME OF CONSTRUCTION. ANTICIPATED QUANTITY AND SIZES OF WATER SERVICE LINES: 1" - 1" SAME SIDE.
- IT IS ANTICIPATED THERE MAY BE 1 SANITARY SEWER SERVICE WITHIN THE MAPLE AVENUE RIGHT-OF-WAY SHOWN ON THIS SHEET.

AT LEAST ONE LANE OF TRAFFIC ON WILMETTE AVENUE MUST REMAIN OPEN AT ALL TIMES, OR PROVIDE APPROPRIATE DETOUR ROUTE AND SIGNAGE.  
IF STREET IS KEPT OPEN, PROVIDE TEMPORARY ADDITIONAL PAVEMENT AS REQUIRED.

**MAPLE AVENUE**

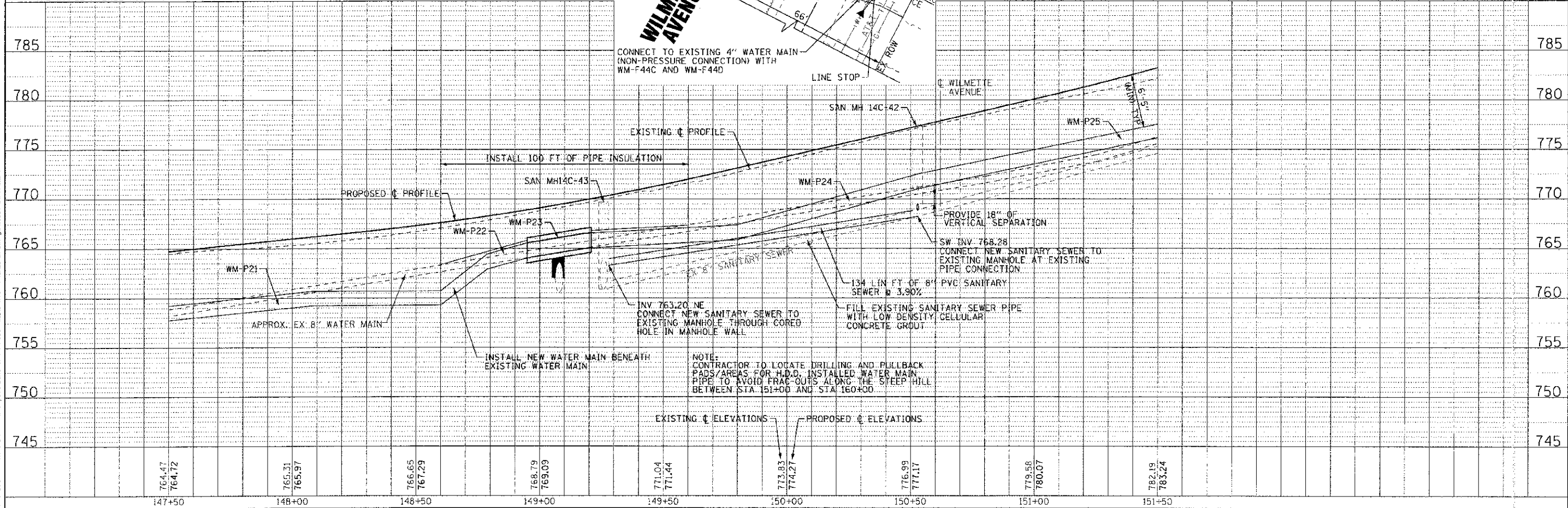

764.47	764.72	765.31	765.97	766.65	767.29	768.79	769.09	771.04	771.44	773.83	774.21	776.99	777.17	779.58	780.07	782.19	783.24
147+50	148+00	148+50	149+00	149+50	150+00	150+50	151+00	151+50									

DESIGNED - SMV	REVISED - PER IDOT 10/19/12
DRAWN - UKB	REVISED
CHECKED - RWL	REVISED
DATE - 06/20/12	FILE - 110594-WM-PP8.S1T

**STATE OF ILLINOIS  
DEPARTMENT OF TRANSPORTATION**

**WATER MAIN AND SANITARY SEWER  
MAPLE AVENUE**

SCALE: H: 1"=20' V: 1"=5'  
STA. 147+50 TO STA. 151+50

F.A. RTE.	SECTION	COUNTY	TOTAL SHEET NO.
4006	95-00049-00-PV	KANE	138 65
FED. ROAD DIST. NO. 1 ILLINOIS FED. AID PROJECT M-8001 (095)			CONTRACT NO. 63745

CONTRACT NO. 63745  
 STATE OF ILLINOIS - PROFESSIONAL LICENSE  
 LICENSE NO. 18-00227 - EXPIRES 4/30/2013  
 02/20/2012

