

WM-P42 WITH TEMPORARY PLUG AT NORTH END OF NEW 8" WATER MAIN. SEE WATER MAIN GENERAL NOTE NO. 35. CONNECT TO EXISTING 8" WATER MAIN (NON-PRESSURE CONNECTION) AFTER PROPOSED 16" AND 8" WATER MAINS HAVE BEEN ACCEPTED FOR USE BY THE VILLAGE OF CARPENTERSVILLE

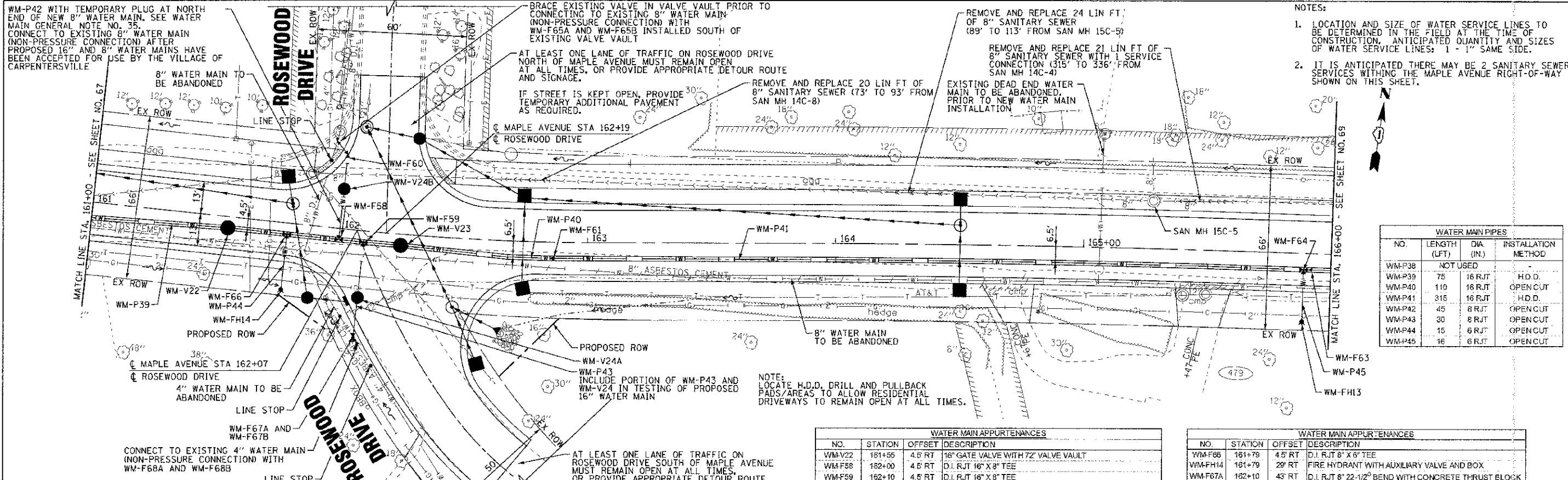

- NOTES:
1. LOCATION AND SIZE OF WATER SERVICE LINES TO BE DETERMINED IN THE FIELD AT THE TIME OF CONSTRUCTION. ANTICIPATED QUANTITY AND SIZES OF WATER SERVICE LINES: 1 - 1" SAME SIDE.
  2. IT IS ANTICIPATED THERE MAY BE 2 SANITARY SEWER SERVICES WITHIN THE MAPLE AVENUE RIGHT-OF-WAY SHOWN ON THIS SHEET.

WATER MAIN PIPES			
NO.	LENGTH (LFT)	DIA (IN.)	INSTALLATION METHOD
WM-P38	NOT USED		
WM-P39	75	16 RJT	H.D.D.
WM-P40	110	16 RJT	OPEN CUT
WM-P41	315	16 RJT	H.D.D.
WM-P42	45	8 RJT	OPEN CUT
WM-P43	30	8 RJT	OPEN CUT
WM-P44	15	6 RJT	OPEN CUT
WM-P45	16	6 RJT	OPEN CUT

WATER MAIN APPURTENANCES			
NO.	STATION	OFFSET	DESCRIPTION
WM-V22	161+05	4.5' RT	16" GATE VALVE WITH 72" VALVE VAULT
WM-F58	162+00	4.5' RT	D.I. RJT 16" X 8" TEE
WM-F59	162+10	4.5' RT	D.I. RJT 16" X 8" TEE
WM-V23	162+25	4.5' RT	16" GATE VALVE WITH 72" VALVE VAULT
WM-F60	162+00	30' LT	D.I. RJT 8" 45° BEND
WM-F61	162+85	6.5' RT	D.I. RJT 16" SLEEVE
WM-F62	-	-	NOT USED
WM-F63	165+91	6.5' RT	D.I. RJT 16" SLEEVE
WM-F64	165+89	6.5' RT	D.I. RJT 16" X 6" TEE
WM-FH13	165+89	27.5' RT	FIRE HYDRANT WITH AUXILIARY VALVE AND BOX
WM-F65A	161+97	33' LT	D.I. RJT 8" 45° BEND WITH CONCRETE THRUST BLOCK
WM-F65B	161+98	34' LT	D.I. RJT 8" SLEEVE

WATER MAIN APPURTENANCES			
NO.	STATION	OFFSET	DESCRIPTION
WM-F66	161+79	4.5' RT	D.I. RJT 8" X 6" TEE
WM-FH14	161+79	29' RT	FIRE HYDRANT WITH AUXILIARY VALVE AND BOX
WM-F67A	162+10	43' RT	D.I. RJT 8" 22-1/2° BEND WITH CONCRETE THRUST BLOCK
WM-F67B	162+11	44' RT	D.I. RJT 8" 11-1/4° BEND WITH CONCRETE THRUST BLOCK
WM-V24A	162+10	27' RT	8" GATE VALVE WITH 60" VALVE VAULT
WM-V24B	162+00	16' LT	8" GATE VALVE WITH 60" VALVE VAULT
WM-F68A	162+11	45' RT	D.I. RJT 8" X 4" REDUCER
WM-F68B	162+12	47' RT	D.I. RJT 4" SLEEVE
WM-F69	-	-	NOT USED
WM-F70	-	-	NOT USED
WM-F71	-	-	NOT USED
WM-F72	-	-	NOT USED

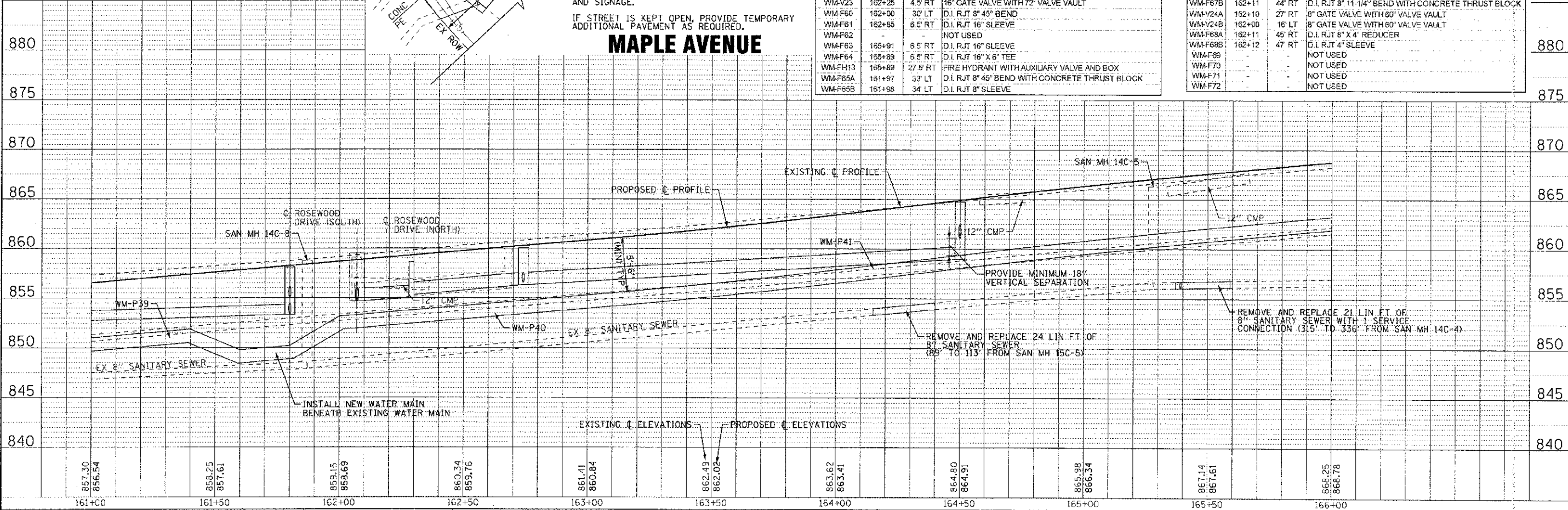

	DESIGNED - SMV	REVISED - PER IDOT 10/19/12	<b>STATE OF ILLINOIS</b> <b>DEPARTMENT OF TRANSPORTATION</b>	<b>WATER MAIN AND SANITARY SEWER</b> <b>MAPLE AVENUE</b>		F.A. RT.:	SECTION	COUNTY	TOTAL SHEET	
	DRAWN - LKB	REVISED -				4006	95-0049-G0-PV	KANE	138	68
	CHECKED - RWL	REVISED -				CONTRACT NO. 63745				
	DATE - 06/20/12	FILE - 110994-WM-PP11.sh1				FED. ROAD DIST. NO. 1   ILLINOIS FED. AID PROJECT W-8003 (095)				

SCALE: H: 1"=20' V: 1"=5'

STA. 161+00 TO STA. 166+00

PROJECT: 95-0049-G0-PV, MAPLE AVENUE WATER MAIN AND SANITARY SEWER  
 DRAWN BY: LKB  
 CHECKED BY: RWL  
 DATE: 06/20/12  
 FILE: 110994-WM-PP11.sh1